

*** 2571 V Series ***

Material :

* Insulator : Nylon 6/6, UL 94V-2 Color : Nature

* Contact : Brass

* Plating :Tin plated 120μ ” min over 30μ ” min. nickel overall

Ordering Information:

2571 P ** V 00 0
1

RoHS COMPLIANT

1. Base color option:

0 = Nature(standard)

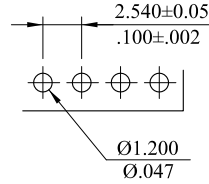
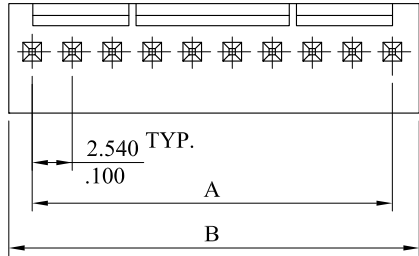

Recommended Hole Pattern

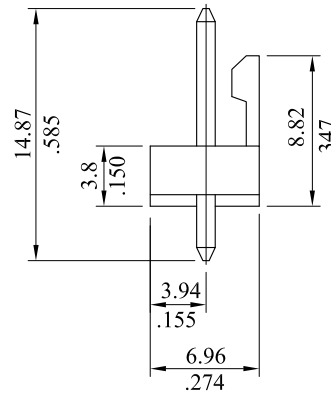
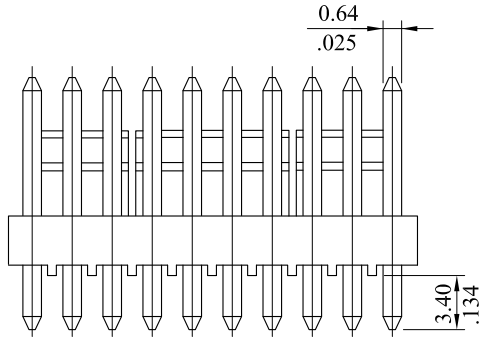

Circuits	Dimension		Circuits	Dimension	
	A	B		A	B
2571P02V000	2.540(.100)	5.08(.200)	2571P11V000	25.400(1.000)	27.94(1.10)
2571P03V000	5.080(.200)	7.62(.300)	2571P12V000	27.940(1.100)	30.48(1.20)
2571P04V000	7.620(.300)	10.16(.400)	2571P13V000	30.480(1.200)	33.02(1.30)
2571P05V000	10.160(.400)	12.7(.500)	2571P14V000	33.020(1.300)	35.56(1.40)
2571P06V000	12.700(.500)	15.24(.600)	2571P15V000	35.560(1.400)	38.10(1.50)
2571P07V000	15.240(.600)	17.78(.700)	2571P16V000	38.100(1.500)	40.64(1.60)
2571P08V000	17.780(.700)	20.32(.800)	2571P17V000	40.640(1.600)	43.18(1.70)
2571P09V000	20.320(.800)	22.86(.900)	2571P18V000	43.180(1.700)	45.72(1.80)
2571P10V000	22.860(.900)	25.40(1.00)	2571P19V000	45.720(1.800)	48.26(1.90)
			2591P20V000	48.260(1.900)	50.8(2.00)

F	ES101238			<p>LEOCO CORPORATION</p> <p>GENERAL TOLERANCES: (UNLESS SPECIFIED)</p> <table border="1"> <thead> <tr> <th></th> <th>mm</th> <th>inch</th> </tr> </thead> <tbody> <tr> <td>1 PLACE</td> <td>± 0.30</td> <td>± --</td> </tr> <tr> <td>2 PLACES</td> <td>± 0.20</td> <td>± .012</td> </tr> <tr> <td>3 PLACES</td> <td>± 0.10</td> <td>± .008</td> </tr> <tr> <td>4 PLACES</td> <td>± --</td> <td>± .004</td> </tr> </tbody> </table> <p>ANGULAR ± (1°)</p>		mm	inch	1 PLACE	± 0.30	± --	2 PLACES	± 0.20	± .012	3 PLACES	± 0.10	± .008	4 PLACES	± --	± .004	APPROVED:	PART NO.:			
	mm	inch																						
1 PLACE	± 0.30	± --																						
2 PLACES	± 0.20	± .012																						
3 PLACES	± 0.10	± .008																						
4 PLACES	± --	± .004																						
E	ES071009			DATE:	2571P**V00*																			
D	ES050313			CHECKED:	TITLE:																			
C	E960686			DATE:	2.54mm (.100") Straight Header																			
A	DWG REL			DRAWN:	DRAWING NO.:																			
REV.	ECO. NO.	CHG.	APP.	DATE:	257111S																			
					UNITS	SCALE	SIZE	SHEET	REV.															
					mm inch	2:1	A4	1/1	F															