

# SMT Power Inductors & Transformers

## Special Features

- Multiple applications: parallel, series, dualdiff. mode inductor & 1:1 ratio transformer
- Toroid core design for low radiation
- Low core loss
- High frequency response when used as transformer
- Coil encapsulated from harsh environments
- Dielectric strength 500VRMS
- Operating temperature -55 to +125°C
- Parallel & series connection are made externally
- Tape and reel packaged

## Notes

- \* Current to cause 35°C max. temperature rise

PM3600 Series								
Part Number	Parallel				Series			
	L (uH) ±20%	I* (A)	L (uH) ±20% @rated I	DCR (Ω) Max.	L (uH) ±20%	I* (A)	L (uH) ±20% @rated I	DCR (Ω) Max.
PM3602-5	5	2.41	3.8	0.023	20	1.20	15.2	0.092
PM3602-8	8	1.90	6.1	0.037	32	0.95	23.2	0.15
PM3602-10	10	1.83	7.4	0.040	40	0.92	29.6	0.16
PM3602-15	15	1.45	11.1	0.063	60	0.73	44.4	0.25
PM3602-20	20	1.25	15.2	0.086	80	0.63	60.8	0.34
PM3602-25	25	1.17	18.5	0.098	100	0.59	74.0	0.39
PM3602-33	33	0.98	24.8	0.14	132	0.49	99.2	0.56
PM3602-50	50	0.78	37.5	0.22	200	0.38	150.0	0.88
PM3602-68	68	0.72	49.6	0.26	272	0.36	198.4	1.04
PM3602-100	100	0.58	74.0	0.40	400	0.29	296	1.60
PM3602-150	150	0.47	111	0.60	600	0.24	444	2.40
PM3602-200	200	0.40	150	0.84	800	0.20	600	3.36
PM3602-250	250	0.33	192.5	1.19	1000	0.17	770	4.76
PM3602-300	300	0.32	225	1.31	1200	0.16	900	5.24
PM3604-5	5	3.30	3.8	0.019	20	1.65	15.2	0.076
PM3604-8	8	3.00	5.8	0.024	32	1.50	23.2	0.096
PM3604-10	10	2.70	7.3	0.028	40	1.35	29.2	0.11
PM3604-15	15	2.20	11.0	0.041	60	1.10	44.0	0.16
PM3604-20	20	2.02	14.2	0.049	80	1.01	56.8	0.20
PM3604-25	25	1.91	17.0	0.054	100	0.96	68.0	0.22
PM3604-33	33	1.60	23.1	0.078	132	0.80	92.4	0.31
PM3604-50	50	1.28	35.5	0.12	200	0.64	142	0.48
PM3604-68	68	1.19	46.2	0.14	272	0.60	184.8	0.56
PM3604-100	100	0.98	68.0	0.21	400	0.49	272	0.84
PM3604-150	150	0.78	103.5	0.32	600	0.39	414	1.28
PM3604-200	200	0.65	140	0.47	800	0.33	560	1.88
PM3604-250	250	0.60	172.5	0.53	1000	0.30	690	2.12
PM3604-300	300	0.52	213	0.73	1200	0.26	852	2.92

Also available as RoHS compliant.

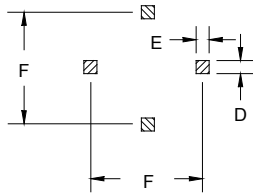
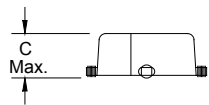
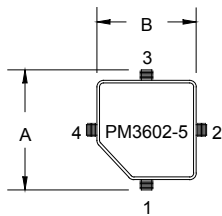

Pad Layout

Dimensions: Inches

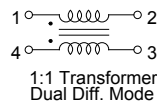
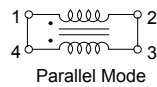
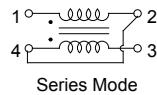

Series Number	A	B	C	D	E	F	Reel Size
PM3602	0.452	0.354	0.225	0.10	0.10	0.385	700
PM3604	0.550	0.452	0.265	0.16	0.10	0.500	400