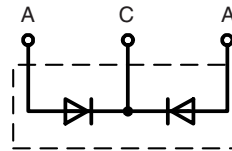
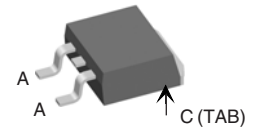

# HiPerFRED™ Epitaxial Diode

## with common cathode and soft recovery

$I_{FAV} = 2 \times 10 \text{ A}$   
 $V_{RRM} = 1200 \text{ V}$   
 $t_{rr} = 40 \text{ ns}$

$V_{RSM}$	$V_{RRM}$	Type
V	V	
1200	1200	DSEC 16-12AS

**TO-263 AB**

A = Anode, C/TAB = Cathode

Symbol	Conditions	Maximum Ratings	
$I_{FRMS}$	$T_C = 115^\circ\text{C}$ ; rectangular, $d = 0.5$	14	A
$I_{FAVM}$		10	A
$I_{FSM}$	$T_{VJ} = 45^\circ\text{C}$ ; $t_p = 10 \text{ ms}$ (50 Hz), sine	40	A
$E_{AS}$	$T_{VJ} = 25^\circ\text{C}$ ; non-repetitive $I_{AS} = 8 \text{ A}$ ; $L = 180 \mu\text{H}$	6.9	mJ
$I_{AR}$	$V_A = 1.25 \cdot V_R$ typ.; $f = 10 \text{ kHz}$ ; repetitive	0.8	A
$T_{VJ}$		-55...+175	$^\circ\text{C}$
$T_{VJM}$		175	$^\circ\text{C}$
$T_{stg}$		-55...+150	$^\circ\text{C}$
$P_{tot}$	$T_C = 25^\circ\text{C}$	60	W
$F_C$	mounting force	20...60	N
Weight	typical	2	g

### Features

- International standard package
- Planar passivated chips
- Very short recovery time
- Extremely low switching losses
- Low  $I_{FM}$ -values
- Soft recovery behaviour
- Epoxy meets UL 94V-0

### Applications

- Antiparallel diode for high frequency switching devices
- Antisaturation diode
- Snubber diode
- Free wheeling diode in converters and motor control circuits
- Rectifiers in switch mode power supplies (SMPS)
- Inductive heating
- Uninterruptible power supplies (UPS)
- Ultrasonic cleaners and welders

### Advantages

- Avalanche voltage rated for reliable operation
- Soft reverse recovery for low EMI/RFI
- Low  $I_{FM}$  reduces:
  - Power dissipation within the diode
  - Turn-on loss in the commutating switch

Dimensions see Outlines.pdf

Symbol	Conditions	Characteristic Values	
		typ.	max.
$I_R$ *	$T_{VJ} = 25^\circ\text{C}$ $V_R = V_{RRM}$		60 $\mu\text{A}$
	$T_{VJ} = 150^\circ\text{C}$ $V_R = V_{RRM}$		0.25 mA
$V_F$ *	$I_F = 10 \text{ A}$ ; $T_{VJ} = 150^\circ\text{C}$ $T_{VJ} = 25^\circ\text{C}$		1.96 V
			2.94 V
$R_{thJC}$			2.5 K/W
$R_{thCH}$		0.5	K/W
$t_{rr}$	$I_F = 1 \text{ A}$ ; $-di/dt = 50 \text{ A}/\mu\text{s}$ ; $V_R = 30 \text{ V}$ ; $T_{VJ} = 25^\circ\text{C}$	40	ns
$I_{RM}$	$V_R = 100 \text{ V}$ ; $I_F = 12 \text{ A}$ ; $-di_F/dt = 100 \text{ A}/\mu\text{s}$ $T_{VJ} = 100^\circ\text{C}$		8.5 A

Pulse test: \* Pulse Width = 5 ms, Duty Cycle < 2.0%  
\* Pulse Width = 300  $\mu\text{s}$ , Duty Cycle < 2.0%

Data according to IEC 60747 and per diode unless otherwise specified

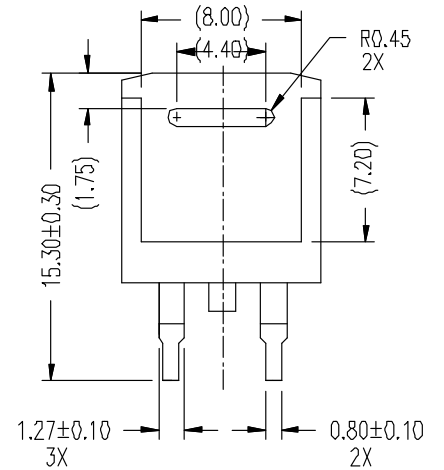
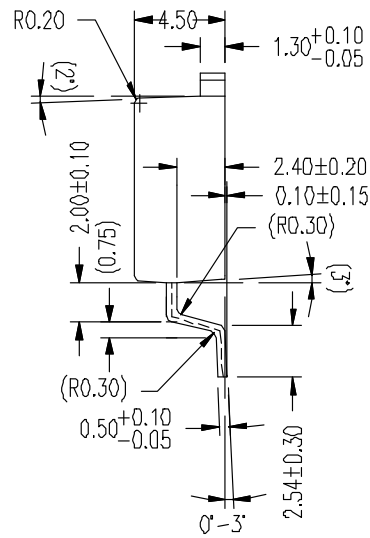
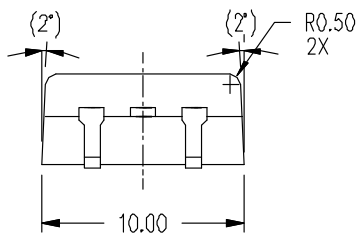
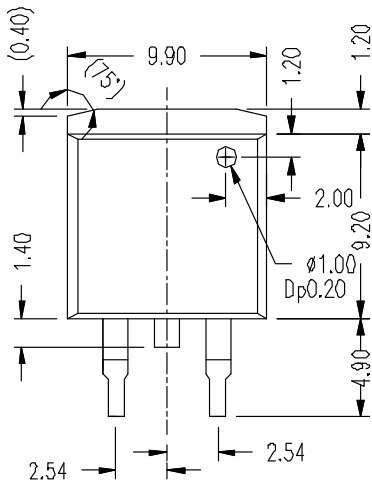
**NOTE:**

1. These dimensions do not include mold protrusion.
2. ( ) is reference dimension only.

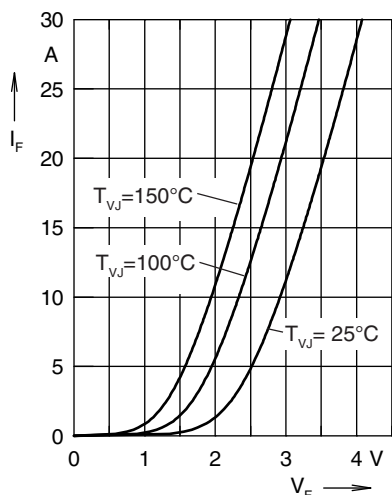

Fig. 1 Forward current  $I_F$  versus  $V_F$

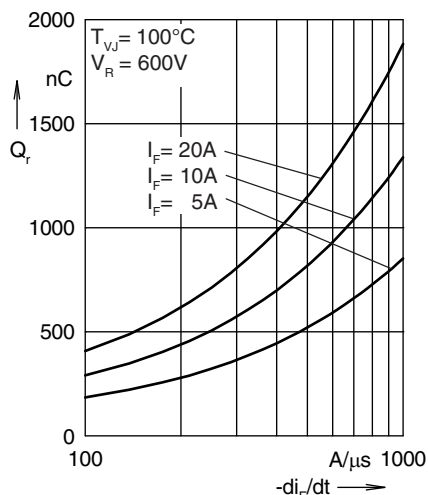

Fig. 2 Reverse recovery charge  $Q_r$  versus  $-di_F/dt$

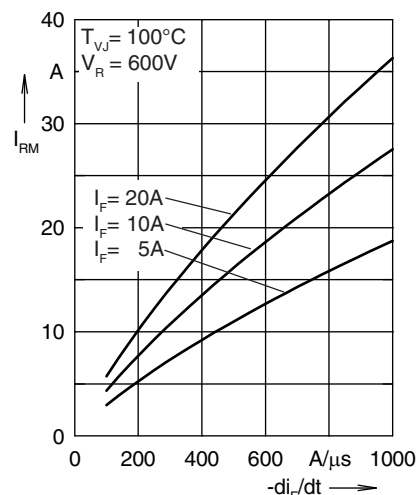

Fig. 3 Peak reverse current  $I_{RM}$  versus  $-di_F/dt$

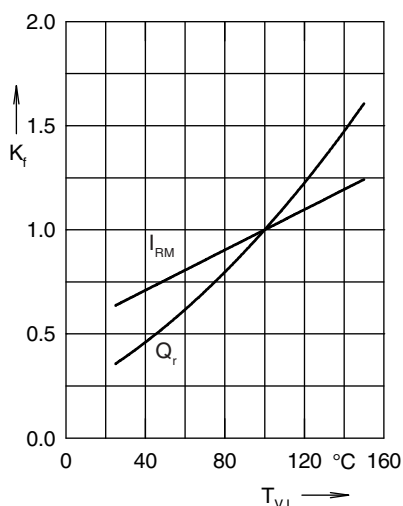

Fig. 4 Dynamic parameters  $Q_r$ ,  $I_{RM}$  versus  $T_{VJ}$

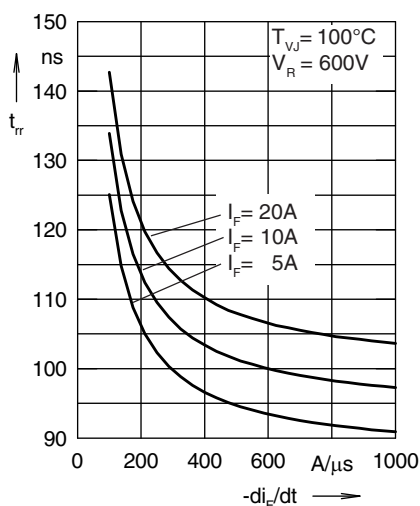

Fig. 5 Recovery time  $t_{rr}$  versus  $-di_F/dt$

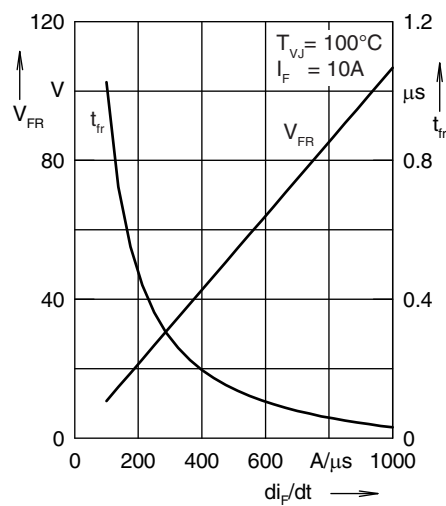

Fig. 6 Peak forward voltage  $V_{FR}$  and  $t_{fr}$  versus  $di_F/dt$

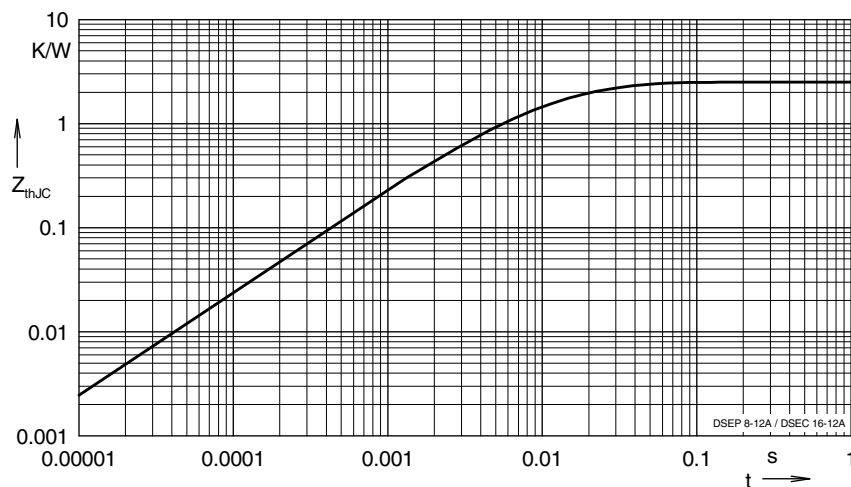

Fig. 7 Transient thermal resistance junction to case

Constants for  $Z_{thJC}$  calculation:

i	$R_{thi}$ (K/W)	$t_i$ (s)
1	1.449	0.0052
2	0.558	0.0003
3	0.493	0.017