

PLEASE CHECK WWW.MOLEX.COM FOR LATEST PART INFORMATION

Part Number: [0011110067](#)
Status: **Active**
Overview: [Application Tooling](#)
Description: [Insulation Anvil](#)

Documents:

[RoHS Certificate of Compliance \(PDF\)](#)

General

Product Family	Application Tooling
Series	207126
Comments	See Tooling Specification (PDF) Above
Function	Cutter
Geographic Area	Global
Level of Automation	Manual
More Detailed Tech Information	applicationtooling@molex.com
Overview	Application Tooling
Product Name	N/A
Tool Type	Applicator
UPC	800753878372
Warranty Disclaimer	CAUTION: Molex tooling crimp specifications are valid only when used with Molex terminals and tooling manufactured by Molex and sold by Molex or authorized distributors ("Molex Tooling"). When using tooling other than Molex Tooling with Molex specific connector systems listed in our ATS documents, the Molex tooling qualification does not apply and the responsibility for full qualification of the connector system is that of the customer. Molex accepts no liability for connector performance or tooling support where tooling other than Molex Tooling is used or where Molex Tooling is modified.

Material Info

Engineering Number 4971 22

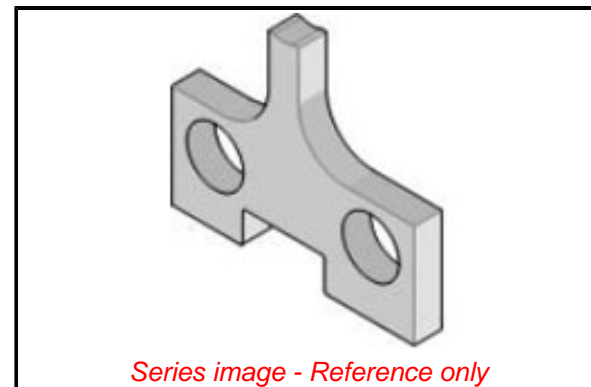

EU ELV

Not Relevant

EU RoHS

Not Reviewed

REACH SVHC

Not Reviewed

Halogen-Free

Status

Not Relevant

For more information, please visit [Contact US](#)

China ROHS

Not Relevant

ELV

Not Relevant

RoHS Phthalates

Not Reviewed

Search Parts in this Series

[207126 Series](#)

Use With

[11010085](#)

Application Tooling | [FAQ](#)

Description | **Product #**

Claspcn Crimp Terminal Socket, Tin [2085101](#)

(Sn) Plated Brass Contact, 16-24 AWG, Reel

2.36mm Diameter, Standard .093" Pin [2091155](#)

and Socket Crimp Terminal, Series 41483, Female, with Tin (Sn) Plated Brass Contact, 14-18 AWG with Large Insulation Diameter, Chain

2.36mm Diameter, Standard .093" Pin [2092171](#)

and Socket Crimp Terminal, Series 1190, Male, with Tin

(Sn) Plated Brass
Contact, 14-18 AWG,
Large Insulation
Crimp, Bag
2.36mm Diameter, 2095101
Standard .093" Pin
and Socket Crimp
Terminal, Series
1190, Male, with Tin
(Sn) Plated Brass
Contact, 14-20 AWG,
Chain
2.36mm Diameter, 2096102
Standard .093" Pin
and Socket Crimp
Terminal, Series
1189, Female, with
Tin (Sn) Plated Brass
Contact, 14-20 AWG,
Reel
Mini-Fit Jr. 3044052
Receptacle Housing,
Single Row, 5
Circuits, UL 94V-2,
Natural
1.57mm Diameter 3061011
Standard .062"
Pin and Socket
Receptacle Housing,
1 Circuits, Natural
1.57mm Diameter 3061022
Standard .062"
Pin and Socket
Receptacle Housing,
2 Circuits, with Pre-
bent Mounting Ears,
Natural
1.57mm Diameter 3061023
Standard .062"
Pin and Socket
Receptacle Housing,
2 Circuits, without
Mounting Ears,
Natural
1.57mm Diameter 3061031
Standard .062"
Pin and Socket
Receptacle Housing,
3 Circuits, with
Standard Mounting
Ears
1.57mm Diameter 3061032
Standard .062"
Pin and Socket
Receptacle Housing,
3 Circuits, without
Mounting Ears,
Natural
1.57mm Diameter 3061038
Standard .062"
Pin and Socket
Receptacle Housing,
3 Circuits, with Pre-
bent Mounting Ears,
Natural

1.57mm Diameter 3061041
Standard .062"
Pin and Socket
Receptacle Housing,
4 Circuits, with
Standard Mounting
Ears

1.57mm Diameter 3061042
Standard .062"
Pin and Socket
Receptacle Housing,
4 Circuits, without
Mounting Ears,
Natural

1.57mm Diameter 3061044
Standard .062"
Pin and Socket
Receptacle Housing,
Dual Row, without
Mounting Ears, PA
Polyamide Nylon 6/6,
UL 94V-2, 4 Circuits,
Natural

1.57mm Diameter 3061062
Standard .062"
Pin and Socket
Receptacle Housing,
6 Circuits, without
Mounting Ears,
Natural

1.57mm Diameter 3061092
Standard .062"
Pin and Socket
Receptacle Housing,
9 Circuits, without
Mounting Ears,
Natural

1.57mm Diameter 3061121
Standard .062"
Pin and Socket
Receptacle Housing,
12 Circuits, with
Standard Mounting
Ears, Natural

1.57mm Diameter 3061122
Standard .062"
Pin and Socket
Receptacle Housing,
12 Circuits, without
Mounting Ears,
Natural

1.57mm Diameter 3062011
Standard .062" Pin
and Socket Plug
Housing, 1 Circuits,
Natural

1.57mm Diameter 3062023
Standard .062" Pin
and Socket Plug
Housing, 2 Circuits,
without Mounting
Ears, Natural

1.57mm Diameter 3062024
Standard .062"
Pin and Socket

Plug Housing, 2 Circuits, with Pre- bent Mounting Ears, Natural 1.57mm Diameter Standard .062" Pin and Socket Plug Housing, 3 Circuits, with Standard Mounting Ears, Natural	<u>3062031</u>
1.57mm Diameter Standard .062" Pin and Socket Plug Housing, 3 Circuits, without Mounting Ears, Natural	<u>3062032</u>
1.57mm Diameter Standard .062" Pin and Socket Plug Housing, 3 Circuits, with Pre- bent Mounting Ears, Natural	<u>3062033</u>
1.57mm Diameter Standard .062" Pin and Socket Plug Housing, 4 Circuits, with Standard Mounting Ears	<u>3062041</u>
1.57mm Diameter Standard .062" Pin and Socket Plug Housing, 4 Circuits, without Mounting Ears, Natural	<u>3062042</u>
1.57mm Diameter Standard .062" Pin and Socket Plug Housing, Dual Row, without Mounting Ears, PA Polyamide Nylon 6/6, UL 94V-2, 4 Circuits, Natural	<u>3062044</u>
1.57mm Diameter Standard .062" Pin and Socket Plug Housing, 6 Circuits, without Mounting Ears, Natural	<u>3062061</u>
1.57mm Diameter Standard .062" Pin and Socket Plug Housing, 9 Circuits, without Mounting Ears, Natural	<u>3062092</u>
1.57mm Diameter Standard .062" Pin and Socket Plug Housing, 12 Circuits, with Pre- bent Mounting Ears, Natural	<u>3062121</u>
1.57mm Diameter Standard .062" Pin	<u>3062122</u>

and Socket Plug
Housing, 12 Circuits,
without Mounting
Ears, Natural
1.57mm Diameter 3066023
Standard .062"
Pin and Socket
Receptacle Housing,
2 Circuits, without
Mounting Ears, Black
1.57mm Diameter 3066062
Standard .062"
Pin and Socket
Receptacle Housing,
6 Circuits, without
Mounting Ears, Black
1.57mm Diameter 3067023
Standard .062" Pin
and Socket Plug
Housing, Black, 2
Circuits, without
Mounting Ears, Black
1.57mm Diameter 3067044
Standard .062" Pin
and Socket Plug
Housing, Dual Row,
without Mounting
Ears, PA Polyamide
Nylon 6/6, UL 94V-2,
4 Circuits, Black
1.57mm Diameter 3067061
Standard .062" Pin
and Socket Plug
Housing, 6 Circuits,
without Mounting
Ears, Black
2.36mm Diameter 3091011
Standard .093"
Pin and Socket
Receptacle Housing,
1 Circuit, Friction
Lock, Natural
2.36mm Diameter 3091022
Standard .093"
Pin and Socket
Receptacle Housing,
2 Circuits, without
Mounting Ears, with
Ramps, Natural
2.36mm Diameter 3091027
Standard .093"
Pin and Socket
Receptacle Housing,
2 Circuits, with Pre-
bent Mounting Ears,
with Ramps, Natural
2.36mm Diameter 3091031
Standard .093"
Pin and Socket
Receptacle Housing,
3 Circuits, Single
Row, Natural
2.36mm Diameter 3091032
Standard .093"
Pin and Socket

Receptacle Housing,
3 Circuits, Single
Row, Natural
2.36mm Diameter 3091033
Standard .093"
Pin and Socket
Receptacle Housing,
3 Circuits, Single
Row, Free-Hanging,
without Passive Lock
Ramps, Natural
2.36mm Diameter 3091041
Standard .093"
Pin and Socket
Receptacle Housing,
4 Circuits, Single
Row, Natural
2.36mm Diameter 3091042
Standard .093"
Pin and Socket
Receptacle Housing,
4 Circuits, Single
Row, Natural
2.36mm Diameter 3091049
Standard .093"
Pin and Socket
Receptacle Housing,
4 Circuits, Dual Row,
without Mounting
Ears, Natural
2.36mm Diameter 3091061
Standard .093"
Pin and Socket
Receptacle Housing,
6 Circuits, Dual Row,
Natural
2.36mm Diameter 3091062
Standard .093"
Pin and Socket
Receptacle Housing,
6 Circuits, Dual Row,
Natural
2.36mm Diameter 3091063
Standard .093"
Pin and Socket
Receptacle Housing,
6 Circuits, Dual Row,
without Panel Mount
Ears, without Friction
Lock Ramp
2.36mm Diameter 3091064
Standard .093"
Pin and Socket
Receptacle Housing,
6 Circuits, Dual Row,
Natural
2.36mm Diameter 3091081
Standard .093"
Pin and Socket
Receptacle Housing,
3 Circuits, Single
Row, Natural
2.36mm Diameter 3091091
Standard .093"
Pin and Socket

Receptacle
Housings, 9 Circuits,
3 Rows, Natural
2.36mm Diameter 3091092
Standard .093"
Pin and Socket

Receptacle
Housings, 9 Circuits,
3 Rows, with Panel
Mount Ears, without
Passive Lock Ramp
2.36mm Diameter 3091093
Standard .093"
Pin and Socket

Receptacle
Housings, 9 Circuits,
3 Rows, without
Panel Mount Ears,
without Passive Lock
Ramp
2.36mm Diameter 3091094
Standard .093"
Pin and Socket

Receptacle
Housings, 9 Circuits,
3 Rows, Natural
2.36mm Diameter 3091121
Standard .093"
Pin and Socket

Receptacle Housing,
12 Circuits, 3 Rows,
Panel Mountable,
without Passive
Locking Ramps
2.36mm Diameter 3091125
Standard .093"
Pin and Socket

Receptacle Housing,
12 Circuits, 3 Rows,
Natural
2.36mm Diameter 3091151
Standard .093"
Pin and Socket

Receptacle Housing,
15 Circuits, 3 Rows,
with Pre-Bent
Mounting Ears,
without Lock Ramps
2.36mm Diameter 3091152
Standard .093"
Pin and Socket

Receptacle Housing,
15 Circuits, 3 Rows,
without Mounting
Ears, without Lock
Ramps
2.36mm Diameter 3091153
Standard .093"
Pin and Socket

Receptacle Housing,
15 Circuits, 3 Rows,
with Pre-bent
Mounting Ears, with
Lock Ramps

2.36mm Diameter Standard .093" Pin and Socket Receptacle Housing, 15 Circuits, 3 Rows, without Mounting Ears, with Lock Ramps	<u>3091157</u>
2.36mm Diameter Standard .093" Pin and Socket Receptacle Housing without Mounting Ears, Positive Lock, 2 Circuits	<u>3091161</u>
2.36mm Diameter Standard .093" Pin and Socket Plug Housing, 1 Circuit, Friction Lock, Natural	<u>3092011</u>
2.36mm Diameter Standard .093" Pin and Socket Plug Housing, 2 Circuits, with Standard Mounting Ears, Natural	<u>3092021</u>
2.36mm Diameter Standard .093" Pin and Socket Plug Housing, 2 Circuits, without Mounting Ears, Natural	<u>3092022</u>
2.36mm Diameter Standard .093" Pin and Socket Plug Housing, 4 Circuits, Single Row	<u>3092041</u>
2.36mm Diameter Standard .093" Pin and Socket Plug Housing, 4 Circuits, Single Row	<u>3092042</u>
2.36mm Diameter Standard .093" Pin and Socket Plug Housing, 4 Circuits, Dual Row, without Mounting Ears, Natural	<u>3092049</u>
2.36mm Diameter Standard .093" Pin and Socket Plug Housing, 6 Circuits, Dual Row	<u>3092061</u>
2.36mm Diameter Standard .093" Pin and Socket Plug Housing, 6 Circuits, Dual Row	<u>3092062</u>
2.36mm Diameter Standard .093" Pin and Socket Plug Housings, 9 Circuits, 3 Rows	<u>3092092</u>

2.36mm Diameter Standard .093" Pin and Socket Plug Housing, 12 Circuits, 3 Rows	<u>3092121</u>
2.36mm Diameter Standard .093" Pin and Socket Plug Housing, 12 Circuits, 3 Rows	<u>3092122</u>
2.36mm Diameter Standard .093" Pin and Socket Plug Housing, 15 Circuits, 3 Rows, without Mounting Ears, with Pull Tabs, without Lock Windows	<u>3092151</u>
2.36mm Diameter Standard .093" Pin and Socket Plug Housing, 15 Circuits, 3 Rows, with Pre- Bent Mounting Ears, without Pull Tabs, with Lock Windows	<u>3092159</u>
2.36mm Diameter Standard .093" Pin and Socket Plug Housing without Mounting Ears, Positive Lock, 2 Circuits	<u>3092161</u>
2.36mm Diameter Standard .093" Pin and Socket Receptacle Housing, 2 Circuits, with Pre- bent Mounting Ears, with Ramps, Black	<u>3096021</u>
2.36mm Diameter Standard .093" Pin and Socket Plug Housing, 2 Circuits, without Mounting Ears, Black	<u>3097022</u>
2.36mm Diameter Standard .093" Pin and Socket Plug Housing, 2 Circuits, without Mounting Ears, Red	<u>3097024</u>
2.36mm Diameter Standard .093" Pin and Socket Plug Housing, 3 Circuits, Single Row, Black	<u>3097032</u>
3.18mm Diameter, HCS125, Pin and Socket Receptacle Housing, 2 Circuits, Single Row, with and without Panel Mount Ears	<u>3121022</u>

3.18mm Diameter, 3121036
HCS125, Pin and
Socket Receptacle
Housing, Single
Row, without Panel
Mount Ears, 3
Circuits, Natural,
Nylon 94V-2

3.18mm Diameter, 3121046
HCS125, Pin and
Socket Receptacle
Housing, Single
Row, 4 Circuits,
Natural (Translucent)

3.18mm Diameter, 3122022
HCS125, Pin
and Socket Plug
Housing, 2 Circuits,
Single Row, with and
without Panel Mount
Ears

3.18mm Diameter, 3122025
HCS125, Pin
and Socket Plug
Housing, Single
Row, with Panel
Mount Ears, 2
Circuits, Natural
(Translucent)

3.18mm Diameter, 3122026
HCS125, Pin
and Socket Plug
Housing, Single
Row, without Panel
Mount Ears, 2
Circuits, Natural
(Translucent)

3.18mm Diameter, 3122035
HCS125, Pin
and Socket Plug
Housing, Single
Row, with Panel
Mount Ears, 3
Circuits, Natural,
Nylon 94V-2

3.18mm Diameter, 3122036
HCS125, Pin
and Socket Plug
Housing, Single
Row, without Panel
Mount Ears, 3
Circuits, Natural,
Nylon 94V-2

3.18mm Diameter, 3122045
HCS125, Pin
and Socket Plug
Housing, Single
Row, with Panel
Mount Ears, 4
Circuits, Natural
(Translucent)

3.18mm Diameter, 3122046
HCS125, Pin
and Socket Plug
Housing, Single

Row, without Panel
Mount Ears, 4
Circuits, Natural
(Translucent)
Flat Blade Appliance 6021103
Motor Switch Crimp
Housing, 10 Circuits
Flat Blade Appliance 6022030
Water Valve Crimp
Housing, 3 Circuit,
Natural
Flat Blade Appliance 6023042
Defrost Timer Crimp
Housing, 4 Circuit, 4
Circuits
Flat Blade Appliance 6023103
Motor Switch Crimp
Housing, 10 Circuit,
10 Circuits
Flat Blade Appliance 6023104
Dryer Motor Crimp
Housing, 10 Circuit
KK 396 Crimp 8500023
Terminal 8818, 18-22
AWG, Bag, Brass Tin
(Sn)
KK Crimp Terminal, 8500110
Series 2477,
Humpback, with Tin
(Sn) Plated Brass
Contact, 18-24 AWG,
Loose
KK 156 TERMINAL 8500112
CRIMP 22-26 AWG
TIN
KK 396 Crimp 8520132
Terminal 8818,
18-22 AWG, Bag,
Phosphor Bronze Tin
(Sn)
KK Crimp Terminal, 8560114
Series 2477,
Humpback, with
Overall Gold (Au)
Plated Brass
Contact, 18-24 AWG,
Loose
KK 396 Crimp 8580136
Terminal 8818,
18-22 AWG, Bag,
Phosphor Bronze
Selective Gold (Au)
KK 396 Crimp 8650129
Terminal 8818,
18-22 AWG, Bag,
Phosphor Bronze
Selective Gold (Au)
2.5 Low Profile 8701047
Crimp Rec Chain W/
Pt
.156 IDT ASSEMBLY 9072031
724103L
KK 396 PC Board 9481024
Connector, Right
Angle, Polyester

Connector, 5.00µm
Tin (Sn), 2 Circuits
KK 396 PC Board 9481034
Connector, Right
Angle, Polyester
Connector, 5.00µm
Tin (Sn), 3 Circuits
KK 396 PC Board 9481044
Connector, Right
Angle, Polyester
Connector, 5.00µm
Tin (Sn), 4 Circuits
KK 396 PC Board 9481054
Connector, Right
Angle, Polyester
Connector, 5.00µm
Tin (Sn), 5 Circuits
KK 396 PC Board 9481064
Connector, Right
Angle, Polyester
Connector, 5.00µm
Tin (Sn), 6 Circuits
KK 396 PC Board 9481074
Connector, Right
Angle, Polyester
Connector, 5.00µm
Tin (Sn), 7 Circuits
KK 396 PC Board 9481084
Connector, Right
Angle, Polyester
Connector, 5.00µm
Tin (Sn), 8 Circuits
KK 396 PC Board 9481094
Connector, Right
Angle, Polyester
Connector, 5.00µm
Tin (Sn), 9 Circuits
KK 396 PC Board 9481104
Connector, Right
Angle, Polyester
Connector, 5.00µm
Tin (Sn), 10 Circuits
KK 396 PC Board 9481105
Connector, Top
Entry, Polyester
Connector, Gold (Au)
Selective, 10 Circuits
KK 396 PC Board 9481124
Connector, Right
Angle, Polyester
Connector, 5.00µm
Tin (Sn), 12 Circuits
KK 396 PC Board 9481134
Connector, Right
Angle, Polyester
Connector, 5.00µm
Tin (Sn), 13 Circuits
KK 396 PC Board 9481144
Connector, Right
Angle, Polyester
Connector, 5.00µm
Tin (Sn), 14 Circuits
KK 396 PC Board 9481154
Connector, Right
Angle, Polyester

Connector, 5.00µm
Tin (Sn), 15 Circuits
KK 396 PC Board 9483024
Connector, Bottom
Entry, Polyester
Connector, Gold (Au)
Selective, 2 Circuits
KK 396 PC Board 9483025
Connector, Right
Angle, Polyester
Connector, Gold (Au)
Selective, 2 Circuits
KK 396 PC Board 9483034
Connector, Bottom
Entry, Polyester
Connector, Gold (Au)
Selective, 3 Circuits
KK 396 PC Board 9483035
Connector, Right
Angle, Polyester
Connector, Gold (Au)
Selective, 3 Circuits
KK 396 PC Board 9483036
Connector, Top
Entry, Polyester
Connector, Gold (Au)
Selective, 3 Circuits
KK 396 PC Board 9483044
Connector, Bottom
Entry, Polyester
Connector, Gold (Au)
Selective, 4 Circuits
KK 396 PC Board 9483045
Connector, Right-
Angle, Polyester
Connector, Gold (Au)
Selective, 4 Circuits
KK 396 PC Board 9483046
Connector, Top
Entry, Polyester
Connector, Gold (Au)
Selective, 4 Circuits
KK 396 PC Board 9483054
Connector, Bottom
Entry, Polyester
Connector, Gold (Au)
Selective, 5 Circuits
KK 396 PC Board 9483055
Connector, Right-
Angle, Polyester
Connector, Gold (Au)
Selective, 5 Circuits
KK 396 PC Board 9483056
Connector, Top
Entry, Polyester
Connector, Gold (Au)
Selective, 5 Circuits
KK 396 PC Board 9483064
Connector, Bottom
Entry, Polyester
Connector, Gold (Au)
Selective, 6 Circuits
KK 396 PC Board 9483065
Connector, Right-
Angle, Polyester

Connector, Gold (Au)
Selective, 6 Circuits
KK 396 PC Board 9483066
Connector, Top
Entry, Polyester
Connector, Gold (Au)
Selective, 6 Circuits
KK 396 PC Board 9483074
Connector, Bottom
Entry, Polyester
Connector, Gold (Au)
Selective, 7 Circuits
KK 396 PC Board 9483075
Connector, Right-
Angle, Polyester
Connector, Gold (Au)
Selective, 7 Circuits
KK 396 PC Board 9483076
Connector, Top
Entry, Polyester
Connector, Gold (Au)
Selective, 7 Circuits
KK 396 PC Board 9483084
Connector, Bottom
Entry, Polyester
Connector, Gold (Au)
Selective, 8 Circuits
KK 396 PC Board 9483085
Connector, Right-
Angle, Polyester
Connector, Gold (Au)
Selective, 8 Circuits
KK 396 PC Board 9483086
Connector, Top
Entry, Polyester
Connector, Gold (Au)
Selective, 8 Circuits
KK 396 PC Board 9483094
Connector, Bottom
Entry, Polyester
Connector, Gold (Au)
Selective, 9 Circuits
KK 396 PC Board 9483095
Connector, Right-
Angle, Polyester
Connector, Gold (Au)
Selective, 9 Circuits
KK 396 PC Board 9483096
Connector, Top
Entry, Polyester
Connector, Gold (Au)
Selective, 9 Circuits
KK 396 PC Board 9483104
Connector, Bottom
Entry, Polyester
Connector, Gold (Au)
Selective, 10 Circuits
KK 396 PC Board 9483105
Connector, Right-
Angle, Polyester
Connector, Gold (Au)
Selective, 10 Circuits
KK 396 PC Board 9483106
Connector, Top
Entry, Polyester

Connector, Gold (Au)
Selective, 10 Circuits
KK 396 PC Board 9483124
Connector, Bottom
Entry, Polyester
Connector, Gold (Au)
Selective, 12 Circuits
KK 396 PC Board 9483125
Connector, Right-
Angle, Polyester
Connector, Gold (Au)
Selective, 12 Circuits
KK 396 PC Board 9483126
Connector, Top
Entry, Polyester
Connector, Gold (Au)
Selective, 12 Circuits
KK 396 PC Board 9483134
Connector, Bottom
Entry, Polyester
Connector, Gold (Au)
Selective, 13 Circuits
KK 396 PC Board 9483135
Connector, Right-
Angle, Polyester
Connector, Gold (Au)
Selective, 13 Circuits
KK 396 PC Board 9483136
Connector, Top
Entry, Polyester
Connector, Gold (Au)
Selective, 13 Circuits
KK 396 PC Board 9483144
Connector, Bottom
Entry, Polyester
Connector, Gold (Au)
Selective, 14 Circuits
KK 396 PC Board 9483145
Connector, Right-
Angle, Polyester
Connector, Gold (Au)
Selective, 14 Circuits
KK 396 PC Board 9483146
Connector, Top
Entry, Polyester
Connector, Gold (Au)
Selective, 14 Circuits
KK 396 PC Board 9483154
Connector, Bottom
Entry, Polyester
Connector, Gold (Au)
Selective, 15 Circuits
KK 396 PC Board 9483155
Connector, Right-
Angle, Polyester
Connector, Gold (Au)
Selective, 15 Circuits
KK 396 PC Board 9483156
Connector, Top
Entry, Polyester
Connector, Gold (Au)
Selective, 15 Circuits
KK 396 PC Board 9484028
Connector, Top
Entry, Polyester

Connector, 5.00µm Tin (Sn), 2 Circuits KK 396 PC Board	<u>9484029</u>
Connector, Bottom Entry, Polyester	
Connector, 5.00µm Tin (Sn), 2 Circuits KK 396 PC Board	<u>9484038</u>
Connector, Top Entry, Polyester	
Connector, 5.00µm Tin (Sn), 3 Circuits KK 396 PC Board	<u>9484039</u>
Connector, Bottom Entry, Polyester	
Connector, 5.00µm Tin (Sn), 3 Circuits KK 396 PC Board	<u>9484048</u>
Connector, Top Entry, Polyester	
Connector, 5.00µm Tin (Sn), 4 Circuits KK 396 PC Board	<u>9484049</u>
Connector, Bottom Entry, Polyester	
Connector, 5.00µm Tin (Sn), 4 Circuits KK 396 PC Board	<u>9484058</u>
Connector, Top Entry, Polyester	
Connector, 5.00µm Tin (Sn), 5 Circuits KK 396 PC Board	<u>9484059</u>
Connector, Bottom Entry, Polyester	
Connector, 5.00µm Tin (Sn), 5 Circuits KK 396 PC Board	<u>9484068</u>
Connector, Top Entry, Polyester	
Connector, 5.00µm Tin (Sn), 6 Circuits KK 396 PC Board	<u>9484069</u>
Connector, Bottom Entry, Polyester	
Connector, 5.00µm Tin (Sn), 6 Circuits KK 396 PC Board	<u>9484078</u>
Connector, Top Entry, Polyester	
Connector, 5.00µm Tin (Sn), 7 Circuits KK 396 PC Board	<u>9484079</u>
Connector, Bottom Entry, Polyester	
Connector, 5.00µm Tin (Sn), 7 Circuits KK 396 PC Board	<u>9484088</u>
Connector, Top Entry, Polyester	
Connector, 5.00µm Tin (Sn), 8 Circuits KK 396 PC Board	<u>9484089</u>
Connector, Bottom Entry, Polyester	

Connector, 5.00µm
Tin (Sn), 8 Circuits
KK 396 PC Board 9484098
Connector, Top
Entry, Polyester
Connector, 5.00µm
Tin (Sn), 9 Circuits
KK 396 PC Board 9484099
Connector, Bottom
Entry, Polyester
Connector, 5.00µm
Tin (Sn), 9 Circuits
KK 396 PC Board 9484108
Connector, Top
Entry, Polyester
Connector, 5.00µm
Tin (Sn), 10 Circuits
KK 396 PC Board 9484109
Connector, Bottom
Entry, Polyester
Connector, 5.00µm
Tin (Sn), 10 Circuits
KK 396 PC Board 9484128
Connector, Top
Entry, Polyester
Connector, 5.00µm
Tin (Sn), 12 Circuits
KK 396 PC Board 9484138
Connector, Top
Entry, Polyester
Connector, 5.00µm
Tin (Sn), 13 Circuits
KK 396 PC Board 9484139
Connector, Bottom
Entry, Polyester
Connector, 5.00µm
Tin (Sn), 13 Circuits
KK 396 PC Board 9484148
Connector, Top
Entry, Polyester
Connector, 5.00µm
Tin (Sn), 14 Circuits
KK 396 PC Board 9484149
Connector, Bottom
Entry, Polyester
Connector, 5.00µm
Tin (Sn), 14 Circuits
KK 396 PC Board 9484158
Connector, Top
Entry, Polyester
Connector, 5.00µm
Tin (Sn), 15 Circuits
KK 396 PC Board 9484159
Connector, Bottom
Entry, Polyester
Connector, 5.00µm
Tin (Sn), 15 Circuits
KK 156 PC Board 9485088
Connector, Top
Entry, Polyester
Connector, Tin (Sn),
8 Circuits
3.96mm Pitch SPOX 9501023
Crimp Housing,
Female, with Friction

Ramp and Void, 2
Circuits, Natural
3.96mm Pitch SPOX [9501031](#)
Crimp Housing,
Female, with Friction
Ramp, 3 Circuits,
Natural
3.96mm Pitch SPOX [9501033](#)
Crimp Housing,
Female, with Friction
Ramp and Void, 3
Circuits, Natural
3.96mm Pitch SPOX [9501043](#)
Crimp Housing,
Female, with Friction
Ramp and Void, 4
Circuits, Natural
3.96mm Pitch SPOX [9501051](#)
Crimp Housing,
Female, with Friction
Ramp, 5 Circuits,
Natural
3.96mm Pitch SPOX [9501053](#)
Crimp Housing,
Female, with Friction
Ramp and Void, 5
Circuits, Natural
3.96mm Pitch SPOX [9501061](#)
Crimp Housing,
Female, with Friction
Ramp, 6 Circuits,
Natural
3.96mm Pitch SPOX [9501063](#)
Crimp Housing,
Female, with Friction
Ramp and Void, 6
Circuits, Natural
3.96mm Pitch SPOX [9501071](#)
Crimp Housing,
Female, with Friction
Ramp, 7 Circuits,
Natural
3.96mm Pitch SPOX [9501073](#)
Crimp Housing,
Female, with Friction
Ramp and Void, 7
Circuits, Natural
3.96mm Pitch SPOX [9501081](#)
Crimp Housing,
Female, with Friction
Ramp, 8 Circuits,
Natural
3.96mm Pitch SPOX [9501083](#)
Crimp Housing,
Female, with Friction
Ramp and Void, 8
Circuits, Natural
3.96mm Pitch SPOX [9501091](#)
Crimp Housing,
Female, with Friction
Ramp, 9 Circuits,
Natural
3.96mm Pitch SPOX [9501101](#)
Crimp Housing,
Female, with Friction

Ramp, 10 Circuits,
Natural
3.96mm Pitch SPOX 9501103
Crimp Housing,
Female, with Friction
Ramp and Void, 10
Circuits, Natural
3.96mm Pitch SPOX 9501121
Crimp Housing,
Female, with Friction
Ramp, 12 Circuits,
Natural
KK 3.96mm Crimp 9503021
Terminal Housing,
Friction Ramp, 2
Circuits, Natural
KK 3.96mm Crimp 9503031
Terminal Housing,
Friction Ramp, 3
Circuits, Natural
KK 3.96mm Crimp 9503041
Terminal Housing,
Friction Ramp, 4
Circuits, Natural
KK 3.96mm Crimp 9503051
Terminal Housing,
Friction Ramp, 5
Circuits, Natural
KK 3.96mm Crimp 9503061
Terminal Housing,
Friction Ramp, 6
Circuits, Natural
KK 3.96mm Crimp 9503081
Terminal Housing,
Friction Ramp, 8
Circuits, Natural
KK 3.96mm Crimp 9503091
Terminal Housing,
Friction Ramp, 9
Circuits, Natural
KK 3.96mm Crimp 9503101
Terminal Housing,
Friction Ramp, 10
Circuits, Natural
KK 3.96mm Crimp 9503121
Terminal Housing,
Friction Ramp, 12
Circuits, Natural
KK 3.96mm Crimp 9503141
Terminal Housing,
Friction Ramp, 14
Circuits, Natural
KK 3.96mm Crimp 9503151
Terminal Housing,
Friction Ramp, 15
Circuits, Natural
KK 3.96mm Crimp 9503161
Terminal Housing,
Friction Ramp, 16
Circuits, Natural
KK 3.96mm Crimp 9503171
Terminal Housing,
Friction Ramp, 17
Circuits, Natural

KK 3.96mm Crimp Terminal Housing, Friction Ramp, 18 Circuits, Natural	<u>9503181</u>
KK 3.96mm Crimp Terminal Housing, Friction Ramp, 19 Circuits, Natural	<u>9503191</u>
KK 3.96mm Crimp Terminal Housing, Friction Ramp, 20 Circuits, Natural	<u>9503201</u>
KK 3.96mm Crimp Terminal Housing, Friction Ramp, 21 Circuits, Natural	<u>9503211</u>
KK 3.96mm Crimp Terminal Housing, Friction Ramp, 22 Circuits, Natural	<u>9503221</u>
KK 3.96mm Crimp Terminal Housing, Friction Ramp, 23 Circuits, Natural	<u>9503231</u>
KK 3.96mm Crimp Terminal Housing, Friction Ramp, 24 Circuits, Natural	<u>9503241</u>
KK 3.96mm Crimp Terminal Housing, 2 Circuits, Natural	<u>9507021</u>
KK 3.96mm Crimp Terminal Housing, 3 Circuits, Natural	<u>9507031</u>
KK 3.96mm Crimp Terminal Housing, 5 Circuits, Natural	<u>9507051</u>
KK 3.96mm Crimp Terminal Housing, 6 Circuits, Natural	<u>9507061</u>
KK 3.96mm Crimp Terminal Housing, 7 Circuits, Natural	<u>9507071</u>
KK 3.96mm Crimp Terminal Housing, 8 Circuits, Natural	<u>9507081</u>
KK 3.96mm Crimp Terminal Housing, 9 Circuits, Natural	<u>9507091</u>
KK 3.96mm Crimp Terminal Housing, 12 Circuits, Natural	<u>9507121</u>
KK 3.96mm Crimp Terminal Housing, 13 Circuits, Natural	<u>9507131</u>
KK 3.96mm Crimp Terminal Housing, 14 Circuits, Natural	<u>9507141</u>
KK 3.96mm Crimp Terminal Housing, 15 Circuits, Natural	<u>9507151</u>
KK 3.96mm Crimp Terminal Housing, 16 Circuits, Natural	<u>9507161</u>

KK 3.96mm Crimp 9507171
Terminal Housing, 17
Circuits, Natural
KK 3.96mm Crimp 9507181
Terminal Housing, 18
Circuits, Natural
KK 3.96mm Crimp 9507191
Terminal Housing, 19
Circuits, Natural
KK 3.96mm Crimp 9507201
Terminal Housing, 20
Circuits, Natural
KK 3.96mm Crimp 9507211
Terminal Housing, 21
Circuits, Natural
KK 3.96mm Crimp 9507221
Terminal Housing, 22
Circuits, Natural
KK 3.96mm Crimp 9507241
Terminal Housing, 24
Circuits, Natural
KK 3.96mm Crimp 9508020
Terminal Housing, 2
Circuits, Natural
KK 3.96mm Crimp 9508023
Terminal Housing,
Friction Ramp, 2
Circuits, Natural
KK 3.96mm Crimp 9508030
Terminal Housing, 3
Circuits, Natural
KK 3.96mm Crimp 9508031
Terminal Housing,
Friction Ramp, 3
Circuits, Natural
KK 3.96mm Crimp 9508033
Terminal Housing,
Friction Ramp, 3
Circuits, Natural
KK 3.96mm Crimp 9508040
Terminal Housing, 4
Circuits, Natural
KK 3.96mm Crimp 9508043
Terminal Housing,
Friction Ramp, 4
Circuits, Natural
KK 3.96mm Crimp 9508050
Terminal Housing, 5
Circuits, Natural
KK 3.96mm Crimp 9508051
Terminal Housing,
Friction Ramp, 5
Circuits, Natural
KK 3.96mm Crimp 9508053
Terminal Housing,
Friction Ramp, 5
Circuits, Natural
KK 3.96mm Crimp 9508060
Terminal Housing, 6
Circuits, Natural
KK 3.96mm Crimp 9508061
Terminal Housing,
Friction Ramp, 6
Circuits, Natural

KK 3.96mm Crimp Terminal Housing, 7 Circuits, Natural	<u>9508070</u>
KK 3.96mm Crimp Terminal Housing, Friction Ramp, 7 Circuits, Natural	<u>9508071</u>
KK 3.96mm Crimp Terminal Housing, Friction Ramp, 7 Circuits, Natural	<u>9508073</u>
KK 3.96mm Crimp Terminal Housing, 8 Circuits, Natural	<u>9508080</u>
KK 3.96mm Crimp Terminal Housing, Friction Ramp, 8 Circuits, Natural	<u>9508081</u>
KK 3.96mm Crimp Terminal Housing, Friction Ramp, 8 Circuits, Natural	<u>9508083</u>
KK 3.96mm Crimp Terminal Housing, 9 Circuits, Natural	<u>9508090</u>
KK 3.96mm Crimp Terminal Housing, Friction Ramp, 9 Circuits, Natural	<u>9508091</u>
KK 3.96mm Crimp Terminal Housing, Friction Ramp, 9 Circuits, Natural	<u>9508093</u>
KK 3.96mm Crimp Terminal Housing, 10 Circuits, Natural	<u>9508100</u>
KK 3.96mm Crimp Terminal Housing, Friction Ramp, 10 Circuits, Natural	<u>9508101</u>
KK 3.96mm Crimp Terminal Housing, Friction Ramp, 10 Circuits, Natural	<u>9508103</u>
KK 3.96mm Crimp Terminal Housing, 12 Circuits, Natural	<u>9508120</u>
KK 3.96mm Crimp Terminal Housing, Friction Ramp, 12 Circuits, Natural	<u>9508121</u>
KK 3.96mm Crimp Terminal Housing, Friction Ramp, 13 Circuits, Natural	<u>9508131</u>
KK 3.96mm Crimp Terminal Housing, Friction Ramp, 13 Circuits, Natural	<u>9508133</u>
KK 3.96mm Crimp Terminal Housing, Friction Ramp, 14 Circuits, Natural	<u>9508141</u>
KK 3.96mm Crimp Terminal Housing,	<u>9508143</u>

Friction Ramp, 14 Circuits, Natural SPOX and KK 396 Wire-to-Board Header, Vertical, with Friction Lock, 2 Circuits	<u>9652028</u>
SPOX and KK 396 Wire-to-Board Header, Vertical, with Friction Lock, 3 Circuits	<u>9652038</u>
SPOX and KK 396 Wire-to-Board Header, Vertical, with Friction Lock, 4 Circuits	<u>9652048</u>
SPOX and KK 396 Wire-to-Board Header, Vertical, with Friction Lock, 5 Circuits	<u>9652058</u>
SPOX and KK 396 Wire-to-Board Header, Vertical, with Friction Lock, 6 Circuits	<u>9652068</u>
SPOX and KK 396 Wire-to-Board Header, Vertical, with Friction Lock, 7 Circuits	<u>9652078</u>
SPOX and KK 396 Wire-to-Board Header, Vertical, with Friction Lock, 8 Circuits	<u>9652088</u>
KK 3.96mm Crimp Terminal Housing, Friction Ramp, 2 Circuits, Glow-Wire Capable	<u>9930200</u>
KK 3.96mm Crimp Terminal Housing, Friction Ramp, 3 Circuits, Glow-Wire Capable	<u>9930300</u>
KK 3.96mm Crimp Terminal Housing, Friction Ramp, 4 Circuits, Glow-Wire Capable	<u>9930400</u>
KK 3.96mm Crimp Terminal Housing, Friction Ramp, 5 Circuits, Glow-Wire Capable	<u>9930500</u>
KK 3.96mm Crimp Terminal Housing, Friction Ramp, 6 Circuits, Glow-Wire Capable	<u>9930600</u>
KK 3.96mm Crimp Terminal Housing, Friction Ramp, 7	<u>9930700</u>

Circuits, Glow-Wire Capable	
KK 3.96mm Crimp Terminal Housing, Friction Ramp, 8	<u>9930800</u>
Circuits, Glow-Wire Capable	
KK 3.96mm Crimp Terminal Housing, Friction Ramp, 9	<u>9930900</u>
Circuits, Glow-Wire Capable	
KK 3.96mm Crimp Terminal Housing, Friction Ramp, 10	<u>9931000</u>
Circuits, Glow-Wire Capable	
KK 3.96mm Crimp Terminal Housing, Friction Ramp, 12	<u>9931200</u>
Circuits, Glow-Wire Capable	
KK 3.96mm Crimp Terminal Housing, Friction Ramp, 13	<u>9931300</u>
Circuits, Glow-Wire Capable	
KK 3.96mm Crimp Terminal Housing, Friction Ramp, 14	<u>9931400</u>
Circuits, Glow-Wire Capable	
KK 3.96mm Crimp Terminal Housing, Friction Ramp, 15	<u>9931500</u>
Circuits, Glow-Wire Capable	
5.08mm Pitch KK Crimp Terminal Housing, 2 Circuits, Natural	<u>10011024</u>
5.08mm Pitch KK Crimp Terminal Housing, 3 Circuits, Natural	<u>10011034</u>
5.08mm Pitch KK Crimp Terminal Housing, 4 Circuits, Natural	<u>10011044</u>
5.08mm Pitch KK Crimp Terminal Housing, 5 Circuits, Natural	<u>10011054</u>
5.08mm Pitch KK Crimp Terminal Housing, 6 Circuits, Natural	<u>10011064</u>
5.08mm Pitch KK Crimp Terminal Housing, 7 Circuits, Natural	<u>10011074</u>
5.08mm Pitch KK Crimp Terminal Housing, 8 Circuits, Natural	<u>10011084</u>

5.08mm Pitch KK Crimp Terminal Housing, 9 Circuits, Natural	<u>10011094</u>
5.08mm Pitch KK Crimp Terminal Housing, 10 Circuits, Natural	<u>10011104</u>
5.08mm Pitch KK Crimp Terminal Housing, 12 Circuits, Natural	<u>10011124</u>
5.08mm Pitch SPOX Crimp Terminal Housing, 2 Circuits, Natural	<u>10013026</u>
5.08mm Pitch SPOX Crimp Terminal Housing, 3 Circuits, Natural	<u>10013036</u>
5.08mm Pitch SPOX Crimp Terminal Housing, 5 Circuits, Natural	<u>10013056</u>
5.08mm Pitch SPOX Crimp Terminal Housing, 6 Circuits, Natural	<u>10013066</u>
5.08mm Pitch SPOX Crimp Terminal Housing, 7 Circuits, Natural	<u>10013076</u>
5.08mm Pitch SPOX Crimp Terminal Housing, 9 Circuits, Natural	<u>10013096</u>
KK PC Board Connector, Bottom Entry Mount Style B, 1.00µm Tin (Sn), 2 Circuits	<u>10021022</u>
KK PC Board Connector, Bottom Entry Mount Style B, 1.00µm Tin (Sn), 3 Circuits	<u>10021032</u>
KK PC Board Connector, Bottom Entry Mount Style B, 1.00µm Tin (Sn), 4 Circuits	<u>10021042</u>
KK PC Board Connector, Bottom Entry Mount Style B, 1.00µm Tin (Sn), 5 Circuits	<u>10021052</u>
KK PC Board Connector, Bottom Entry Mount Style B, 1.00µm Tin (Sn), 6 Circuits	<u>10021062</u>
KK PC Board Connector, Bottom Entry Mount Style B,	<u>10021072</u>

1.00µm Tin (Sn), 7
 Circuits
 KK PC Board 10021082
 Connector, Bottom
 Entry Mount Style B,
 1.00µm Tin (Sn), 8
 Circuits
 KK PC Board 10021092
 Connector, Bottom
 Entry Mount Style B,
 1.00µm Tin (Sn), 9
 Circuits
 KK PC Board 10021102
 Connector, Bottom
 Entry Mount Style B,
 1.00µm Tin (Sn), 10
 Circuits
 KK PC Board 10021122
 Connector, Bottom
 Entry Mount Style B,
 1.00µm Tin (Sn), 12
 Circuits
 5.08mm Pitch KK 10061045
 Header, Right
 Angle, Square Pin,
 4 Circuits, Tin (Sn)
 Plating
 KK Header, Right 10061055
 Angle, Square Pin,
 5 Circuits, Tin (Sn)
 Plating
 KK Header, Vertical, 10081021
 Round Pin, 2
 Circuits, Tin (Sn)
 Plating, Pin Length
 19.05mm
 KK Header, Vertical, 10081022
 Round Pin, 2
 Circuits, Tin (Sn)
 Plating, Pin Length
 23.80mm
 KK Header, Vertical, 10081029
 Round Pin, 2
 Circuits, Tin (Sn)
 Plating, Pin Length
 20.32mm
 KK Header, Vertical, 10081031
 Round Pin, 3
 Circuits, Tin (Sn)
 Plating, Pin Length
 19.05mm
 KK Header, Vertical, 10081039
 Round Pin, 3
 Circuits, Tin (Sn)
 Plating, Pin Length
 20.32mm
 KK Header, Vertical, 10081041
 Round Pin, 4
 Circuits, Tin (Sn)
 Plating, Pin Length
 19.05mm
 KK Header, Vertical, 10081049
 Round Pin, 4
 Circuits, Tin (Sn)

Plating, Pin Length
20.32mm
KK Header, Vertical, [10081051](#)
Round Pin, 5
Circuits, Tin (Sn)
Plating, Pin Length
19.05mm
KK Header, Vertical, [10081061](#)
Round Pin, 6
Circuits, Tin (Sn)
Plating, Pin Length
19.05mm
KK Header, Vertical, [10081069](#)
Round Pin, 6
Circuits, Tin (Sn)
Plating, Pin Length
20.32mm
KK Header, Vertical, [10081071](#)
Round Pin, 7
Circuits, Tin (Sn)
Plating, Pin Length
19.05mm
KK Header, Vertical, [10081081](#)
Round Pin, 8
Circuits, Tin (Sn)
Plating, Pin Length
19.05mm
KK Header, Vertical, [10081082](#)
Round Pin, 8
Circuits, Tin (Sn)
Plating, Pin Length
23.80mm
KK Header, Vertical, [10081089](#)
Round Pin, 8
Circuits, Tin (Sn)
Plating, Pin Length
20.32mm
KK Header, Vertical, [10081091](#)
Round Pin, 9
Circuits, Tin (Sn)
Plating, Pin Length
19.05mm
KK Header, Vertical, [10081101](#)
Round Pin, 10
Circuits, Tin (Sn)
Plating, Pin Length
19.05mm
KK Header, Vertical, [10081102](#)
Round Pin, 10
Circuits, Tin (Sn)
Plating, Pin Length
23.80mm
KK Header, Vertical, [10081121](#)
Round Pin, 12
Circuits, Tin (Sn)
Plating, Pin Length
19.05mm
KK Header, Vertical, [10085021](#)
with Polarizing
Backwall, 2 Circuits,
Tin (Sn) Plating
KK Header, Vertical, [10085031](#)
with Polarizing
Backwall, 3 Circuits,
Tin (Sn) Plating

KK Header, Vertical, 10085051
with Polarizing
Backwall, 5 Circuits,
Tin (Sn) Plating
KK Header, Vertical, 10085061
with Polarizing
Backwall, 6 Circuits,
Tin (Sn) Plating
KK Header, Vertical, 10085071
with Polarizing
Backwall, 7 Circuits,
Tin (Sn) Plating
KK Header, Vertical, 10085081
with Polarizing
Backwall, 8 Circuits,
Tin (Sn) Plating
KK Header, Vertical, 10085091
with Polarizing
Backwall, 9 Circuits,
Tin (Sn) Plating
KK Header, Vertical, 10085101
with Polarizing
Backwall, 10 Circuits,
Tin (Sn) Plating
KK Header, Vertical, 10085121
with Polarizing
Backwall, 12 Circuits,
Tin (Sn) Plating
KK PC Board 10101021
Connector, Right-
Angle Mount Style A,
1.00 μ m Tin (Sn), 2
Circuits
KK PC Board 10101023
Connector, Top
Entry Mount Style C,
1.00 μ m Tin (Sn), 2
Circuits
KK PC Board 10101031
Connector, Right-
Angle Mount Style A,
1.00 μ m Tin (Sn), 3
Circuits
KK PC Board 10101033
Connector, Top
Entry Mount Style C,
1.00 μ m Tin (Sn), 3
Circuits
KK PC Board 10101041
Connector, Right-
Angle Mount Style A,
1.00 μ m Tin (Sn), 4
Circuits
KK PC Board 10101043
Connector, Top
Entry Mount Style C,
1.00 μ m Tin (Sn), 4
Circuits
KK PC Board 10101051
Connector, Right-
Angle Mount Style A,
1.00 μ m Tin (Sn), 5
Circuits
KK PC Board 10101053
Connector, Top

Entry Mount Style C,
1.00µm Tin (Sn), 5
Circuits
KK PC Board 10101061
Connector, Right-
Angle Mount Style A,
1.00µm Tin (Sn), 6
Circuits
KK PC Board 10101063
Connector, Top
Entry Mount Style C,
1.00µm Tin (Sn), 6
Circuits
KK PC Board 10101071
Connector, Right-
Angle Mount Style A,
1.00µm Tin (Sn), 7
Circuits
KK PC Board 10101073
Connector, Top
Entry Mount Style C,
1.00µm Tin (Sn), 7
Circuits
KK PC Board 10101081
Connector, Right-
Angle Mount Style A,
1.00µm Tin (Sn), 8
Circuits
KK PC Board 10101083
Connector, Top
Entry Mount Style C,
1.00µm Tin (Sn), 8
Circuits
KK PC Board 10101091
Connector, Right-
Angle Mount Style A,
1.00µm Tin (Sn), 9
Circuits
KK PC Board 10101093
Connector, Top
Entry Mount Style C,
1.00µm Tin (Sn), 9
Circuits
KK PC Board 10101101
Connector, Right-
Angle Mount Style A,
1.00µm Tin (Sn), 10
Circuits
KK PC Board 10101103
Connector, Top
Entry Mount Style C,
1.00µm Tin (Sn), 10
Circuits
KK PC Board 10101121
Connector, Right-
Angle Mount Style A,
1.00µm Tin (Sn), 12
Circuits
KK PC Board 10101123
Connector, Top
Entry Mount Style C,
1.00µm Tin (Sn), 12
Circuits
2.36mm Diameter 10181031
Standard .093" Pin

and Socket Header,
Shrouded, 3 Circuits,
2 Male Terminals
2.36mm Diameter 10181032
Standard .093" Pin
and Socket Header,
Shrouded, 3 Circuits,
3 Male Terminals
2.36mm Diameter 10181033
Standard .093" Pin
and Socket Header,
Shrouded, 3 Circuits,
1 Female Terminal, 2
Male Terminals
2.36mm Diameter 10181034
Standard .093" Pin
and Socket Header,
Shrouded, 3 Circuits,
1 Female Terminal, 2
Male Terminals
2.36mm Diameter 10181035
Standard .093" Pin
and Socket Header,
Shrouded, 3 Circuits,
2 Male Terminals, 1
Female Terminal
2.36mm Diameter 10181036
Standard .093" Pin
and Socket Header,
Shrouded, 3 Circuits,
1 Female Terminal, 1
Male Terminal
2.36mm Diameter 10181037
Standard .093" Pin
and Socket Header,
Shrouded, 3 Circuits,
2 Female Terminals,
1 Male Terminal
2.36mm Diameter 10181041
Standard .093" Pin
and Socket Header,
Shrouded, 4 Circuits,
4 Male Terminals
2.36mm Diameter 10181042
Standard .093" Pin
and Socket Header,
Shrouded, 4 Circuits,
4 Female Terminals
2.36mm Diameter 10181043
Standard .093" Pin
and Socket Header,
Shrouded, 4 Circuits,
1 Female Terminal, 3
Male Terminals
2.36mm Diameter 10181044
Standard .093" Pin
and Socket Header,
Shrouded, 4 Circuits,
3 Female Terminals,
1 Male Terminals
2.36mm Diameter 10181045
Standard .093" Pin
and Socket Header,
Shrouded, 4 Circuits,

2 Male Terminals, 2
Female Terminals
2.36mm Diameter 10181046
Standard .093" Pin
and Socket Header,
Shrouded, 4 Circuits,
3 Male Terminals, 1
Female Terminal
2.36mm Diameter 10181047
Standard .093" Pin
and Socket Header,
Shrouded, 4 Circuits,
1 Female Terminal, 3
Male Terminals
2.36mm Diameter 10181048
Standard .093" Pin
and Socket Header,
Shrouded, 4 Circuits,
1 Female Terminal,
2 Male Terminals, 1
Female Terminal, 1
Male Terminal
2.36mm Diameter 10181049
Standard .093" Pin
and Socket Header,
Shrouded, 4 Circuits,
2 Female Terminals,
1 Male Terminal, 1
Female Terminal,
1 Male Terminal, 1
Female Terminal
2.36mm Diameter 10181050
Standard .093" Pin
and Socket Header,
Shrouded, 4 Circuits,
2 Female Terminals,
2 Male Terminals
2.36mm Diameter 10181091
Standard .093" Pin
and Socket Header,
3 Rows, Shrouded,
Unfilled Polyester,
UL 94V-0, 9 Circuits,
9 Female Terminals
2.36mm Diameter 10181120
Standard .093"
Pin and Socket
Header, Shrouded,
12 Circuits, 12 Male
Terminals
2.36mm Diameter 10181122
Standard .093"
Pin and Socket
Header, 3 Rows,
Shrouded, Unfilled
Polyester, UL 94V-0,
12 Circuits, 12
Female Terminals
2.36mm Diameter 10181150
Standard .093"
Pin and Socket
Header, Shrouded,
15 Circuits, 15 Male
Terminals

5.08mm Pitch SPOX [10221022](#)
Crimp Housing,
Female, with Friction
Ramp and Void, 2
Circuits

5.00/7.50mm Pitch [10311058](#)
SPOX Header,
Vertical, with Friction
Lock, 5 Circuits

5.00/7.50mm Pitch [10311068](#)
SPOX Header,
Vertical, with Friction
Lock, 6 Circuits

5.08mm Pitch SPOX [10321031](#)
Wire-to-Board
Header, Vertical,
with Friction Lock, 3
Circuits

5.08mm Pitch SPOX [10321061](#)
Wire-to-Board
Header, Vertical,
with Friction Lock, 6
Circuits

5.08mm Pitch SPOX [10321091](#)
Wire-to-Board
Header, Vertical,
with Friction Lock, 9
Circuits

5.00mm Pitch SPOX [10633034](#)
Crimp Housing,
Female, with Friction
Ramp and Void, 3
Circuits, Natural

5.00mm Pitch SPOX [10633044](#)
Crimp Housing,
Female, with Friction
Ramp and Void, 4
Circuits, Natural

5.00mm Pitch SPOX [10633054](#)
Crimp Housing,
Female, with Friction
Ramp and Void, 5
Circuits, Natural

5.00mm Pitch SPOX [10633064](#)
Crimp Housing,
Female, with Friction
Ramp and Void, 6
Circuits, Natural

7.92mm Pitch SPOX [10634037](#)
Header, Vertical,
with Friction Lock, 3
Circuits

7.92mm Pitch SPOX [10634047](#)
Header, Vertical,
with Friction Lock, 4
Circuits

6.35mm Pitch MLX [10844022](#)
Power Connector,
2.13mm Contact
Diameter, Vertical,
PA Polyamide
(Nylon) 6/6, Tin (Sn),
White, 2 Circuits

2.13mm Diameter [10844025](#)
MLX Power

Connector Header,
Vertical, 2 Circuits,
Polyester 94V-0,
0.76µm Gold (Au)
Selective Plating,
Brick Red
6.35mm Pitch MLX 10844036
Power Connector,
2.13mm Contact
Diameter, Vertical,
PA Polyamide
(Nylon) 6/6. Gold
(Au) Selective,
White, 3 Circuits
6.35mm Pitch MLX 10844037
Power Connector,
2.13mm Contact
Diameter, Vertical,
PCT Polyester, Gold
(Au) Selective, Brick
Red, 3 Circuits
6.35mm Pitch MLX 10844040
Power Connector
Header, Vertical,
4 Circuits, PA
Polyamide Nylon
6/6 94V-2, Tin (Sn)
Plating, White
2.13mm Diameter 10844045
MLX Power
Connector Header,
Vertical, 4 Circuits,
Polyester 94V-0,
0.76µm Gold (Au)
Selective Plating,
Brick Red
6.35mm Pitch MLX 10844060
Power Connector
Header, Vertical,
6 Circuits, PA
Polyamide Nylon
6/6 94V-2, Tin (Sn)
Plating, White
6.35mm Pitch MLX 10844062
Power Connector,
2.13mm Contact
Diameter, Vertical,
PA Polyamide
(Nylon) 6/6, Tin (Sn),
White, 6 Circuits
6.35mm Pitch MLX 10844090
Power Connector
Header, Vertical,
9 Circuits, PA
Polyamide Nylon
6/6 94V-2, Tin (Sn)
Plating, White
2.13mm Diameter 10844094
MLX Power
Connector Header,
Vertical, 9 Circuits,
PA Polyamide Nylon
6/6 94V-2, 0.76µm
Gold (Au) Selective
Plating, White

6.35mm Pitch MLX Power Connector Header, Vertical, 12 Circuits, PA Polyamide Nylon 6/6 94V-2, Tin (Sn) Plating, White	<u>10844120</u>
6.35mm Pitch MLX Power Connector, 2.13mm Contact Diameter, Vertical, PA Polyamide (Nylon) 6/6, Tin (Sn), White, 12 Circuits	<u>10844122</u>
2.13mm Diameter MLX Power Connector Header, Vertical, 12 Circuits, PA Polyamide Nylon 6/6 94V-2, 0.76µm Gold (Au) Selective Plating, White	<u>10844124</u>
2.13mm Diameter MLX Power Connector Header, Vertical, 12 Circuits, Polyester 94V-0, 0.76µm Gold (Au) Selective Plating, Brick Red	<u>10844125</u>
6.35mm Pitch MLX Power Connector Header, Vertical, 15 Circuits, PA Polyamide Nylon 6/6 94V-2, Tin (Sn) Plating, White	<u>10844150</u>
2.13mm Diameter MLX Power Connector Header, Vertical, 15 Circuits, Polyester 94V-0, 0.76µm Gold (Au) Selective Plating, Brick Red	<u>10844155</u>
6.35mm Pitch MLX Power Connector Header, Vertical, 2 Circuits, Polyester 94V-0, Tin (Sn) Plating, White	<u>10845020</u>
6.35mm Pitch MLX Power Connector, 2.13mm Contact Diameter, Vertical, Polyester 94V-0, White/Natural, 2 Circuits	<u>10845021</u>
2.13mm Diameter MLX Power Connector Header, Vertical, 2 Circuits, Polyester 94V-0, 0.76µm Gold (Au)	<u>10845022</u>

Selective Plating, White	
6.35mm Pitch MLX Power Connector Header, Vertical, 3 Circuits, Polyester 94V-0, Tin (Sn) Plating, White	<u>10845030</u>
6.35mm Pitch MLX Power Connector, 2.13mm Contact Diameter, Vertical, PCT Polyester, Tin (Sn), White, 3 Circuits	<u>10845031</u>
2.13mm Diameter MLX Power Connector Header, Vertical, 3 Circuits, Polyester 94V-0, 0.76µm Gold (Au) Selective Plating, White	<u>10845032</u>
6.35mm Pitch MLX Power Connector Header, Vertical, 4 Circuits, Polyester 94V-0, Tin (Sn) Plating, White	<u>10845040</u>
6.35mm Pitch MLX Power Connector, 2.13mm Contact Diameter, Vertical, PCT Polyester, Tin (Sn), White, 4 Circuits	<u>10845041</u>
2.13mm Diameter MLX Power Connector Header, Vertical, 4 Circuits, Polyester 94V-0, 0.76µm Gold (Au) Selective Plating, White	<u>10845042</u>
6.35mm Pitch MLX Power Connector Header, Vertical, 6 Circuits, Polyester 94V-0, Tin (Sn) Plating, White	<u>10845060</u>
6.35mm Pitch MLX Power Connector, 2.13mm Contact Diameter, Vertical, PCT Polyester, Tin (Sn), White, 6 Circuits	<u>10845061</u>
6.35mm Pitch MLX Power Connector Header, Vertical, 9 Circuits, Polyester 94V-0, Tin (Sn) Plating, White	<u>10845090</u>
6.35mm Pitch MLX Power Connector,	<u>10845091</u>

2.13mm Contact
Diameter, Vertical,
PCT Polyester,
Tin (Sn), White, 9
Circuits
6.35mm Pitch MLX [10845120](#)
Power Connector
Header, Vertical, 12
Circuits, Polyester
94V-0, Tin (Sn)
Plating, White
2.13mm Diameter [10845122](#)
MLX Power
Connector Header,
Vertical, 12 Circuits,
Polyester 94V-0,
0.76µm Gold (Au)
Selective Plating,
White
6.35mm Pitch MLX [10845150](#)
Power Connector
Header, Vertical, 15
Circuits, Polyester
94V-0, Tin (Sn)
Plating, White
6.35mm Pitch MLX [10845153](#)
Power Connector,
2.13mm Contact
Diameter, Vertical,
PCT Polyester,
Gold (Au) Selective,
White, 15 Circuits
2.54mm Pitch C-Grid [10879805](#)
Breakaway Header,
Dual Row, Vertical,
High Temperature,
80 Circuits, 0.76µm
Gold (Au) Selective
Plating, Tin(Sn) PC
Tail Plating, 2.72mm
PC Tail
2.54mm Pitch C-Grid [10883041](#)
Breakaway Header,
High Profile, Dual
Row, Right Angle,
4 Circuits, 6.10mm
Mating Pin Length,
Tin (Sn) Plating
2.54mm Pitch C-Grid [10883042](#)
Breakaway Header,
High Profile, Dual
Row, Right Angle,
4 Circuits, 8.13mm
Mating Pin Length,
Tin (Sn) Plating
2.54mm Pitch C-Grid [10883061](#)
Breakaway Header,
High Profile, Dual
Row, Right Angle,
6 Circuits, 6.10mm
Mating Pin Length,
Tin (Sn) Plating
2.54mm Pitch C-Grid [10883062](#)
Breakaway Header,
High Profile, Dual

Row, Right Angle,
6 Circuits, 8.13mm
Mating Pin Length,
Tin (Sn) Plating
2.54mm Pitch C-Grid [10883081](#)
Breakaway Header,
High Profile, Dual
Row, Right Angle,
8 Circuits, 6.10mm
Mating Pin Length,
Tin (Sn) Plating
2.54mm Pitch C-Grid [10883082](#)
Breakaway Header,
High Profile, Dual
Row, Right Angle,
8 Circuits, 8.13mm
Mating Pin Length,
Tin (Sn) Plating
2.54mm Pitch C-Grid [10883101](#)
Breakaway Header,
High Profile, Dual
Row, Right Angle,
10 Circuits, 6.10mm
Mating Pin Length,
Tin (Sn) Plating
2.54mm Pitch C-Grid [10883102](#)
Breakaway Header,
High Profile, Dual
Row, Right Angle,
10 Circuits, 8.13mm
Mating Pin Length,
Tin (Sn) Plating
2.54mm Pitch C-Grid [10883121](#)
Breakaway Header,
High Profile, Dual
Row, Right Angle,
12 Circuits, 6.10mm
Mating Pin Length,
Tin (Sn) Plating
2.54mm Pitch C-Grid [10883122](#)
Breakaway Header,
High Profile, Dual
Row, Right Angle,
12 Circuits, 8.13mm
Mating Pin Length,
Tin (Sn) Plating
2.54mm Pitch C-Grid [10883142](#)
Breakaway Header,
High Profile, Dual
Row, Right Angle,
14 Circuits, 8.13mm
Mating Pin Length,
Tin (Sn) Plating
2.54mm Pitch C-Grid [10883161](#)
Breakaway Header,
High Profile, Dual
Row, Right Angle,
16 Circuits, 6.10mm
Mating Pin Length,
Tin (Sn) Plating
2.54mm Pitch C-Grid [10883162](#)
Breakaway Header,
High Profile, Dual
Row, Right Angle,
16 Circuits, 8.13mm

Mating Pin Length,
Tin (Sn) Plating
2.54mm Pitch C-Grid [10883181](#)
Breakaway Header,
High Profile, Dual
Row, Right Angle,
18 Circuits, 6.10mm
Mating Pin Length,
Tin (Sn) Plating
2.54mm Pitch C-Grid [10883182](#)
Breakaway Header,
High Profile, Dual
Row, Right Angle,
18 Circuits, 8.13mm
Mating Pin Length,
Tin (Sn) Plating
2.54mm Pitch C-Grid [10883202](#)
Breakaway Header,
High Profile, Dual
Row, Right Angle,
20 Circuits, 8.13mm
Mating Pin Length,
Tin (Sn) Plating
2.54mm Pitch C-Grid [10883221](#)
Breakaway Header,
High Profile, Dual
Row, Right Angle,
22 Circuits, 6.10mm
Mating Pin Length,
Tin (Sn) Plating
2.54mm Pitch C-Grid [10883222](#)
Breakaway Header,
High Profile, Dual
Row, Right Angle,
22 Circuits, 8.13mm
Mating Pin Length,
Tin (Sn) Plating
2.54mm Pitch C-Grid [10883241](#)
Breakaway Header,
High Profile, Dual
Row, Right Angle,
24 Circuits, 6.10mm
Mating Pin Length,
Tin (Sn) Plating
2.54mm Pitch C-Grid [10883242](#)
Breakaway Header,
High Profile, Dual
Row, Right Angle,
24 Circuits, 8.13mm
Mating Pin Length,
Tin (Sn) Plating
2.54mm Pitch C-Grid [10883261](#)
Breakaway Header,
High Profile, Dual
Row, Right Angle,
26 Circuits, 6.10mm
Mating Pin Length,
Tin (Sn) Plating
2.54mm Pitch C-Grid [10883262](#)
Breakaway Header,
High Profile, Dual
Row, Right Angle,
26 Circuits, 8.13mm
Mating Pin Length,
Tin (Sn) Plating

2.54mm Pitch C-Grid [10883282](#)
Breakaway Header,
High Profile, Dual
Row, Right Angle,
28 Circuits, 8.13mm
Mating Pin Length,
Tin (Sn) Plating

2.54mm Pitch C-Grid [10883301](#)
Breakaway Header,
High Profile, Dual
Row, Right Angle,
30 Circuits, 6.10mm
Mating Pin Length,
Tin (Sn) Plating

2.54mm Pitch C-Grid [10883302](#)
Breakaway Header,
High Profile, Dual
Row, Right Angle,
30 Circuits, 8.13mm
Mating Pin Length,
Tin (Sn) Plating

2.54mm Pitch C-Grid [10894042](#)
Breakaway Header,
High Profile, Dual
Row, Right-Angle,
4 Circuits, 6.10mm
Mating Pin Length,
0.38 μ m Gold (Au)
Selective Plating

2.54mm Pitch C-Grid [10894043](#)
Breakaway Header,
High Profile, Dual
Row, Right-Angle,
4 Circuits, 8.13mm
Mating Pin Length,
0.38 μ m Gold (Au)
Selective Plating

2.54mm Pitch C-Grid [10894047](#)
Breakaway Header,
High Profile, Dual
Row, Right-Angle,
4 Circuits, 8.13mm
Mating Pin Length,
0.76 μ m Gold (Au)
Selective Plating

2.54mm Pitch C-Grid [10894062](#)
Breakaway Header,
High Profile, Dual
Row, Right-Angle,
6 Circuits, 6.10mm
Mating Pin Length,
0.38 μ m Gold (Au)
Selective Plating

2.54mm Pitch C-Grid [10894063](#)
Breakaway Header,
High Profile, Dual
Row, Right-Angle,
6 Circuits, 8.13mm
Mating Pin Length,
0.38 μ m Gold (Au)
Selective Plating

2.54mm Pitch C-Grid [10894082](#)
Breakaway Header,
High Profile, Dual
Row, Right-Angle,

8 Circuits, 6.10mm
Mating Pin Length,
0.38 μ m Gold (Au)
Selective Plating
2.54mm Pitch C-Grid [10894083](#)
Breakaway Header,
High Profile, Dual
Row, Right-Angle,
8 Circuits, 8.13mm
Mating Pin Length,
0.38 μ m Gold (Au)
Selective Plating
2.54mm Pitch C-Grid [10894086](#)
Breakaway Header,
High Profile, Dual
Row, Right-Angle,
8 Circuits, 6.10mm
Mating Pin Length,
0.76 μ m Gold (Au)
Selective Plating
2.54mm Pitch C-Grid [10894087](#)
Breakaway Header,
High Profile, Dual
Row, Right-Angle,
8 Circuits, 8.13mm
Mating Pin Length,
0.76 μ m Gold (Au)
Selective Plating
2.54mm Pitch C-Grid [10894102](#)
Breakaway Header,
High Profile, Dual
Row, Right-Angle,
10 Circuits, 6.10mm
Mating Pin Length,
0.38 μ m Gold (Au)
Selective Plating
2.54mm Pitch C-Grid [10894103](#)
Breakaway Header,
High Profile, Dual
Row, Right-Angle,
10 Circuits, 8.13mm
Mating Pin Length,
0.38 μ m Gold (Au)
Selective Plating
2.54mm Pitch C-Grid [10894107](#)
Breakaway Header,
High Profile, Dual
Row, Right-Angle,
10 Circuits, 8.13mm
Mating Pin Length,
0.76 μ m Gold (Au)
Selective Plating
2.54mm Pitch C-Grid [10894122](#)
Breakaway Header,
High Profile, Dual
Row, Right-Angle,
12 Circuits, 6.10mm
Mating Pin Length,
0.38 μ m Gold (Au)
Selective Plating
2.54mm Pitch C-Grid [10894123](#)
Breakaway Header,
High Profile, Dual
Row, Right-Angle,
12 Circuits, 8.13mm

Mating Pin Length,
0.38 μ m Gold (Au)
Selective Plating
2.54mm Pitch C-Grid [10894126](#)
Breakaway Header,
High Profile, Dual
Row, Right-Angle,
12 Circuits, 6.10mm
Mating Pin Length,
0.76 μ m Gold (Au)
Selective Plating
2.54mm Pitch C-Grid [10894127](#)
Breakaway Header,
High Profile, Dual
Row, Right-Angle,
12 Circuits, 8.13mm
Mating Pin Length,
0.76 μ m Gold (Au)
Selective Plating
2.54mm Pitch C-Grid [10894142](#)
Breakaway Header,
High Profile, Dual
Row, Right-Angle,
14 Circuits, 6.10mm
Mating Pin Length,
0.38 μ m Gold (Au)
Selective Plating
2.54mm Pitch C-Grid [10894143](#)
Breakaway Header,
High Profile, Dual
Row, Right-Angle,
14 Circuits, 8.13mm
Mating Pin Length,
0.38 μ m Gold (Au)
Selective Plating
2.54mm Pitch C-Grid [10894146](#)
Breakaway Header,
High Profile, Dual
Row, Right-Angle,
14 Circuits, 6.10mm
Mating Pin Length,
0.76 μ m Gold (Au)
Selective Plating
2.54mm Pitch C-Grid [10894147](#)
Breakaway Header,
High Profile, Dual
Row, Right-Angle,
14 Circuits, 8.13mm
Mating Pin Length,
0.76 μ m Gold (Au)
Selective Plating
2.54mm Pitch C-Grid [10894162](#)
Breakaway Header,
High Profile, Dual
Row, Right-Angle,
16 Circuits, 6.10mm
Mating Pin Length,
0.38 μ m Gold (Au)
Selective Plating
2.54mm Pitch C-Grid [10894163](#)
Breakaway Header,
High Profile, Dual
Row, Right-Angle,
16 Circuits, 8.13mm
Mating Pin Length,

0.38 μ m Gold (Au)
Selective Plating
2.54mm Pitch C-Grid [10894167](#)
Breakaway Header,
High Profile, Dual
Row, Right-Angle,
16 Circuits, 8.13mm
Mating Pin Length,
0.76 μ m Gold (Au)
Selective Plating
2.54mm Pitch C-Grid [10894182](#)
Breakaway Header,
High Profile, Dual
Row, Right-Angle,
18 Circuits, 6.10mm
Mating Pin Length,
0.38 μ m Gold (Au)
Selective Plating
2.54mm Pitch C-Grid [10894183](#)
Breakaway Header,
High Profile, Dual
Row, Right-Angle,
18 Circuits, 8.13mm
Mating Pin Length,
0.38 μ m Gold (Au)
Selective Plating
2.54mm Pitch C-Grid [10894186](#)
Breakaway Header,
High Profile, Dual
Row, Right-Angle,
18 Circuits, 6.10mm
Mating Pin Length,
0.76 μ m Gold (Au)
Selective Plating
2.54mm Pitch C-Grid [10894187](#)
Breakaway Header,
High Profile, Dual
Row, Right-Angle,
18 Circuits, 8.13mm
Mating Pin Length,
0.76 μ m Gold (Au)
Selective Plating
2.54mm Pitch C-Grid [10894202](#)
Breakaway Header,
High Profile, Dual
Row, Right-Angle,
20 Circuits, 6.10mm
Mating Pin Length,
0.38 μ m Gold (Au)
Selective Plating
2.54mm Pitch C-Grid [10894203](#)
Breakaway Header,
High Profile, Dual
Row, Right-Angle,
20 Circuits, 8.13mm
Mating Pin Length,
0.38 μ m Gold (Au)
Selective Plating
2.54mm Pitch C-Grid [10894206](#)
Breakaway Header,
High Profile, Dual
Row, Right-Angle,
20 Circuits, 6.10mm
Mating Pin Length,

0.76µm Gold (Au)
Selective Plating
2.54mm Pitch C-Grid [10894207](#)
Breakaway Header,
High Profile, Dual
Row, Right-Angle,
20 Circuits, 8.13mm
Mating Pin Length,
0.76µm Gold (Au)
Selective Plating
2.54mm Pitch C-Grid [10894222](#)
Breakaway Header,
High Profile, Dual
Row, Right-Angle,
22 Circuits, 6.10mm
Mating Pin Length,
0.38µm Gold (Au)
Selective Plating
2.54mm Pitch C-Grid [10894223](#)
Breakaway Header,
High Profile, Dual
Row, Right-Angle,
22 Circuits, 8.13mm
Mating Pin Length,
0.38µm Gold (Au)
Selective Plating
2.54mm Pitch C-Grid [10894227](#)
Breakaway Header,
High Profile, Dual
Row, Right-Angle,
22 Circuits, 8.13mm
Mating Pin Length,
0.76µm Gold (Au)
Selective Plating
2.54mm Pitch C-Grid [10894242](#)
Breakaway Header,
High Profile, Dual
Row, Right-Angle,
24 Circuits, 6.10mm
Mating Pin Length,
0.38µm Gold (Au)
Selective Plating
2.54mm Pitch C-Grid [10894246](#)
Breakaway Header,
High Profile, Dual
Row, Right-Angle,
24 Circuits, 6.10mm
Mating Pin Length,
0.76µm Gold (Au)
Selective Plating
2.54mm Pitch C-Grid [10894247](#)
Breakaway Header,
High Profile, Dual
Row, Right-Angle,
24 Circuits, 8.13mm
Mating Pin Length,
0.76µm Gold (Au)
Selective Plating
2.54mm Pitch C-Grid [10894262](#)
Breakaway Header,
High Profile, Dual
Row, Right-Angle,
26 Circuits, 6.10mm
Mating Pin Length,

0.38 μ m Gold (Au)
Selective Plating
2.54mm Pitch C-Grid [10894263](#)
Breakaway Header,
High Profile, Dual
Row, Right-Angle,
26 Circuits, 8.13mm
Mating Pin Length,
0.38 μ m Gold (Au)
Selective Plating
2.54mm Pitch C-Grid [10894266](#)
Breakaway Header,
High Profile, Dual
Row, Right-Angle,
26 Circuits, 6.10mm
Mating Pin Length,
0.76 μ m Gold (Au)
Selective Plating
2.54mm Pitch C-Grid [10894267](#)
Breakaway Header,
High Profile, Dual
Row, Right-Angle,
26 Circuits, 8.13mm
Mating Pin Length,
0.76 μ m Gold (Au)
Selective Plating
2.54mm Pitch C-Grid [10894282](#)
Breakaway Header,
High Profile, Dual
Row, Right-Angle,
28 Circuits, 6.10mm
Mating Pin Length,
0.38 μ m Gold (Au)
Selective Plating
2.54mm Pitch C-Grid [10894283](#)
Breakaway Header,
High Profile, Dual
Row, Right-Angle,
28 Circuits, 8.13mm
Mating Pin Length,
0.38 μ m Gold (Au)
Selective Plating
2.54mm Pitch C-Grid [10894286](#)
Breakaway Header,
High Profile, Dual
Row, Right-Angle,
28 Circuits, 6.10mm
Mating Pin Length,
0.76 μ m Gold (Au)
Selective Plating
2.54mm Pitch C-Grid [10894287](#)
Breakaway Header,
High Profile, Dual
Row, Right-Angle,
28 Circuits, 8.13mm
Mating Pin Length,
0.76 μ m Gold (Au)
Selective Plating
2.54mm Pitch C-Grid [10894303](#)
Breakaway Header,
High Profile, Dual
Row, Right-Angle,
30 Circuits, 8.13mm
Mating Pin Length,

This document was generated on 03/09/2020

PLEASE CHECK WWW.MOLEX.COM FOR LATEST PART INFORMATION