

Device connector, rear mounting - PRC 3-FT25-MC2,5-150 - 1409219

Please be informed that the data shown in this PDF Document is generated from our Online Catalog. Please find the complete data in the user's documentation. Our General Terms of Use for Downloads are valid (<http://phoenixcontact.com/download>)



PRC device connector, black, 3-pos., 690 V (IEC 61984), 24 A, crimp connection, 2.5 mm² with 150 mm cable length, cut smooth at the end

RoHS

Key Commercial Data

Packing unit	10 STK
GTIN	
GTIN	4046356867726

Technical data

General data

Number of positions	3
Protection class	II
Color	black
Locking type	Snap-in locking
Insertion/withdrawal cycles	100
Pull-out-force	150 N ± 50 N
Insertion force	30 N ± 10 N
Degree of protection (not plugged in)	IP65 (Lengthwise waterproofing)
Degree of protection (when plugged in)	IP66 / IP68 (2m / 24h) / IP69K

Connection data

Rated current	24 A (with a 2.5 mm ² conductor cross section)
Rated voltage (III/2)	690 V
Conductor cross section flexible max.	2.5 mm ²
Torque	2.5 Nm ± 0.1 Nm (Tightening torque nut)
Wrench size, union nut	32.00 mm
Type of contact	Pin

Material data

Device connector, rear mounting - PRC 3-FT25-MC2,5-150 - 1409219

Technical data

Material data

Contact material	Cu
Contact surface material	silver-plated
Contact carrier material	mPPE
Flammability rating according to UL 94	V0

Conductor data

Fixed cable length	150 mm
Single wire, material	PVC
Single wire, color	black, blue, green/yellow
Wire diameter incl. insulation	3.65 mm ±0.15 mm

Standards and Regulations

Standard designation	Shock, vibration
Standards/regulations	DIN EN 60068-2-6
	DIN EN 60068-2-27
	ETSI EN 300 019-1-4 V2.2.1 (2014-04)
Flammability rating according to UL 94	V0

Environmental Product Compliance

China RoHS	Environmentally Friendly Use Period = 50
	For details about hazardous substances go to tab "Downloads", Category "Manufacturer's declaration"

Drawings

Dimensional drawing

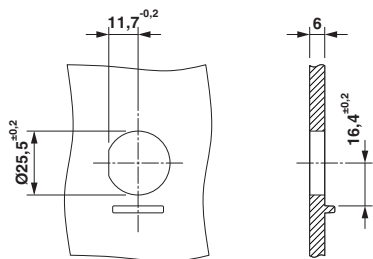

Housing cutout

Dimensional drawing

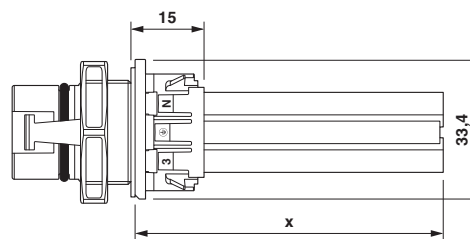

Dimensional drawing

Device connector, rear mounting - PRC 3-FT25-MC2,5-150 - 1409219

Dimensional drawing

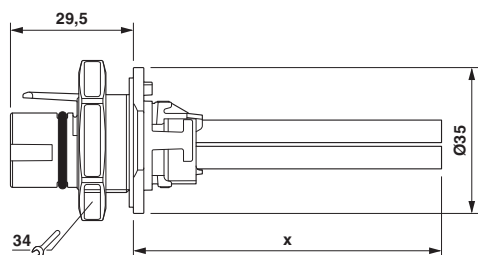

Schematic diagram

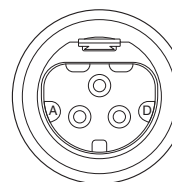

Connector pin assignment

Dimensional drawing

Approvals

Approvals

Approvals

EAC / UL Listed / cUL Listed / UL Listed / cUL Listed / TÜV Rheinland / TÜV Rheinland / cULus Listed

Ex Approvals

Approval details

EAC		B.00767
-----	--	---------

UL Listed		http://database.ul.com/cgi-bin/XYV/template/LISEXT/1FRAME/index.htm E221474-20150513
mm ² /AWG/kcmil	2.5	
Nominal current I _N	35 A	
Nominal voltage U _N	600 V	

cUL Listed		http://database.ul.com/cgi-bin/XYV/template/LISEXT/1FRAME/index.htm E221474-20150513
mm ² /AWG/kcmil	2.5	
Nominal current I _N	35 A	
Nominal voltage U _N	600 V	

Device connector, rear mounting - PRC 3-FT25-MC2,5-150 - 1409219

Approvals

UL Listed		http://database.ul.com/cgi-bin/XYV/template/LISEXT/1FRAME/index.htm E221474-20150513
mm ² /AWG/kcmil	14-10	
Nominal current IN	35 A	
Nominal voltage UN	600 V	

cUL Listed		http://database.ul.com/cgi-bin/XYV/template/LISEXT/1FRAME/index.htm E221474-20150513
mm ² /AWG/kcmil	14-10	
Nominal current IN	35 A	
Nominal voltage UN	600 V	

TÜV Rheinland	http://www.certipedia.com	R 60117904-0002
mm ² /AWG/kcmil	6	
Nominal current IN	35 A	
Nominal voltage UN	690 V	

TÜV Rheinland	http://www.certipedia.com	R 60117904-0001
mm ² /AWG/kcmil	6	
Nominal current IN	32 A	
Nominal voltage UN	500 V	

cULus Listed	
--------------	---

Phoenix Contact 2018 © - all rights reserved
<http://www.phoenixcontact.com>

PHOENIX CONTACT GmbH & Co. KG
 Flachsmarktstr. 8
 32825 Blomberg
 Germany
 Tel. +49 5235 300
 Fax +49 5235 3 41200
<http://www.phoenixcontact.com>