

**C-SCFI 1,5/6,3X0,8**

Order No.: 3240052

<http://eshop.phoenixcontact.de/phoenix/treeViewClick.do?UID=3240052>Slip-on sleeve, red, 0.5 - 1.5 mm<sup>2</sup>, 6.3 x 0.8**Commercial data**

GTIN (EAN)	
sales group	B281
Pack	100 pcs.
Customs tariff	85366990
Catalog page information	Page 321 (CL2-2011)

**Product notes**WEEE/RoHS-compliant since:  
09/23/2008

<http://www.download.phoenixcontact.com>  
Please note that the data given here has been taken from the online catalog. For comprehensive information and data, please refer to the user documentation. The General Terms and Conditions of Use apply to Internet downloads.

**Technical data****General**

Length (b)	21.5 mm
Width (a)	6.3 mm
Color	red
Ambient temperature (operation)	-20 °C ... 105 °C
Components	Halogen-free

Material	Brass
Length of insulation sleeve (c)	10.5 mm
Inner dimension of the insulating collar (d)	4.1 mm
Material thickness (g)	0.4 mm

**Diagrams/Drawings**

Dimensioned drawing

---

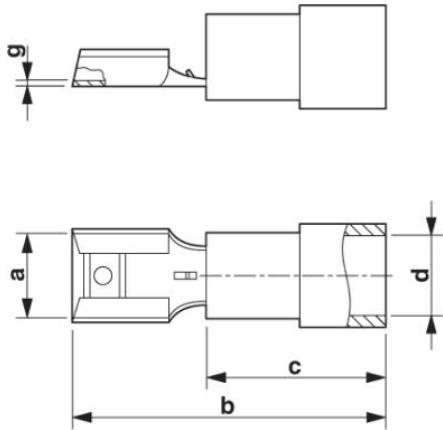

**Address**

PHOENIX CONTACT Inc., USA  
586 Fulling Mill Road  
Middletown, PA 17057, USA  
Phone (800) 888-7388  
Fax (717) 944-1625  
<http://www.phoenixcon.com>



© 2011 Phoenix Contact  
Technical modifications reserved;