

## 1375794-3 Product Details

[Share](#) [Print](#) [Email](#)

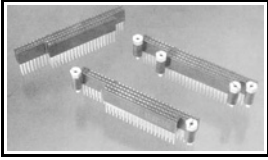

**1375794-3**

TE Internal Number: 1375794-3

 Active

[View 3D PDF](#)

### PC/104 and PC/104 Plus

 Always EU RoHS/ELV Compliant  
(Statement of Compliance)

#### Product Highlights:

- Connector
- 104 Positions
- 102 Loaded Positions
- Contact Configuration = Non-Stackthrough
- 2.54 mm Centerline

[View all Features](#)

### Quick Links

- ▶ [Pricing & Availability](#)
- ▶ [Search for Tooling](#)
- ▶ [Product Feature Selector](#)
- ▶ [Contact Us About This Product](#)

[Add to My Part List](#)

[Request Sample](#)

[Find Similar Products](#)

[Buy Product](#)

### Documentation & Additional Information

#### Product Drawings:

- [ASSEMBLY, PC/104, NON-STACKTHROUGH CONTACTS, 2 STAND...](#) (PDF, English)

#### Catalog Pages/Data Sheets:

- [AMPMODU\\_INTERCONNECTION\\_SYSTEM\\_SECTION1AND2](#) (PDF, English)

#### Product Specifications:

- [PC/104 and PC/104-Plus Connector Systems](#) (PDF, English)

#### Application Specifications:

- [PC/104 and PC/104-Plus Connectors](#) (PDF, English)

#### Instruction Sheets:

- None Available

#### CAD Files: (CAD Format & Compression Information)

- [2D Drawing](#) (DXF, Version E)
- [3D Model](#) (IGES, Version E)
- [3D Model](#) (STEP, Version E)

[List all Documents](#)

#### Additional Information:

- [Product Line Information](#)

#### Related Products:

- [Tooling](#)

### Product Features (Please use the Product Drawing for all design activity)

#### Product Type Features:

- [Product Type](#) = Connector
- [Keyed](#) = Yes
- [PCB Mount Style](#) = Through Hole Press Fit
- [PCB Mount Retention Type](#) = Action/Compliant Tail
- [Board Standoff](#) = With
- [Gender](#) = Receptacle

#### Electrical Characteristics:

- [Signal Contact Current \(A\)](#) = 3
- [Insulation Resistance \(MΩ\)](#) = 1,000
- [Dielectric Withstanding Voltage \(V\)](#) = 500

#### Termination Features:

- [Termination Post Length \(mm \[in\]\)](#) = 3.02 [0.119]

#### Housing Features:

- [Centerline \(mm \[in\]\)](#) = 2.54 [0.100]
- [Housing Material](#) = Nylon
- [Housing Color](#) = Black
- [UL Flammability Rating](#) = UL 94V-0

#### Configuration Features:

- [Number of Positions](#) = 104
- [Number of Loaded Positions](#) = 102
- [Number of Standoffs](#) = 2

#### Industry Standards:

- [RoHS/ELV Compliance](#) = RoHS compliant, ELV compliant
- [Lead Free Solder Processes](#) = Not relevant for lead free process

**Body Features:**

- Screw Material = Steel
- Screw Plating = Zinc Chromate

**Contact Features:**

- [Contact Configuration](#) = Non-Stackthrough
- Contact Base Material = Phosphor Bronze
- Contact Plating, Mating Area, Material = Gold

- RoHS/ELV Compliance History = Always was RoHS compliant

**Identification Marking:**

- [Keyed Position](#) = B-10, C-19

**Conditions for Usage:**

- Temperature Range (°C) = -55 - +105

**Other:**

- Brand = AMP
- Comment = See Specific Info Link for information on a PC/104 Extraction Tool.; "Flat-rock" insertable

**Corporate Information**

[About TE](#)  
[Investors](#)  
[News Room](#)  
[Supplier Portal](#)  
[Careers](#)  
[Terms & Conditions](#)  
[Privacy Policy](#)

**Quick Links**

[Distributor Inventory](#)  
[Product Cross Reference](#)  
[Documents & Drawings](#)  
[Product Compliance Support Center](#)  
[Site Map](#)

**Customer Support**

[Email or Chat With Us](#)  
[Find a Phone Number](#)  
[Knowledge Base](#)  
[Manage Your Account](#)

**Keep Me Informed**

LOC	DIST	REVISIONS					
AD	00	P	LTR	DESCRIPTION	DATE	DNW	APVD
		D		ECO-06-7871	28SEP2006	MB	JO
		E		ECO-07-006955	11APR2007	RB	JO

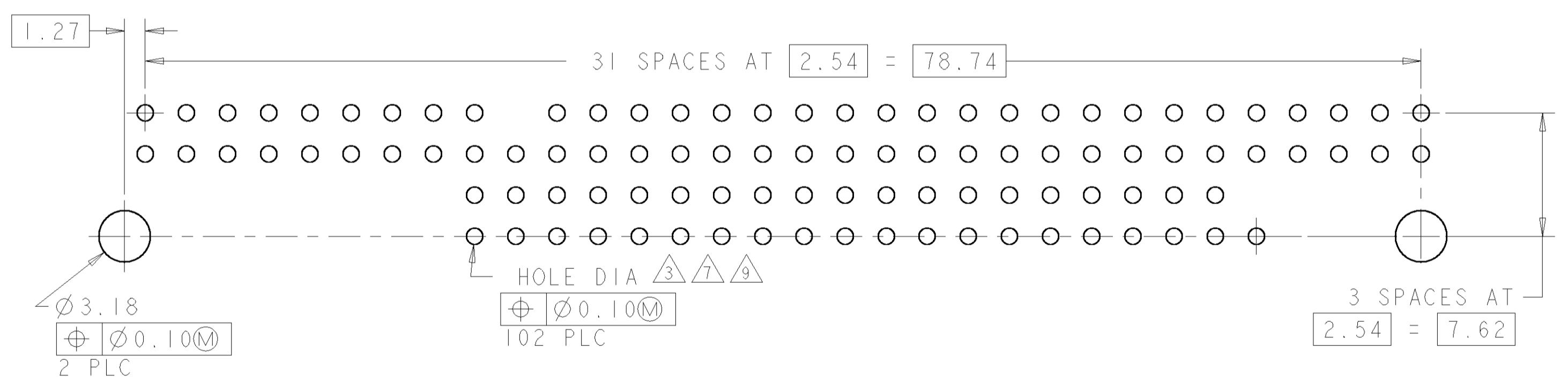
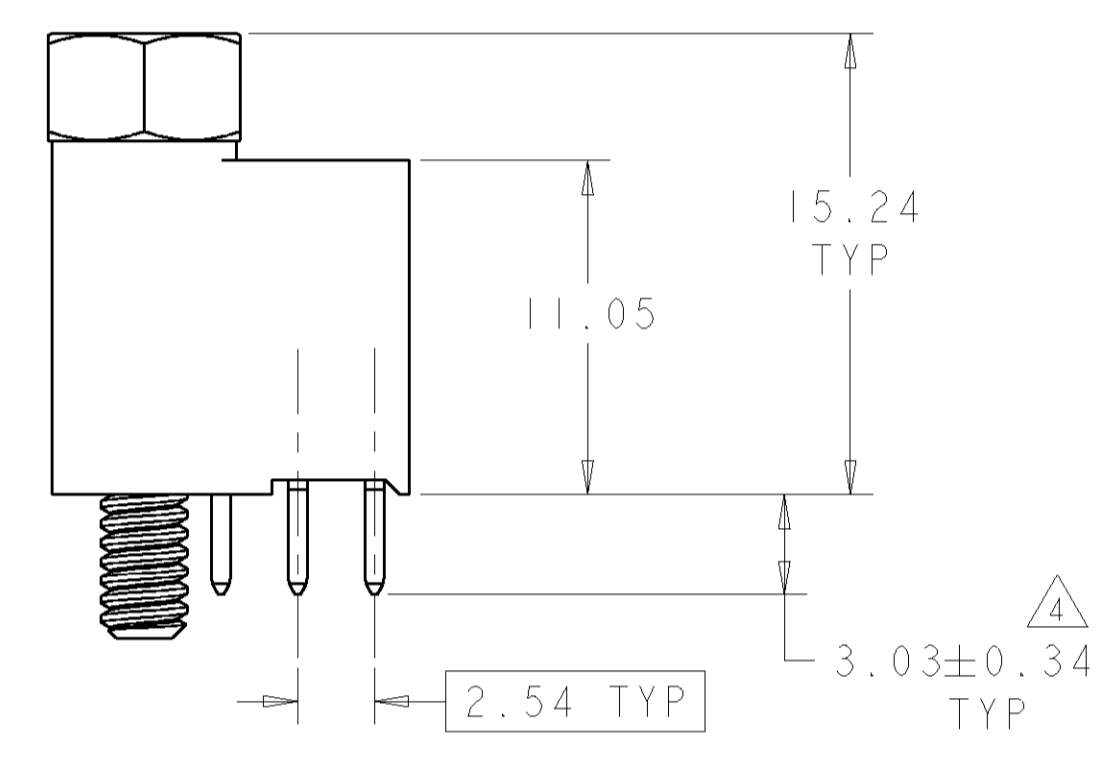
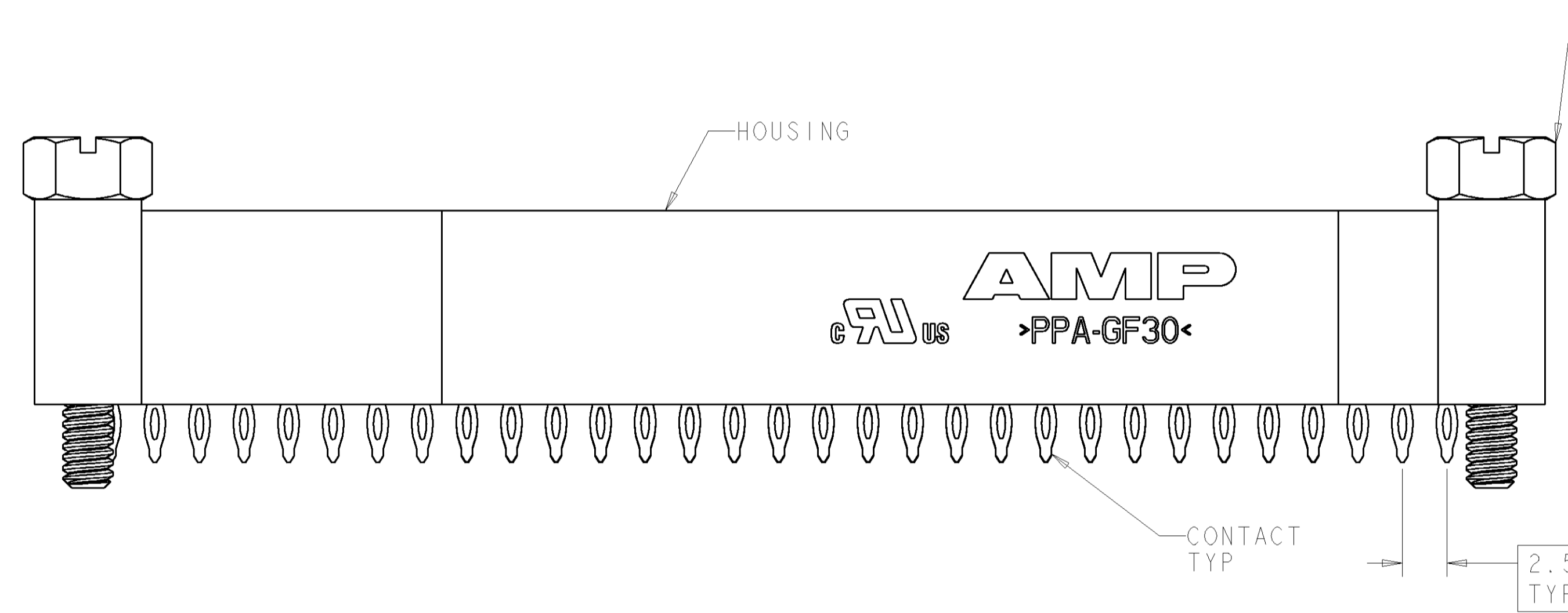
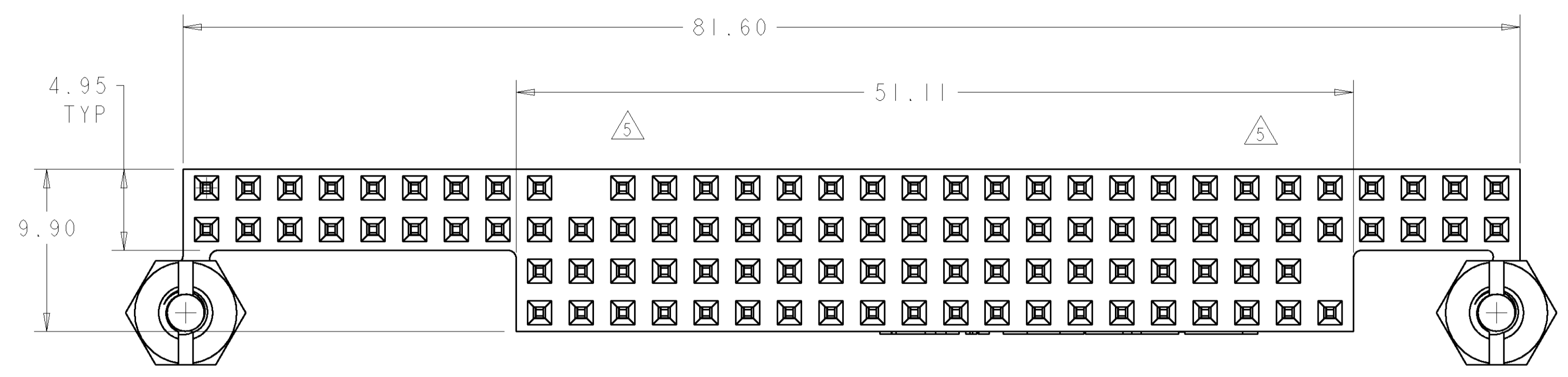

RECOMMENDED PCB LAYOUT FOR 1375794-1 & -3

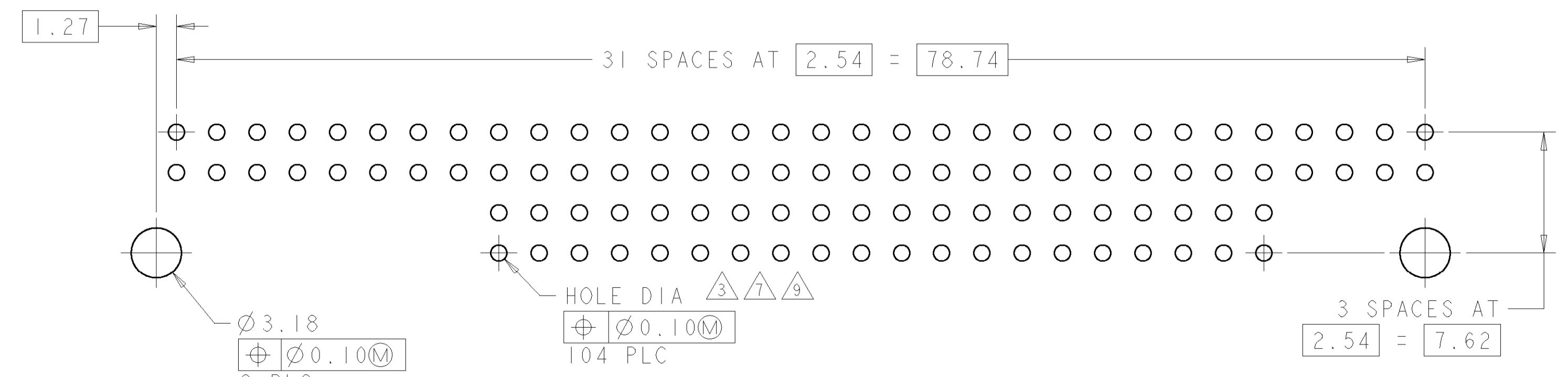

RECOMMENDED PCB LAYOUT FOR 1375794-2 & -4

- △ HOUSING: HIGH TEMPERATURE, GLASS FILLED NYLON, COLOR: BLACK.  
CONTACTS: PHOSPHOR BRONZE.  
SCREWLOCKS: STEEL.
- △ CONTACTS: 0.00038 MIN GOLD ON MATING RECEPTACLE END, 0.00254 BRIGHT TIN-LEAD ON REMAINDER, ALL OVER 0.00127 NICKEL.  
SCREWLOCKS: CLEAR CHROMATE OVER ZINC.
- △ PCB HOLE RECOMMENDATIONS:  
A. DRILL HOLE DIAMETER TO BE 1.15±0.02.  
B. PLATING TO BE 0.005 MIN TIN-LEAD OVER 0.025-0.075 COPPER.  
C. RECOMMENDED FINISH HOLE SIZE IS 1.03±0.08.
- △ DIMENSION AFTER SEATING TO PCB.
- △ NO CONTACT IN THIS POSITION, FOR PART NUMBER 1375794-1 & -3, ONLY
- △ CONTACTS: 0.00038 MIN GOLD ON MATING RECEPTACLE END, 0.00254-0.00508 MATTE TIN ON REMAINDER, ALL OVER 0.00127 NICKEL.  
SCREWLOCKS: CLEAR CHROMATE OVER ZINC.
- △ PCB HOLE RECOMMENDATIONS FOR SILVER IMMERSION PLATING:  
A. DRILL HOLE DIAMETER TO BE 1.20±0.02.  
B. PLATING TO BE 0.0001524-0.0004064 SILVER OVER 0.0508±0.0254 COPPER.  
C. RECOMMENDED FINISH HOLE SIZE IS 1.10-1.19.
- △ TO BE USED ON SILVER IMMERSION PLATED PCB'S (NOTE 7).
- △ PCB HOLE RECOMMENDATIONS FOR ENIG PLATING:  
A. DRILL HOLE DIAMETER TO BE 1.20±0.02.  
B. PLATING TO BE 0.000051-0.000127 GOLD OVER 0.00305-0.00610 NICKEL ALL OVER 0.0508±0.0254 COPPER.  
C. RECOMMENDED FINISH HOLE SIZE IS 1.10-1.19.
- △ TO BE USED ON STANDARD PCB (NOTE 3) OR ENIG PLATED PCB (NOTE 9).

FINISH	KEYED CIRCUITS	PART NO
8	6	NO 1375794-4
6	6	YES 5 1375794-3
10	2	NO 1375794-2
10	2	YES 5 1375794-1

DIMENSIONS:		TOLERANCES UNLESS OTHERWISE SPECIFIED:		DWG: W.G. LENKER 02JUN2000		ENR: L.BREKOSKY 15JAN2001		NAME: AMP Tyco Electronics Harrisburg, PA 17105-3608	
mm	0 PLC ±	1 PLC ±	2 PLC ±0.13	3 PLC ±	4 PLC ±	APVD	PRODUCT SPEC	108-1956	ASSEMBLY, PC/104, NON-STACKTHROUGH CONTACTS, 2 STANDOFFS, PRESS FIT
	ANGLES			114-13021	WEIGHT	SIZE	CAGE CODE	DRAWING NO	RESTRICTED TO
MATERIAL	FINISH			00779	SCALE	4:1	SHEET	1 OF 1	REV
CUSTOMER DRAWING								E	