

Distributed by:

**JAMECO<sup>®</sup>**  
**ELECTRONICS**

[www.Jameco.com](http://www.Jameco.com) ♦ 1-800-831-4242

The content and copyrights of the attached  
material are the property of its owner.

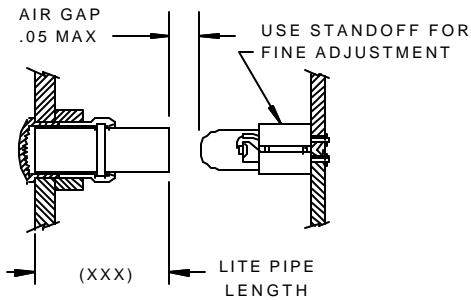
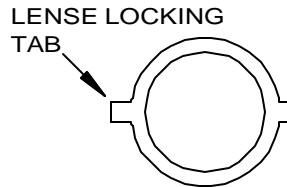
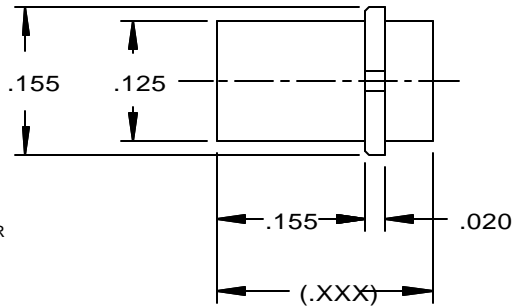
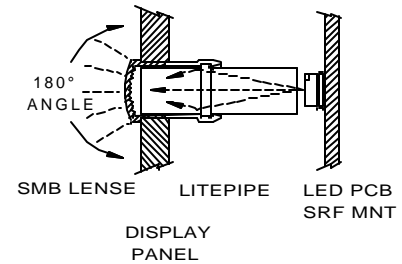
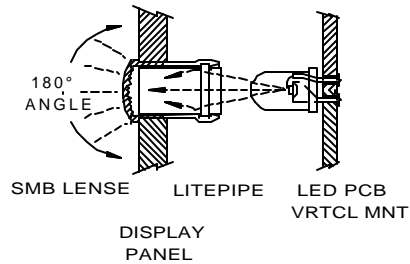
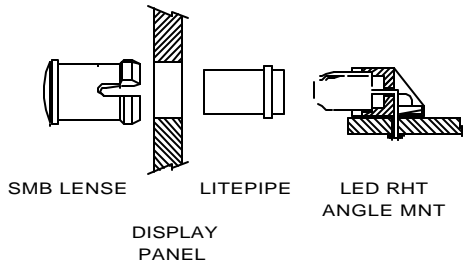

ORDERING CODE

MODEL	LSV 040 CTP	COLOR	CTP CLEAR
CODE (INCHES)			
020		.200"	
040		.400"	
060		.600"	
080		.800"	
100		1.0"	
120		1.2"	
Length = front of panel to LED			

NOTES:

- (1) Material: Acrylic (Optical grade)
- (2) Mounting: Use CLIPLITE Lenses SMB 200 and SMQ 250 Series. Lenses mounts in a .171" hole on 1/4" centers. Panel thickness 1/32" to 1/8". Standoff available in increments of .010" for fine LED height adjustment. See VCC catalog for lense and standoff spec. spec.
- (3) Lense Lock: Insert litepipe into lense aligning the tabs with the lense slot.

U.S. & Foreign Pat. Issued & Pend.

REVISIONS			
NO	DESCRIPTION	DATE	BY
1			
2			
3			
4			
5			

CLIPLITE<sup>®</sup> 3mm LITEPIPE VERTICAL

**VCC** VISUAL COMMUNICATIONS COMPANY, INC.  
 7920-F Arjons Drive San Diego, California 92126 U.S.A.  
 Phone (858) 549-6900 Fax (858) 549-3520 e-mail vccsales@vcdlite.com

TOLERANCES	SCALE	N/A	DATE	04/04/96	DRAWING NO.
DECIMAL	±.010	DIAMETER	.003 TIR	DRAWN BY	JMS
ANGLE	± 30'	RADII	.008 Max	CHK'D	

LSV000A