

SMD 1202/1582.5 MHz Dual-SAW Filter

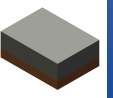

AFII-SW-0075-Q

Request Samples



Check Inventory



1.5 x 1.1 x 0.7 mm
RoHS Compliant
MSL Level = 1

Features

- AEC-Q200 Qualified
- Dual-SAW Technology
- Supports GNSS L1 / L2 / L5 Band
- 1.5 x 1.1 x 0.7 mm in Size
- Out-of-Band Rejection: > 28 dB
- Maximum Input Power: 10dBm
- RoHS Compliant

Applications

- GNSS Modules
- RTK Systems
- Automotive Transportation & Telematics
- Asset Tracking / Fleet Management
- UAVs, Robotics & Autonomous Vehicles
- Micro-Mobility Solutions
- Precision Agriculture

Product Image

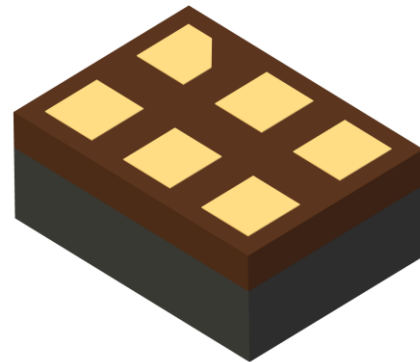
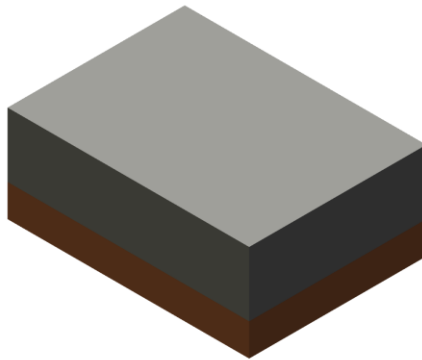

SMD 1202/1582.5 MHz Dual-SAW Filter

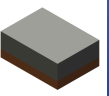

AFII-SW-0075-Q

Request Samples



Check Inventory



1.5 x 1.1 x 0.7 mm
RoHS Compliant
MSL Level = 1

Electrical Specification

Parameters	Minimum	Typical	Maximum	Units	Notes
Center Frequency (f_c)	-	1582.5	-	MHz	L1 Band
VSWR ⁽¹⁾	-	1.9	2.3	-	1559 – 1606 MHz
Insertion Loss ⁽¹⁾	-	2.7	3.5	dB	1559 – 1606 MHz
Amplitude Ripple ⁽¹⁾	-	1.0	1.5	dB	1559 – 1606 MHz
Group Delay ⁽¹⁾	-	9	20	ns	1559 – 1606 MHz
Center Frequency (f_c)	-	1202	-	MHz	L2 / L5 Band
VSWR ⁽¹⁾	-	1.7	2.3	dB	1166– 1238 MHz
Insertion Loss ⁽¹⁾	-	1.8	3	dB	1166– 1238 MHz
Amplitude Ripple ⁽¹⁾	-	1.0	1.5	dB	1166– 1238 MHz
Group Delay ⁽¹⁾	-	11	25	ns	1166– 1238 MHz
Attenuation ⁽¹⁾ (Reference level from 0 dB)	30	36	-	dB	100 - 1106 MHz
	20	31	-	dB	1106 - 1136 MHz
	25	28	-	dB	1268- 1510 MHz
	28	33	-	dB	1710- 2000 MHz
	25	30	-	dB	2000- 3000 MHz
Input Power Level	-	-	10	dBm	-
DC Voltage (V)	-	-	3	V	-
Temperature Coefficient of Frequency	-	-36	-	ppm/°C	-

Notes: (1) Averaged values of linear S-Parameters at +25°C

(2) A matching network is necessary (refer to the Measurement Circuits section)

Mechanical Specification

Parameters	Specifications
Filter Dimension	1.5 x 1.1 x 0.7 mm
Mounting Type	Surface Mount

Environmental Specification

Parameters	Specifications
Operating Temperature Range	-40°C ~ +85°C
Storage Temperature Range	-40°C ~ +85°C
ESD	50V(MM), 100V(HBM)
MSL level	1
RoHS Compliant	Yes



5101 Hidden Creek Ln Spicewood TX 78669
 Phone: 512-371-6159 | Fax: 512-351-8858
 For terms and conditions of sales, please visit:
www.abracon.com

REVISED: 07-01-25

ABRACON IS
 ISO9001-2015
 CERTIFIED

SMD 1202/1582.5 MHz Dual-SAW Filter

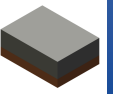

AFII-SW-0075-Q

Request Samples



Check Inventory



1.5 x 1.1 x 0.7 mm
RoHS Compliant
MSL Level = 1

Ordering Information

Part Number	Description
AFII-SW-0075-Q	SMD 1202/1582.5 MHz Dual-SAW Filter on Cut Tape
AFII-SW-0075-Q-T	SMD 1202/1582.5 MHz Dual-SAW Filter on Tape & Reel
AFII-SW-0075-Q-EVB	SMD 1202/1582.5 MHz Dual-SAW Filter Evaluation Board

Note: Other options not listed may be available upon request via [Abracon online support](#)

SMD 1202/1582.5 MHz Dual-SAW Filter

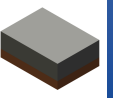

AFII-SW-0075-Q

Request Samples



Check Inventory



1.5 x 1.1 x 0.7 mm
RoHS Compliant
 MSL Level = 1

Product Dimensions

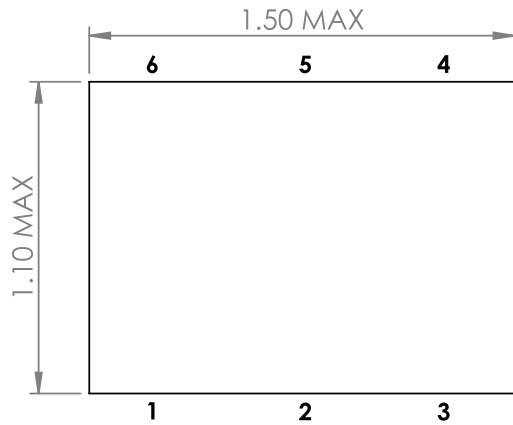

TOP VIEW

PIN #	FUNCTION
1	GROUND
2	INPUT
3	GROUND
4	GROUND
5	OUTPUT
6	GROUND

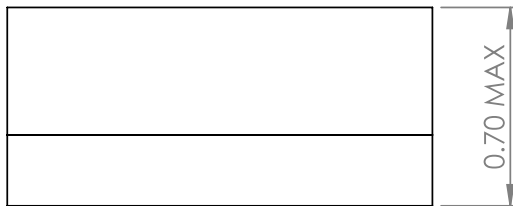

FRONT VIEW

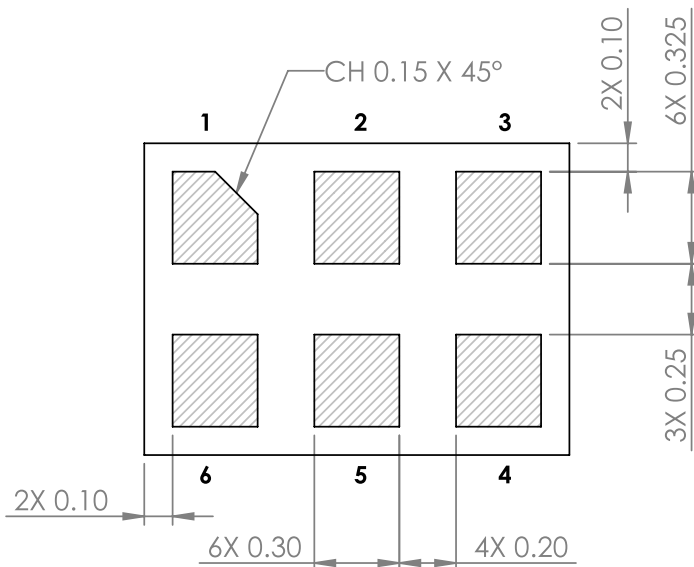

BOTTOM VIEW

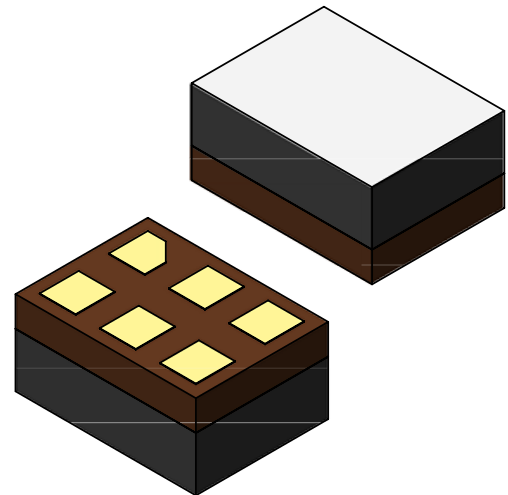

Unit : mm

SMD 1202/1582.5 MHz Dual-SAW Filter

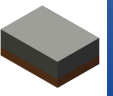

AFII-SW-0075-Q

Request Samples



Check Inventory



1.5 x 1.1 x 0.7 mm
RoHS Compliant
MSL Level = 1

Recommended Land Pattern

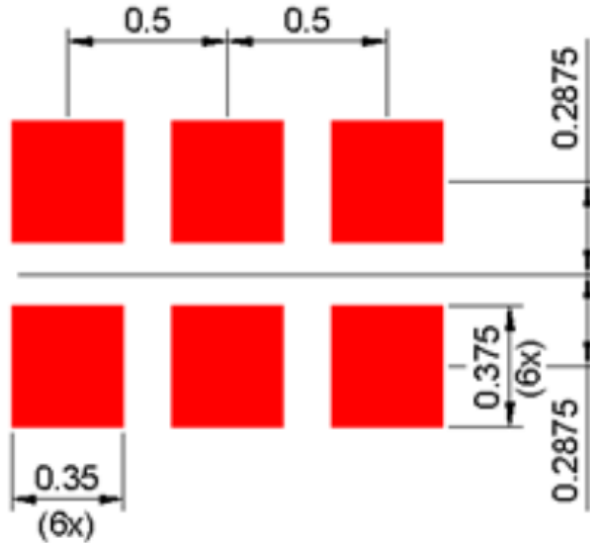

Landing pad tolerance -0.02mm
Unit:mm

Please note: The line width should be designed to achieve a 50-ohm characteristic impedance, depending on the PCB material and thickness. For technical assistance, please contact [Abracon online support](#) through our online support platform

SMD 1202/1582.5 MHz Dual-SAW Filter

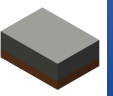

AFII-SW-0075-Q

Request Samples



Check Inventory



1.5 x 1.1 x 0.7 mm
RoHS Compliant
MSL Level = 1

Measurement Circuit

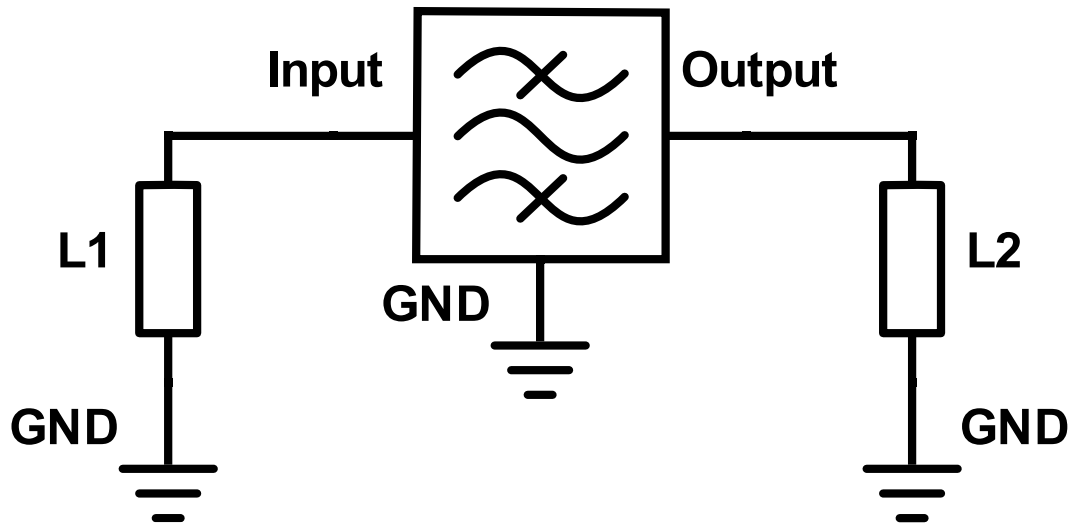

Port	Matching Component
Input (Pin 2)	L1: 4.2 nH
Output (Pin 5)	L2: 4.2 nH

SMD 1202/1582.5 MHz Dual-SAW Filter

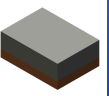

AFII-SW-0075-Q

Request Samples



Check Inventory



1.5 x 1.1 x 0.7 mm
RoHS Compliant
MSL Level = 1

Frequency Characteristics

S21 narrow band

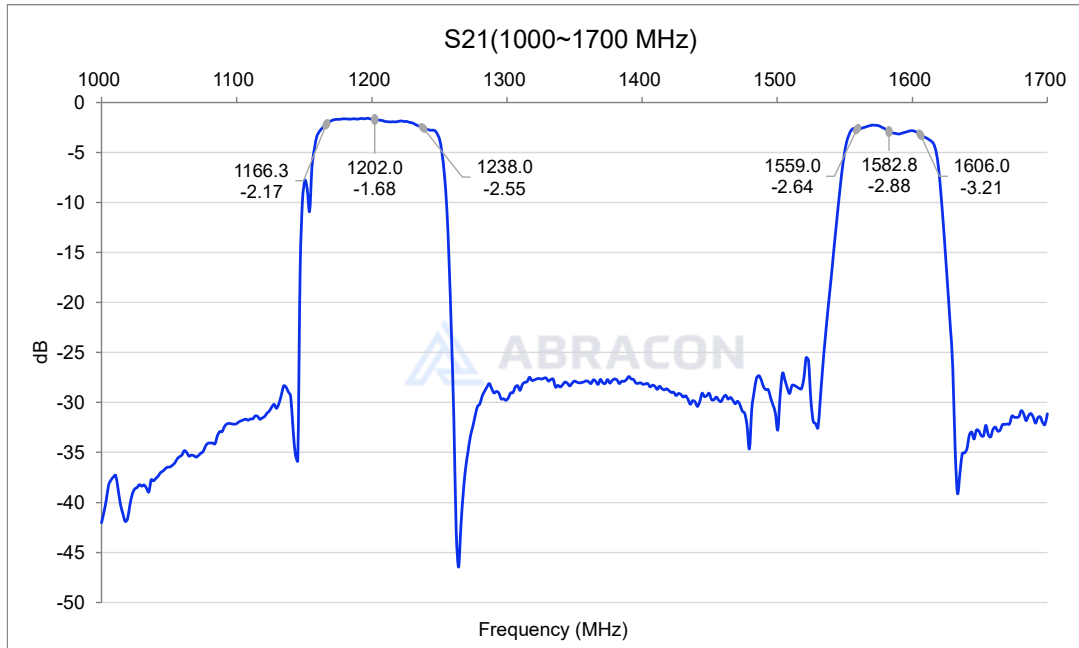

S21 wide band

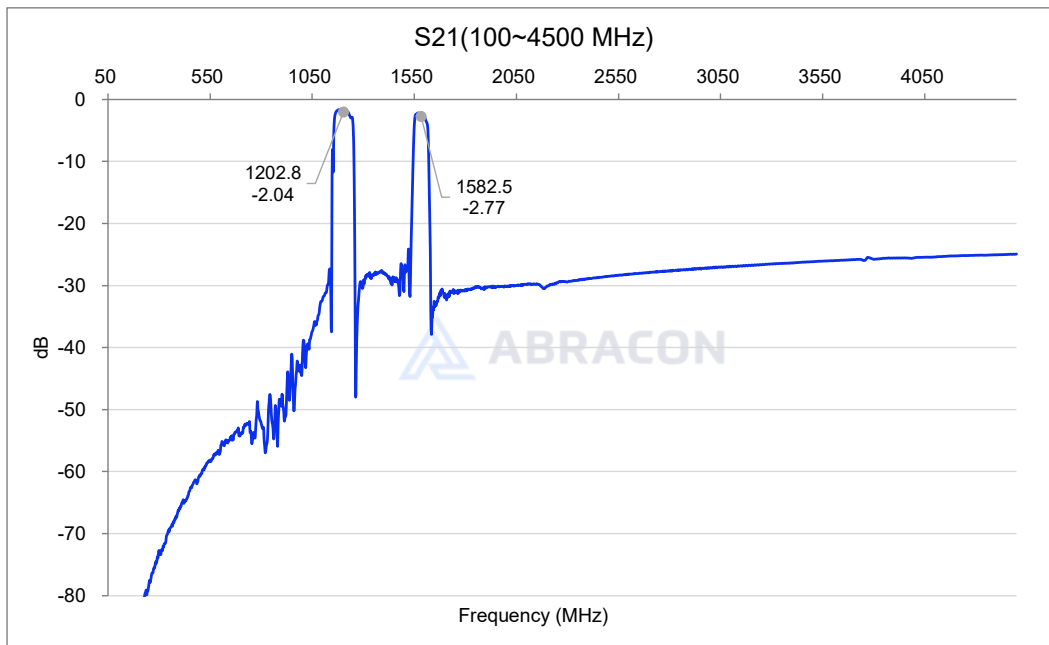

SMD 1202/1582.5 MHz Dual-SAW Filter

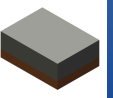

AFII-SW-0075-Q

Request Samples



Check Inventory



1.5 x 1.1 x 0.7 mm
RoHS Compliant
MSL Level = 1

Group Delay Ripple

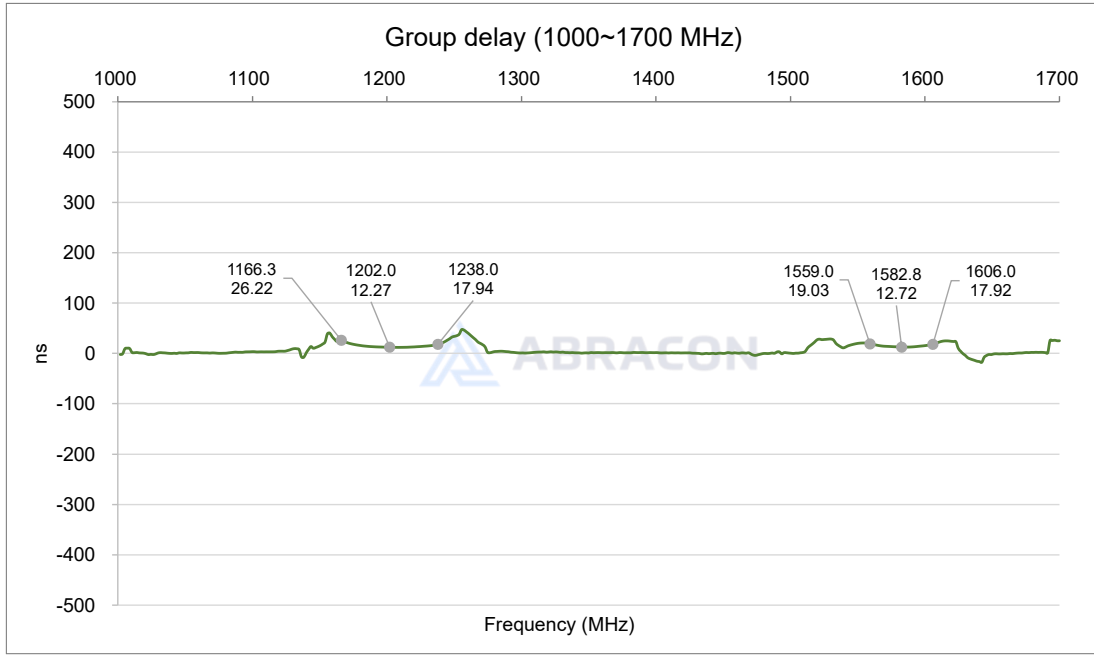

SMD 1202/1582.5 MHz Dual-SAW Filter

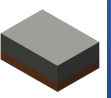

AFII-SW-0075-Q

Request Samples



Check Inventory



1.5 x 1.1 x 0.7 mm
RoHS Compliant
MSL Level = 1

VSWR (S11 & S22)

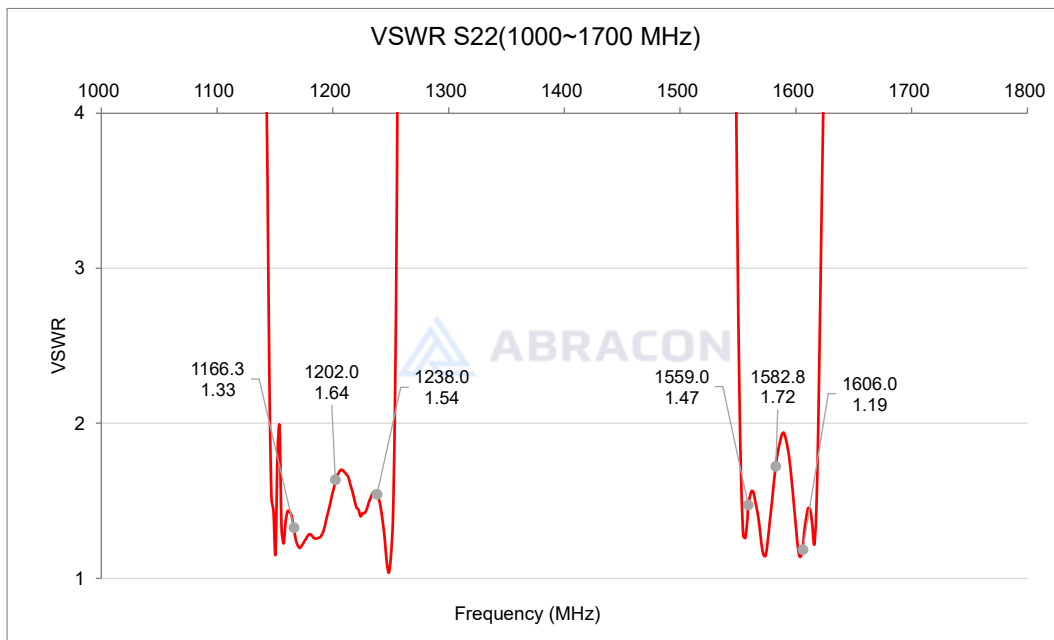
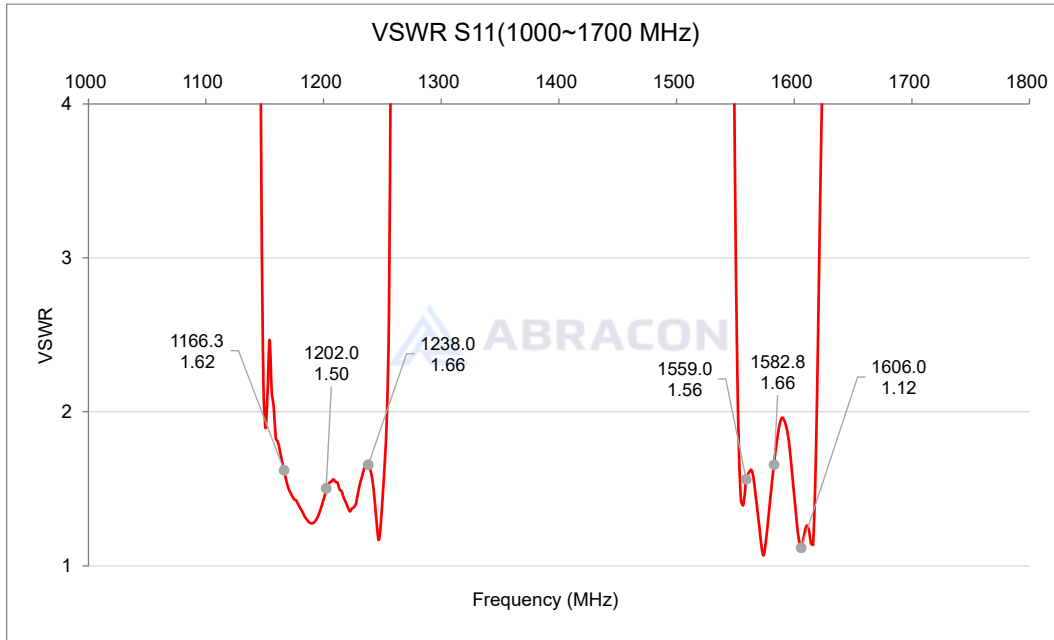

SMD 1202/1582.5 MHz Dual-SAW Filter

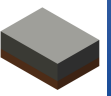

AFII-SW-0075-Q

Request Samples



Check Inventory



1.5 x 1.1 x 0.7 mm
RoHS Compliant
MSL Level = 1

Smith Chart (S11 & S22)

Smith chart S11 (1166~1606MHz)

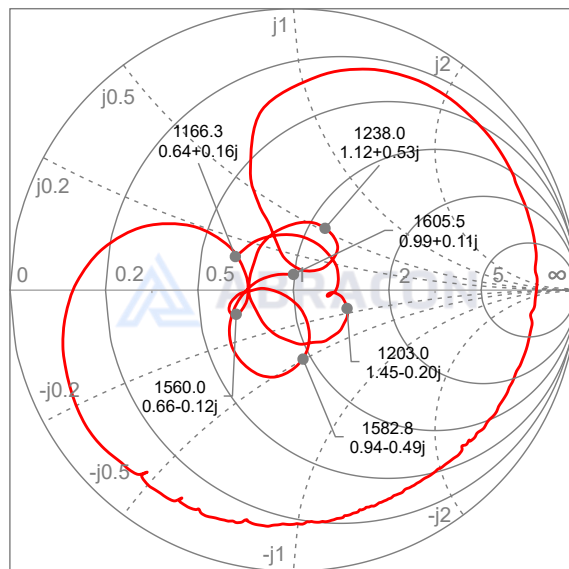

Smith chart S22 (1166~1606MHz)

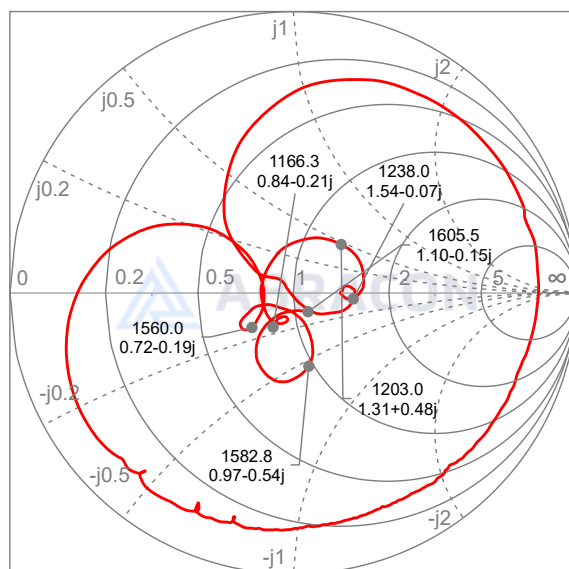

SMD 1202/1582.5 MHz Dual-SAW Filter

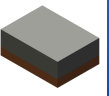

AFII-SW-0075-Q

Request Samples



Check Inventory



1.5 x 1.1 x 0.7 mm
RoHS Compliant
MSL Level = 1

Reflow Profile [JEDEC J-STD-020]

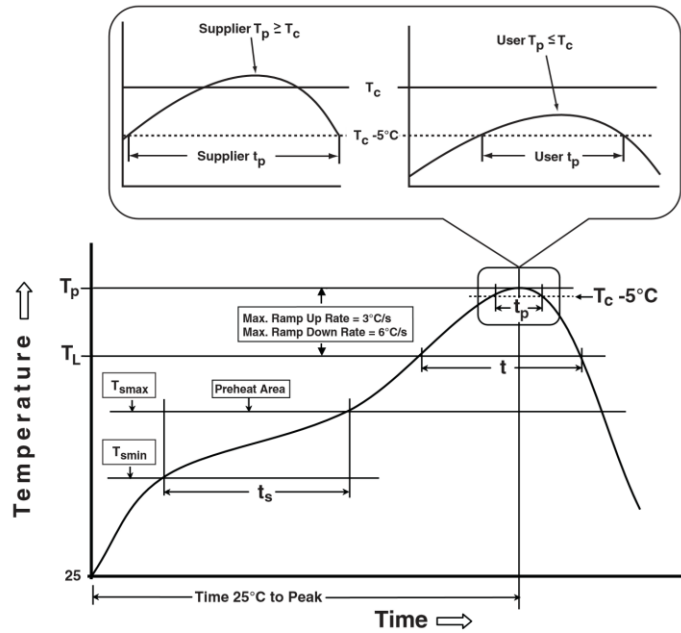

Table 1

SnPb Eutectic Process Classification Temperatures (T_c)		
Package Thickness	Volume mm^3 <350	Volume mm^3 \geq 350
<2.5mm	235°C	220°C
\geq 2.5mm	220°C	220°C

Table 2

Pb-Free Process Classification Temperatures (T_c)			
Package Thickness	Volume mm^3 <350	Volume mm^3 350-2000	Volume mm^3 >2000
<1.6mm	260°C	260°C	260°C
1.6mm - 2.5mm	260°C	250°C	245°C
>2.5mm	250°C	245°C	245°C

Profile Feature	Sn-Pb Eutectic Assembly	Pb-Free Assembly
Preheat / soak		
Temperature minimum (T_{smin})	100°C	150°C
Temperature maximum (T_{smax})	150°C	180°C
Time (T_{smin} to T_{smax}) (t_s)	60 – 120 sec.	60 – 90 sec.
Average ramp-up rate (T_{smax} to T_p)	3°C/sec. max	3°C/sec. max
Liquidous temperature (T_L)	183°C	220°C
Time at Liquidous (T_L)	60 – 150 sec.	50 – 80 sec.
Peak package body temperature (T_p)*	See Table 1	See Table 2
Time (T_p)** within 5°C of the specified classification temperature (T_c)	20 sec.	20 ~ 40 sec.
Ramp-down rate (T_p to T_{smax})	6°C/sec. max	6°C/sec. max
Time 25°C to peak temperature	6 min. max	8 min. max
Reflow cycles	2 max	2 max

*Tolerance for peak profile temperature (T_p) is defined as a supplier minimum and a user maximum.

**Tolerance for time at peak profile temperature (t_p) is defined as a supplier minimum and a user maximum.



5101 Hidden Creek Ln Spicewood TX 78669
Phone: 512-371-6159 | Fax: 512-351-8858
For terms and conditions of sales, please visit:
www.abracon.com

REVISED: 07-01-25

ABRACON IS
ISO9001-2015
CERTIFIED

SMD 1202/1582.5 MHz Dual-SAW Filter

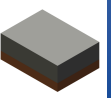

AFII-SW-0075-Q

Request Samples



Check Inventory



1.5 x 1.1 x 0.7 mm
RoHS Compliant
MSL Level = 1

Packaging

Tape & Reel Dimension

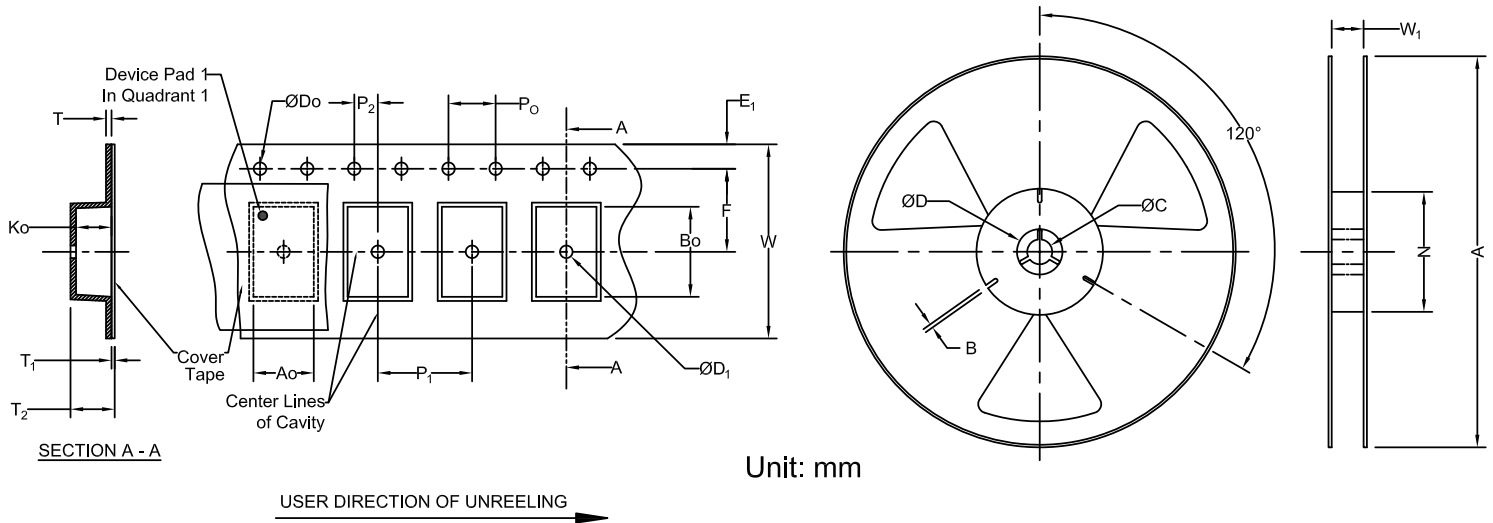

Unit: mm

Carrier Tape Specifications (mm)

Do	D1	E1	P0	P2	T	F	P1	W	A0	B0	K0	Reel Qty
1.55 ± 0.05	1.0	1.75 ± 0.1	4.0 ± 0.1	2.0 ± 0.05	0.2 ± 0.05	3.5 ± 0.05	4.0 ± 0.1	8.0 ± 0.3	1.47 ± 0.1	1.73 ± 0.1	0.75 ± 0.1	3,000

Reel Specifications (mm)

A	W1	N	C	B
178.0 ± 1.0	8.4	72.0 ± 1.0	13.0 ± 0.2	2.5

ATTENTION: Abracon LLC's products are Commercial-Off-The-Shelf ('COTS'), which are designed, intended, and validated for use in commercial, industrial, and automotive applications. The customer is responsible for testing and verifying the performance of an Abracon solution to meet their system-level requirements.



5101 Hidden Creek Ln Spicewood TX 78669
 Phone: 512-371-6159 | Fax: 512-351-8858
 For terms and conditions of sales, please visit:
www.abracon.com

REVISED: 07-01-25

ABRACON IS
 ISO9001-2015
 CERTIFIED