

CABLE 184 RF: HIROSE U.FL PLUG + SMA STRAIGHT BULKHEAD JACK WITH O-RING RATED TO IP67/68 + MULTIPLE CABLE SIZES

SPECIFICATIONS :

- HIROSE U.FL PLUG, P/N: FOR ϕ 1.37MM CABLE: U.FL-LP-088.
FOR ϕ 1.13MM CABLE: U.FL-LP-068.
FOR ϕ 1.32MM DS CABLE: U.FL-LP-066.
FOR ϕ 0.81MM CABLE: U.FL-LP(V)-040.
- COAXIAL CABLE, SEE P/N OPTIONS.
- SMA STRAIGHT BULKHEAD JACK WITH O-RING RATED TO IP67/68, P/N: RFCT-SMA002-F78.

USAGE PRECAUTIONS: CABLES USING 'MICRO' COAX ARE DELICATE:

- HANDLE WITH CARE.
- DO NOT TWIST; APPLY EXCESSIVE FORCES OR SHARP BENDS TO THE CABLE. DO NOT FORCEFULLY DEFORM WIRES.
- CONSULT CONNECTOR MANUFACTURER'S DATASHEETS FOR DETAILED NOTES ON HANDLING INSTRUCTIONS.

ENVIRONMENTAL:

- A. BULKHEAD MOUNTED CONNECTOR (RFCT-SMA002-F78) TESTED TO THE FOLLOWING SPECIFICATION:
- IP6X - DUST TIGHT - NO PARTICLE INGRESS.
 - IPX7 WATERPROOF FOR 30 MINUTES UP TO 1 METER UNDERWATER.
 - IPX8 WATERPROOF FOR 48 HOURS AT 1 METER UNDERWATER.
 - IPX8 WATERPROOF FOR 12 HOURS AT 5 METERS UNDERWATER.
 - PRESSURE TEST - 1 BAR FOR 10 SECONDS.

NOTES:

- THE ORIENTATION OF CONNECTORS ON DRAWING IS FOR REFERENCE ONLY, IF THE ORDER IS LEFT BLANK THE CONNECTOR WILL NOT HAVE FIXED ORIENTATION.
- FIXED ORIENTATION IS SUGGESTED FOR CABLE LENGTH 25MM TO 100MM. PLEASE SPECIFY THE FIXED ORIENTATIONS FROM THE ORDER CODE (F1, F2, ETC)
- CONTACT GCT IF THE ORIENTATION YOU REQUIRE IS NOT SHOWN.
- WORKING FREQUENCY RANGE: DC-3GHZ.
- OPERATING TEMPERATURE: -40°C TO +85°C.
- IMPEDANCE: 50 OHM.

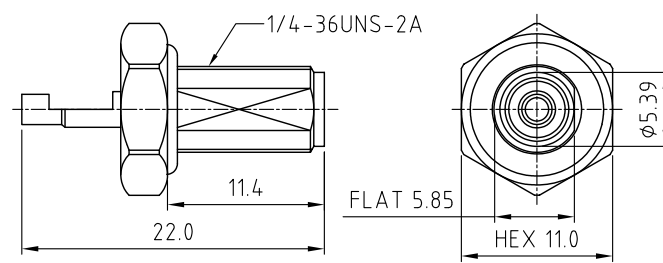
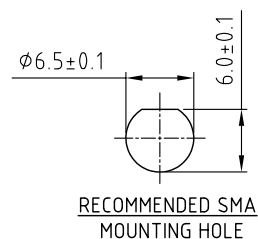
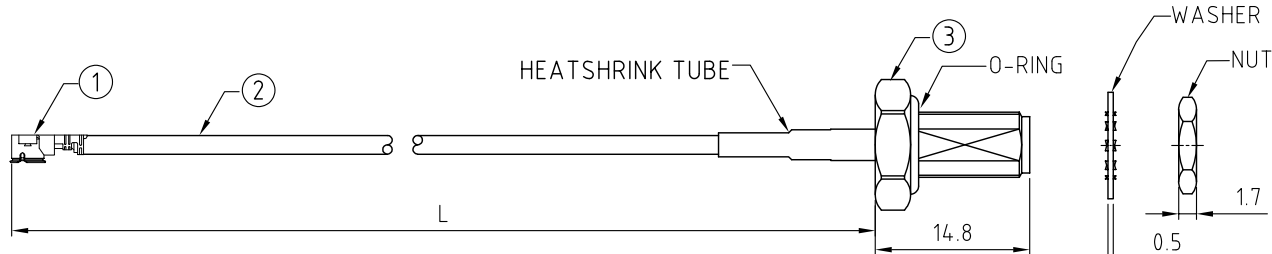

HOW TO ORDER

CABLE 184 RF - XXX - XX - X - X - X

"L" LENGTH IN MM:
eg: 100MM = 100
(MIN. 050-MAX.400)
STANDARD = 100, 150, 200
Tolerance: 50-200mm: ±5mm.
201-400mm: ±7mm.

HEAT SHRINK TUBE COLOR OPTIONS:
BLANK = BLACK (STANDARD)
B = BLUE

CABLE SIZE OPTIONS:
1 = ϕ 1.37MM CABLE, COLOR: BLACK.
2 = ϕ 1.13MM CABLE, COLOR: GRAY.
3 = ϕ 1.32MM DS CABLE, COLOR: GRAY
4 = ϕ 0.81MM CABLE, COLOR: GRAY

WASHER AND NUT OPTIONS:
BLANK = SEPARATELY PACKED (STANDARD)
A = ALL ASSEMBLED WITH CONNECTOR

ORIENTATION OPTIONS:
BLANK = DOES NOT HAVE A FIXED ORIENTATION
F1 = U.FL CONNECTION DOWN (L=25-200MM)
F2 = U.FL CONNECTION UP (L=25-200MM)
(SEE NOTES 1, 2, 3 AND DIAGRAMS FOR MORE INFORMATION)

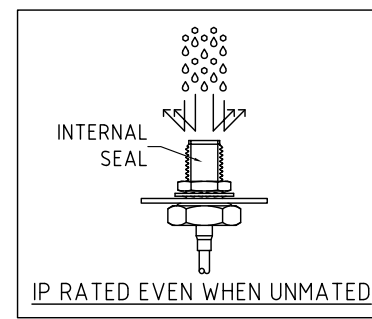
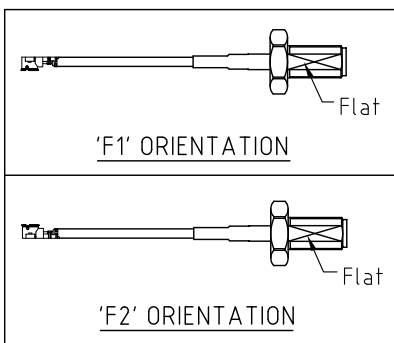

REV. DATE & DRN	10. 28/10/14 - NYW RELEASE
11. 28/07/15 - NYW PART NUMBER.	
12. 30/07/15 - NYW PART NUMBER.	
13. ADD IP67/68 RATING INFO.	
14. ADD IP67/68 RATING INFO.	
15. ADD IP67/68 RATING INFO.	
16. ADD IP67/68 RATING INFO.	
17. ADD IP67/68 RATING INFO.	
18. ADD IP67/68 RATING INFO.	
19. ADD IP67/68 RATING INFO.	
20. ADD IP67/68 RATING INFO.	
21. ADD IP67/68 RATING INFO.	
22. ADD IP67/68 RATING INFO.	
23. ADD IP67/68 RATING INFO.	
24. ADD IP67/68 RATING INFO.	
25. ADD IP67/68 RATING INFO.	
26. ADD IP67/68 RATING INFO.	
27. ADD IP67/68 RATING INFO.	
28. ADD IP67/68 RATING INFO.	
29. ADD IP67/68 RATING INFO.	
30. ADD IP67/68 RATING INFO.	
31. ADD IP67/68 RATING INFO.	
32. ADD IP67/68 RATING INFO.	
33. ADD IP67/68 RATING INFO.	
34. ADD IP67/68 RATING INFO.	
35. ADD IP67/68 RATING INFO.	
36. ADD IP67/68 RATING INFO.	
37. ADD IP67/68 RATING INFO.	
38. ADD IP67/68 RATING INFO.	
39. ADD IP67/68 RATING INFO.	
40. ADD IP67/68 RATING INFO.	
41. ADD IP67/68 RATING INFO.	
42. ADD IP67/68 RATING INFO.	
43. ADD IP67/68 RATING INFO.	
44. ADD IP67/68 RATING INFO.	
45. ADD IP67/68 RATING INFO.	
46. ADD IP67/68 RATING INFO.	
47. ADD IP67/68 RATING INFO.	
48. ADD IP67/68 RATING INFO.	
49. ADD IP67/68 RATING INFO.	
50. ADD IP67/68 RATING INFO.	

Scale: NTS	THIRD ANGLE	Unstated Tolerances:
Drawn: KY		.X ±0.2
App'd: XXX	Title CABLE ASSEMBLY	.XX ±0.2
Date: 16 FEB. '25	Revision: 1.9	.XXX ±0.2
	Unit: mm	ANGLES ±5

IP Rated RF Products		
www.gct.co	www.gradconn.com	

Type: Cable 184 RF	CABLE 184 RF
Drawing Number:	Sheet 1 of 1
Drawing ©	E and O E

THIS DRAWING IS CONFIDENTIAL AND MUST NOT BE COPIED OR DISCLOSED WITHOUT WRITTEN CONSENT