

APPROVAL SHEET

To :

Customer P/N :

UDE P/N : SS00-KW-0001

Description : SFP+ Connector

Right Angle;SMT

Contact Area : 15 μ " Min. Gold

Packing with Tape Reel



Spec No.
SS0022002-00

Update Date
2022/5/16

Revision
A

| Approved | Checked | Prepared |
|----------|---------|----------|
| | | |



湧德電子 股份有限公司
UDE Corp.

桃園市(33852) 蘆竹區內溪路 68 巷13號

No.13, Ln. 68, Neixi Rd., Luzhu Dist., Taoyuan City (33852), Taiwan

TEL: 886-3-3242000 FAX: 886-3-3246611

<http://www.ude-corp.com/>

1. MECHANICAL DIMENSION

Product Dimension

| | | |
|---------|---------------------|---------------|
| Unit:mm | General Tolerance : | X.X : ± 0.25 |
| | | X.XX : ± 0.13 |

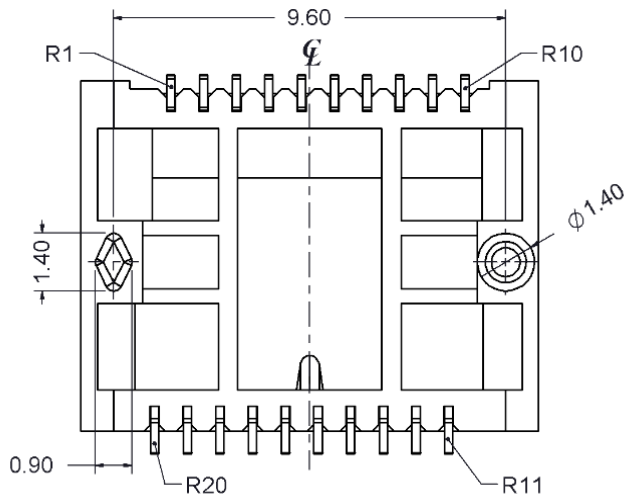
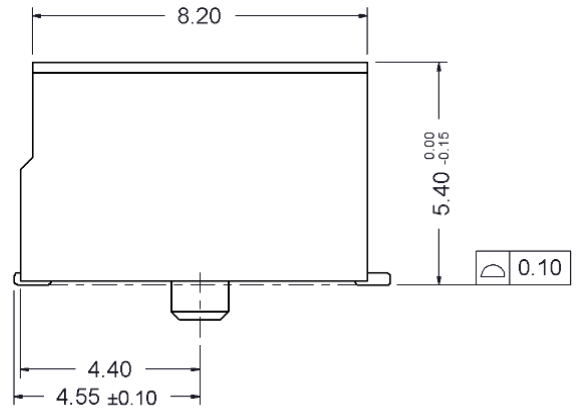
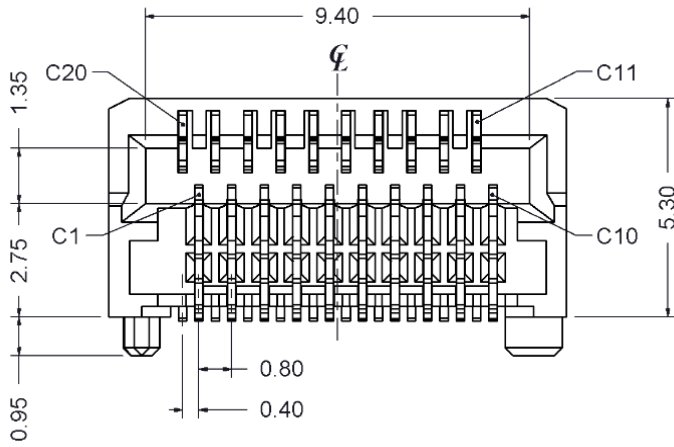
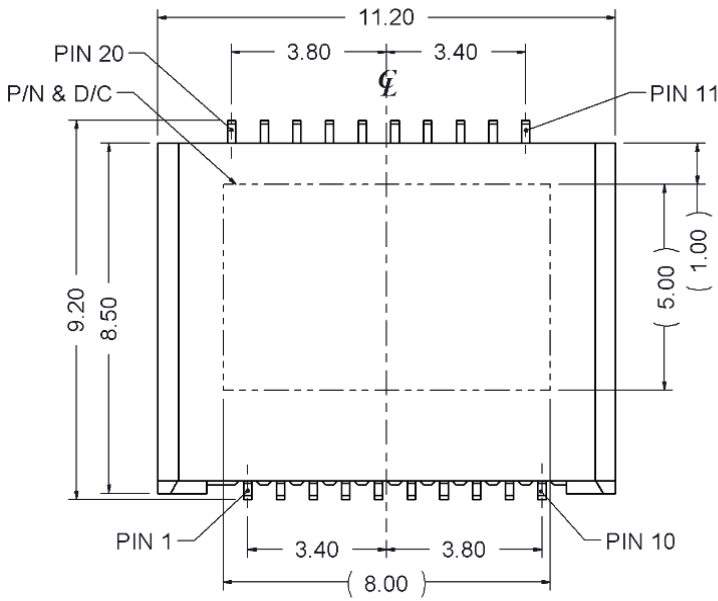

2. REQUIREMENTS

Design and Construction

Product shall be of design, construction and physical dimensions specified on applicable.

Material

Terminal Parts (Underplating : 50 μ " min. Nickel overall)

Terminal : PH. Bronze, Thickness=0.20mm

Finish : Contact Area : 15 μ " Gold

Solder Tail : 100 μ " min. Matte Tin

Plastic Parts

Housing : LCP, Black <UL94V-0>

3. Operating and Storage Temperature

Operating Temperature : -40°C to +85°C

Storage Temperature : -55°C to +105°C

4. SFP+ 1X Connector specifications

Contact Current Rating: 0.5A (per contact)

Insulation Resistance : 1000MΩ min.

Dielectric Withstanding Voltage : 300VDC @1min.

Insertion force : 40N MAX.

Extraction force : 12.5N MAX.

Durability : 100 cycles MIN.

5. Performance and Test Description

Product is designed to meet electrical, mechanical and environmental performance requirements specified in below table. All tests are performed at ambient environmental conditions per MIL-STD-1344A and EIA-364 unless otherwise specified.

6. Packaging and Packing

All parts shall be packaged and packed to protect against physical damage, corrosion and deterioration during shipment and storage.

7. IR REFLOW TEMPERATURE PROFILE

Temperature condition of reflow soldering

| Contents | Soldering Condition |
|----------------------------|---------------------|
| A : Increasing speed | 3±1°C/sec |
| B : Pre-heat starting Temp | 150°C |
| C : Pre-heat ending Temp | 180°C |
| D : Pre-heat interval | 120 sec or over |
| E : Over 217°C time | 60~150 sec |
| F : Peak Temperature | 250°C max. 10sec |

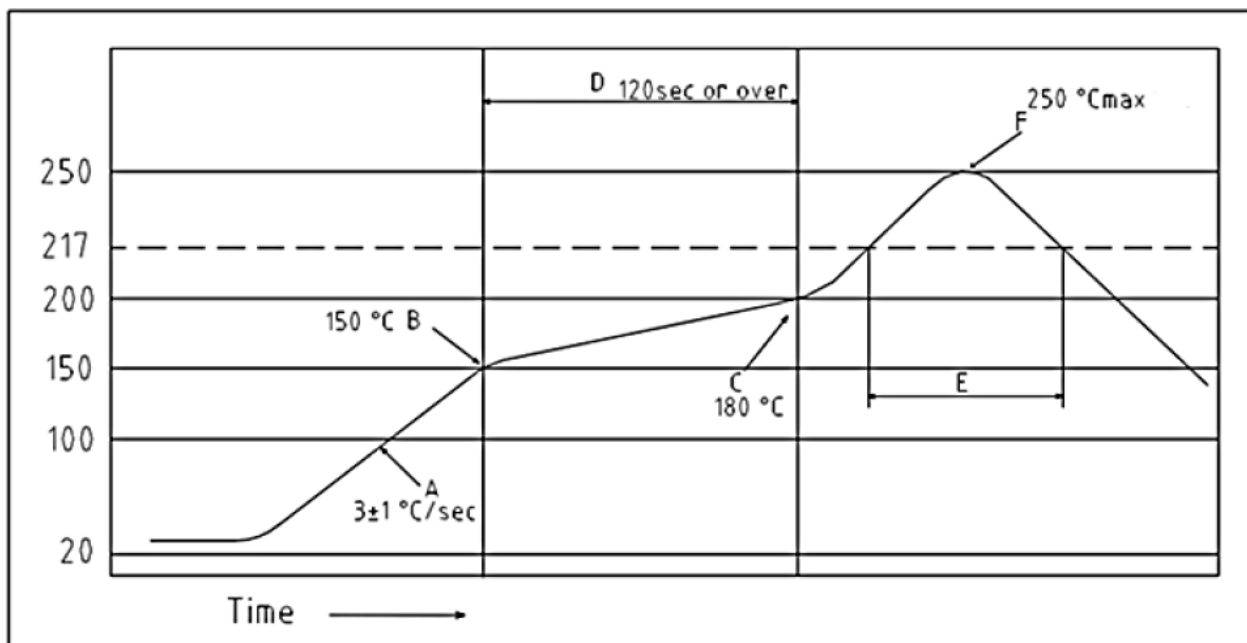

Type of lead-free solder should be 96.5Sn-3.0Ag-0.5Cu or 99.3Sn-0.7Cu.



UDE Corp.

Engineering Change Notice

ECN NO. : EC20040548

ECN分類: 工程圖 規格 BOM 包裝規範

已發行ECR歷史, ECR NO. :

| | | | | | | | |
|--|--|-----|------------------------------------|-----|---|-----|------------------------------|
| 料號: | ZPS-SS00112NG | 名稱: | 包規 For SS00,T/R,(W/O Logo),GP,小箱包裝 | 版本: | 由 | 變更為 | A |
| 發行原因 | <input checked="" type="checkbox"/> 新圖面或規範 <input type="checkbox"/> 新增料號 <input type="checkbox"/> 圖面整理 <input type="checkbox"/> 客戶要求 <input type="checkbox"/> 設計改善 <input type="checkbox"/> 制程改善 <input type="checkbox"/> 模治具制程改善 <input type="checkbox"/> 失誤 | | | | | | |
| 變更原因 詳細說明 | 新版發行 | | | | | | |
| 變更分類 | <input type="checkbox"/> A <input type="checkbox"/> B <input type="checkbox"/> C <input type="checkbox"/> D <input checked="" type="checkbox"/> E | | | | | | <input type="checkbox"/> ECF |
| 驗證資料 | | | | | | | |
| 變更區域 | 變更內容 (圖示說明) | | | | | | |
| | | | | | | | |
| 1.是否需變更"工程樣品" <input type="checkbox"/> 是,製造(助理)會簽: <input checked="" type="checkbox"/> 否 | | | | | | | |
| 2.模治具信息<研發填寫> 舊零件處理: <input type="radio"/> 保留 <input type="radio"/> 不保留 | | | | | | | |

經辦: 楊叔群

核准:

日期: 2020/4/9

日期:

簽核流程: 研發工程師→相關部門會簽→研發主管
 保存單位: 文管中心

保存年限: 永久

UD-P09-R21X



UDE Corp.

Engineering Change Notice

ECN NO. : EC20040548

| | | | |
|--------------------|--|--------|-------|
| 料號 : ZPS-SS00112NG | 名稱 : 包規 For SS00,TR,(W/O Logo),GP,小箱包裝 | 版本 : 由 | 變更為 A |
|--------------------|--|--------|-------|

4. 生產治具狀況 ? (治工具設計單位填寫 ; 內容應含 : 焊接治具 / 測試治具及其他產線成品組裝所需修改的治具)

| 設備 | 狀態 | 完成時間 | 負責部門 | 設備 | 狀態 | 完成時間 | 負責部門 |
|----|----|------|------|----|----|------|------|
| | | | | | | | |
| | | | | | | | |
| | | | | | | | |
| | | | | | | | |

5. 製樣治工具狀況 (製程研發填寫) :

| 設備名稱 | 預計完成時間 | 負責部門 | 設備名稱 | 預計完成時間 | 負責部門 |
|------|--------|------|------|--------|------|
| | | | | | |
| | | | | | |
| | | | | | |
| | | | | | |

四、會簽及會簽意見 :

| 東莞-部門 | | 東莞-部門 | | 中江-部門 | |
|--------------------------------------|--|------------------------------------|--|------------------------------------|--|
| <input type="checkbox"/> 整合/高頻研發 | | <input type="checkbox"/> 生產專案-專案技術 | | <input type="checkbox"/> 電鍍 | |
| <input type="checkbox"/> 沖壓工程 | | <input type="checkbox"/> 生產專案-生產計劃 | | <input type="checkbox"/> 電鍍品保 | |
| <input type="checkbox"/> 注塑工程 | | <input type="checkbox"/> 系統部 | | <input type="checkbox"/> 自動化生產 | |
| <input type="checkbox"/> 機械設計/設備工程 | | <input type="checkbox"/> 實驗室 | | <input type="checkbox"/> 自動化生產(品保) | |
| <input type="checkbox"/> 採購 | | <input type="checkbox"/> 物流 | | <input type="checkbox"/> AP部 | |
| <input type="checkbox"/> 製程研發-ME | | 中江-部門 | | <input type="checkbox"/> AP部(品保) | |
| <input type="checkbox"/> 製程研發-AE | | <input type="checkbox"/> 研發 | | <input type="checkbox"/> 成品組裝-製造 | |
| <input type="checkbox"/> 製程研發-IE | | <input type="checkbox"/> 沖壓設計 | | <input type="checkbox"/> 成品組裝-品保 | |
| <input type="checkbox"/> 資材生管 | | <input type="checkbox"/> 注塑設計 | | <input type="checkbox"/> QA部-VQA | |
| <input type="checkbox"/> 樣試 | | <input type="checkbox"/> 機設設計 | | <input type="checkbox"/> QA部-QC | |
| <input type="checkbox"/> 製程研發-品保(成品) | | <input type="checkbox"/> 採購 | | <input type="checkbox"/> SMT | |
| <input type="checkbox"/> 製程研發-品保(機構) | | <input type="checkbox"/> 新技研 | | <input type="checkbox"/> 生產專案-專案技術 | |
| <input type="checkbox"/> 沖壓生產 | | <input type="checkbox"/> 製程研發-ME | | <input type="checkbox"/> 生產專案-生產計劃 | |
| <input type="checkbox"/> 注塑生產 | | <input type="checkbox"/> 製程研發-TE | | <input type="checkbox"/> 資材倉庫 | |
| <input type="checkbox"/> 自動化生產 | | <input type="checkbox"/> 製程研發-IE | | <input type="checkbox"/> 半成品倉庫 | |
| <input type="checkbox"/> 自動化生產-品保 | | <input type="checkbox"/> 資材生管 | | <input type="checkbox"/> LED生產部 | |
| <input type="checkbox"/> 成品組裝-品保 | | <input type="checkbox"/> 半成品生管 | | <input type="checkbox"/> 包材生產部 | |
| <input type="checkbox"/> 成品組裝-製造 | | <input type="checkbox"/> 製樣 | | <input type="checkbox"/> 系統部 | |
| <input type="checkbox"/> QA部-VQA | | <input type="checkbox"/> 注塑品保 | | <input type="checkbox"/> 實驗室 | |
| <input type="checkbox"/> QA部-QC | | <input type="checkbox"/> 注塑生產 | | <input type="checkbox"/> 物流 | |
| <input type="checkbox"/> SMT | | <input type="checkbox"/> 沖壓品保 | | <input type="checkbox"/> 預焊生產 | |
| <input type="checkbox"/> 資材倉庫 | | <input type="checkbox"/> 沖壓生產 | | <input type="checkbox"/> 預焊品保 | |

1-1. 成品置於COMPONENTS區，如圖所示。
 PLACE FINISH GOODS ON COMPONENTS AREA, REFER TO BELOW DRAWING.
 1-2. SFF開口朝右，並注意成品擺放方向之一致性。
 SFF OPENING TO THE RIGHT, AND PAY ATTENTION TO THE CONSISTENCY OF PRODUCT PLACEMENT DIRECTION.

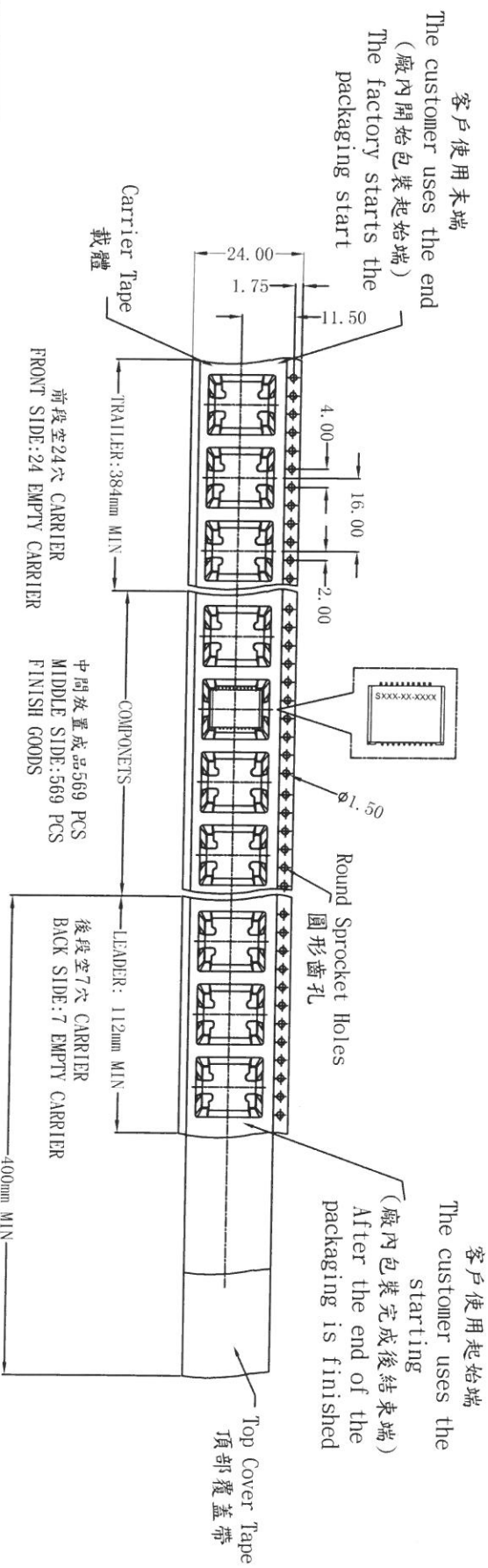

2-1. CARRIER & TAPE(熱壓合) CARRIER末端(END)以膠帶固定於HUB的開口端(半徑較小的那一端), COVER朝向REEL的外側
 CARRIER & TAPE(HOT PRESSED) CARRIER END WITH GLUE WITH AN OPEN END FIXED TO THE HUB (AT THE SMALLER END) COVER TO THE OUTSIDE OF THE REEL.
 2-2. 標籤紙與齒孔在卷盤同一側且收料方向如圖一所示。 LABEL PAPER AND ELLIPTICAL HOLES ARE ON THE SAME SIDE OF THE COIL AND THE DIRECTION OF MATERIAL COLLECTION IS SHOWN IN FIGURE 1.
 2-3. CARRIER不足一捲長度時(見包裝明細表)不可重疊接合使用。 CARRIER LESS THAN A REEL IN LENGTH (SEE PACKING LIST) NON OVERLAPPING JOINT USE.

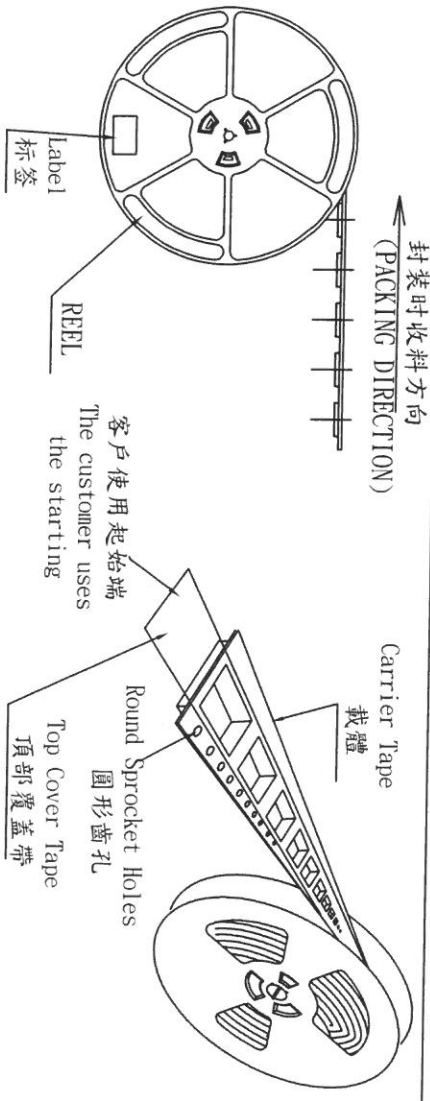

UDE Corp.

包裝規範

For

SS00, T/R, (W/O Logo), GP, 小箱包裝

PRODUCT DRAWING

| | | | | | | | | |
|-----------------------------|--------------------|--------------------------------|----------|----------------------|---------|-----------------------|-------|-----|
| APPROVE | CHECK | REV | DATE | DRAW | APPROVE | SCALE | SHEET | REV |
| <i>[Signature]</i> | <i>[Signature]</i> | A | 9-Apr-20 | Lee | Jackson | 1/3 | 1/3 | A |
| ①: Inspection Item / Qty: / | | ②: Critical Dimension / Qty: / | | ③: GENERAL TOLERANCE | | DWG NO. ZPS-SS00112NG | | |
| ECN NUMBER | | DATE | | DRAW | | SCALE | | |
| EC20040548 | | 9-Apr-20 | | Lee | | 1/3 | | |

產品封裝後示意圖

These drawings and specifications are confidential and disclosed to you on condition that no further disclosure is made by you to other than UDE personnel without written authorization from U.D. Electronic Corp..

2-4. COVER TAPE 不可重疊搭接使用，用美紋膠帶將COVER TAPE末端中心位置貼合（上下左右居中位置貼合即可）。

美紋膠帶說明：長度為 $160\pm 20\text{mm}$ ，寬度為 20mm ，必須貼緊COVER TAPE且不可回收使用。（如圖二所示）

NO OVERLAP OF THE COVER TAPE, MASKING TAPE SHALL BE USED TO FIX THE EDN OF THE COVER TAPE (AT THE MIDDLE AREA OF EACH DIRECTION). THE MASKING TAPE REQUIREMENT: LENGTH $160\pm 20\text{MM}$, WIDTH 20MM , IT MUST STICK TIGHTLY ON THE COVER TAPE AND UNRECYCLABLE TO USE. (FIGURE 2)

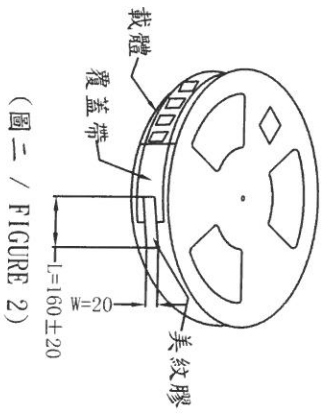

(圖二 / FIGURE 2)

- 3-1. 先置入 1 PCS紙漿板於內箱底部。
INSERT ONE CARDBOARD ON INNER BOX BOTTOM.
- 3-2. 將REEL及乾燥劑平置於防水袋內，將防水袋整齊折合後，以膠帶將其固定好再置於內盒中。（REEL數量參見包裝容量表）
HAVE REEL & SILICA GEL PLACED INSIDE P.E. BAG, THEN, PROPERLY FOLDS THE P.E. BAG, AND FIX W/ TAPE.
PLACED IN INNER BOX (REEL QUANTITY REFER TO PAGE 3)
- 3-3. 將角板放入內箱內四個角落。
PLACE CORNER BOARD IN INNER'S BOX 4 CORNER.
- 3-4. 再置入 1 PCS紙漿板於REEL頂部。
PLACE EXTRA CARDBOARD ON REEL TOP.
- 3-5. 以膠帶封合，並貼上成品包裝標籤，標示料號及數量，包裝日期。
CLOSED WITH TAPE AND HAVE LABEL ON OUTSIDE OF BOX, PART NUMBER, QUANTITY, AND PACKING DATE NEEDS TO BE MARKED.
4. 其它相關事項，請參閱ISD-ISPZNPK6和標貼規範。
PLEASE REFER TO ISD-ISPZNPK6 AND LABEL STANDARD FOR OTHER RELATED ITEMS.

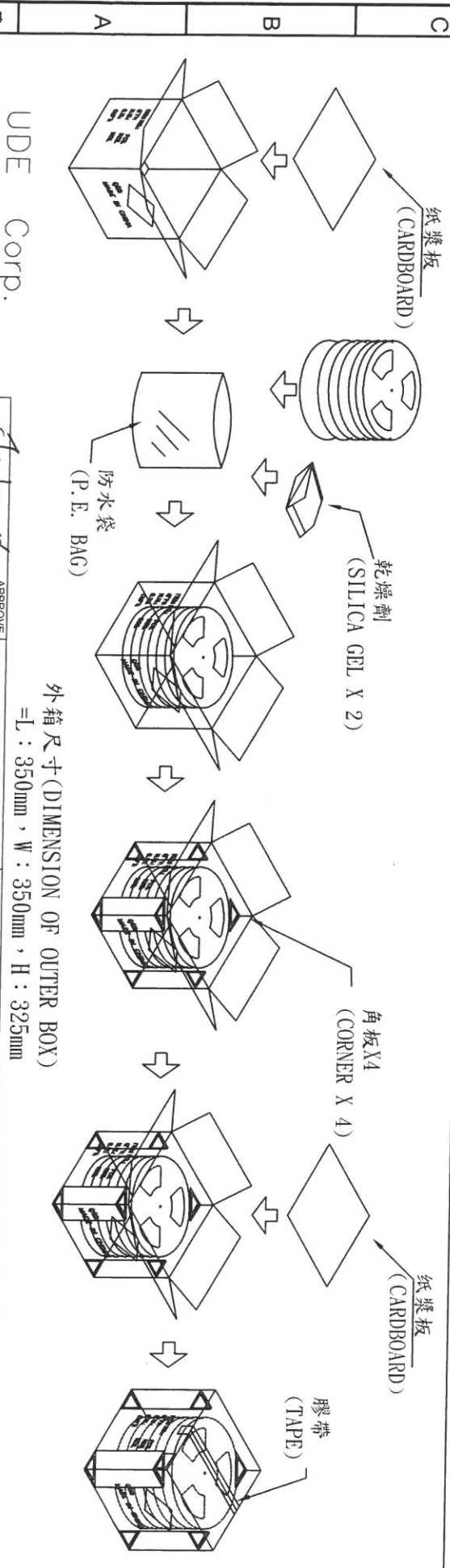

UDE Corp.

包裝規範

For SS00, TR, (W/O Logo), GP, 小箱包裝

PRODUCT DRAWING

| | | | | | | |
|---------------|----------|-------|-----------|-------------------|---------|---------------|
| APPROVE | DATE | UNITS | HSF | GENERAL TOLERANCE | | DWG. NO. |
| <i>Jackie</i> | 2020/4/9 | mm | compliant | .X± / | .X± / | ZPS-SS00112NG |
| CHECK | DATE | mm | APPROVE | .XX± / | .XX± / | SCALE |
| 楊叔群 | 9-Apr-20 | mm | Lea | .XXX± / | .XXX± / | 2 / 3 |
| ECN NUMBER | DATE | mm | APPROVE | | | SHEET |
| EC20040548 | 9-Apr-20 | mm | Jackson | | | REV |
| ECN NUMBER | DATE | mm | APPROVE | | | A |
| EC20040548 | 9-Apr-20 | mm | Jackson | | | |

外箱尺寸(DIMENSION OF OUTER BOX)
=L: 350mm, W: 350mm, H: 325mm

These drawings and specifications are confidential and disclosed to you on condition that no further disclosure is made by you to other than UDE personnel without written authorization from U.D. Electronic Corp..

