

Crimpversion / Crimp version 1.0-2.5mm<sup>2</sup>

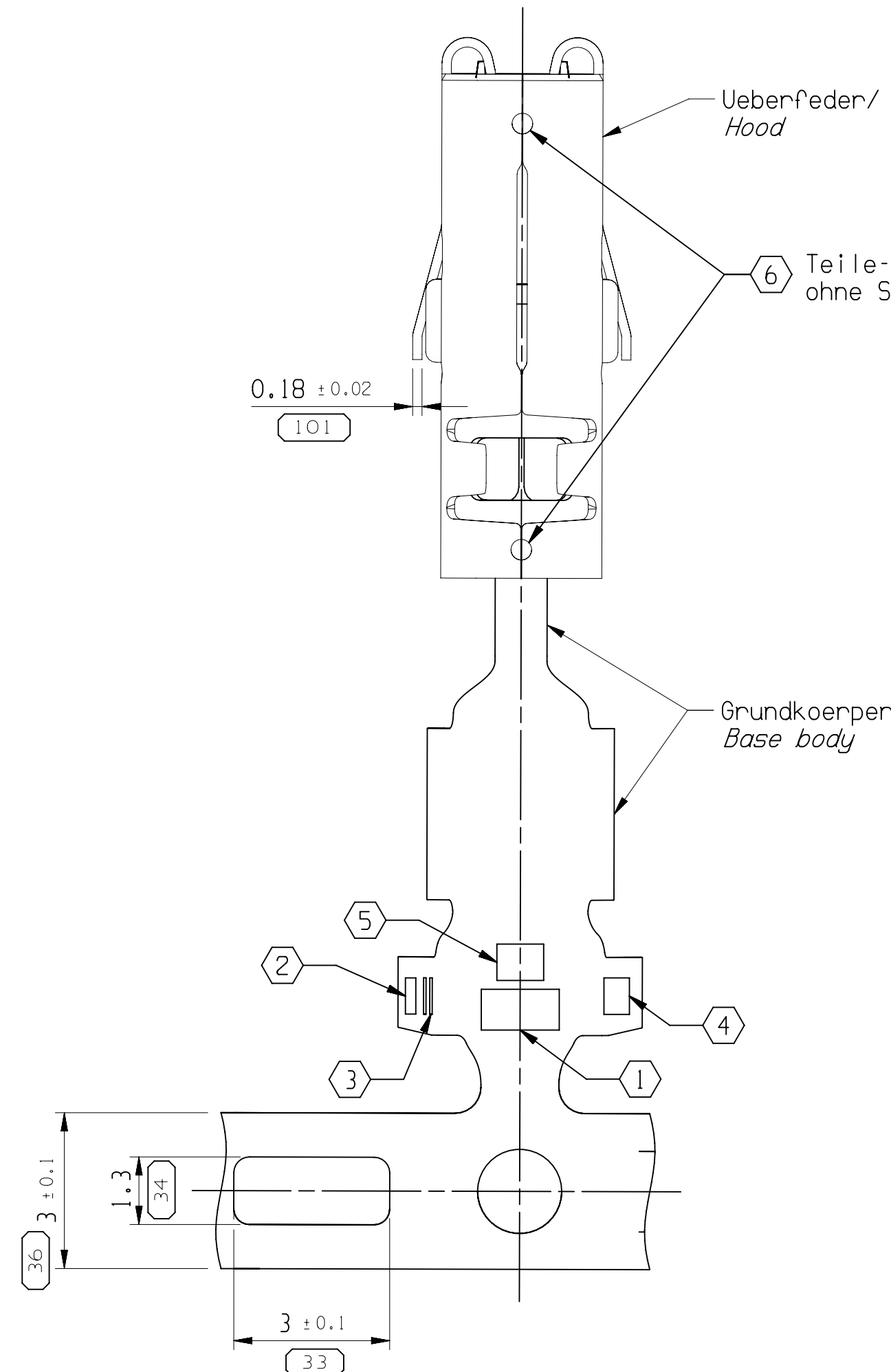

Bemerkungen / Notes	
1	Firmenzeichen / Company code
2	Änderungsindex / Revision index
3	Part code
4	Woche und Jahr der Herstellung / Week and year of production
5	Oberflächen Code / Plating code
6	Laserschweißpunkte, ausgenommen Teile-Nr. / Laser welding points, except Part no. - 35041242 / 35041232 / 35041241
7	Loch: Kennzeichnung fuer Goldversion / Hole: Sign for gold version
8	Oberflächenveredelung der Kontaktstellen nach Teilenummer - Zinn (Sn), Silber (Ag), Gold (Au) / Contact point surface finishes by part number - Tin (Sn), Silver (Ag), Gold (Au)
<b>Material</b>	
9	Grundkörper / Base Body - CuNi3511Mg
10	Ueberfeder / Hood - X10CrNi18-8
<b>Querverweise / Cross references</b>	
11	Standard Flachstecker / Standard tab - 2.8±0.1 x 0.8±0.03 / 2.8±0.1 x 0.6±0.07
12	Zugehörige Kammer / Associated cavity - 9 001 16 00
13	Crimpspezifikation / Crimpspecification - 13609586-CU504 (9 084 13 00)
14	Produktspezifikation / Product specification - 13609586-CU574 (9 901 04 80)
15	Teilenummer vor Konvertierung / Part number before conversion - (X XXX XX XX)
16	Durchgestrichene Teilenummer nur auf Anfrage / Crossed out part no. only on request
17	Masgebend ist nur der Deutsche Text / Only the German language shall be binding

DWG. STATUS	DATE	STG	REV	IN	PL	CHG	ZONE	REVISION HISTORY		AUTH	DR	APVD 1	APVD 2
08SE17	R	02	AA	-	-	-	-	REWORK OF THE SPRING ADDED VIEW FOR (2,3-4,5mm DELPHI PART NO. BRACKETED)		S.Weiss	p.Nue	M.Por	
20SE22	R	02	AB	-	-	-	-	3x NEW PART NO. FOR 5x VERSIONS ADDED. AG VERSIONS CROSSED OUT / NOTE IS ADDED. NOTE IS CHANGED		S.Weiss	A.A11	M.Por	
21AP23	R	02	AC	-	-	-	-	REDRAWN IN A4		V.WAK	C.ZOL	M.POR	

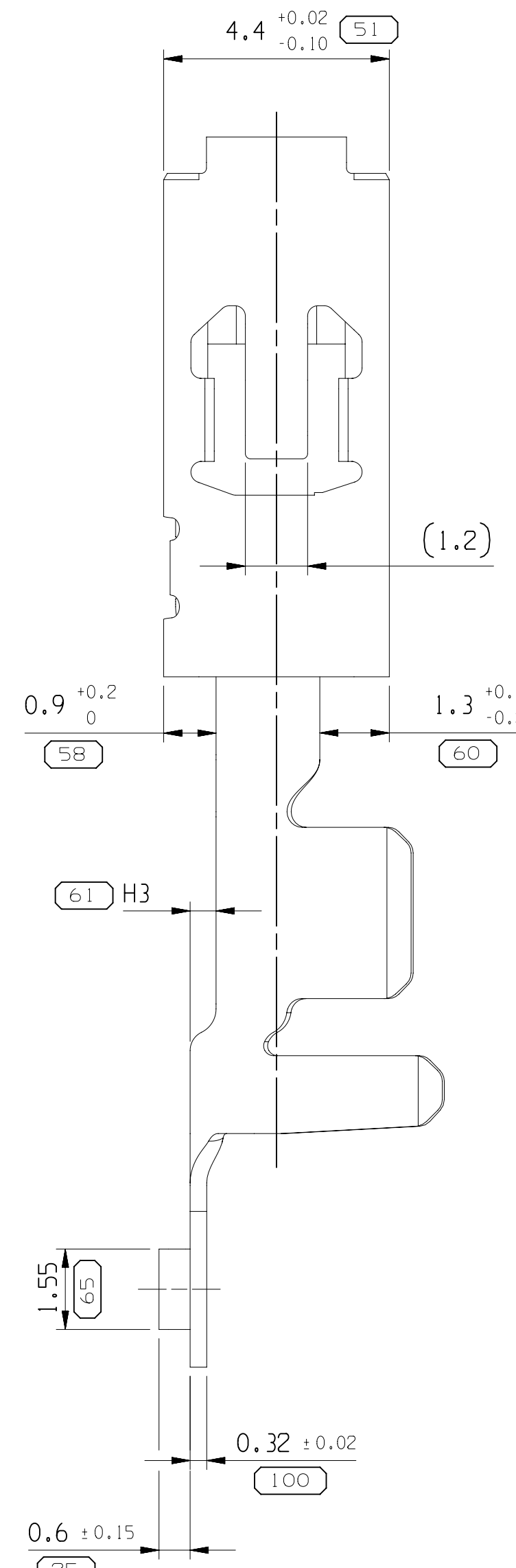
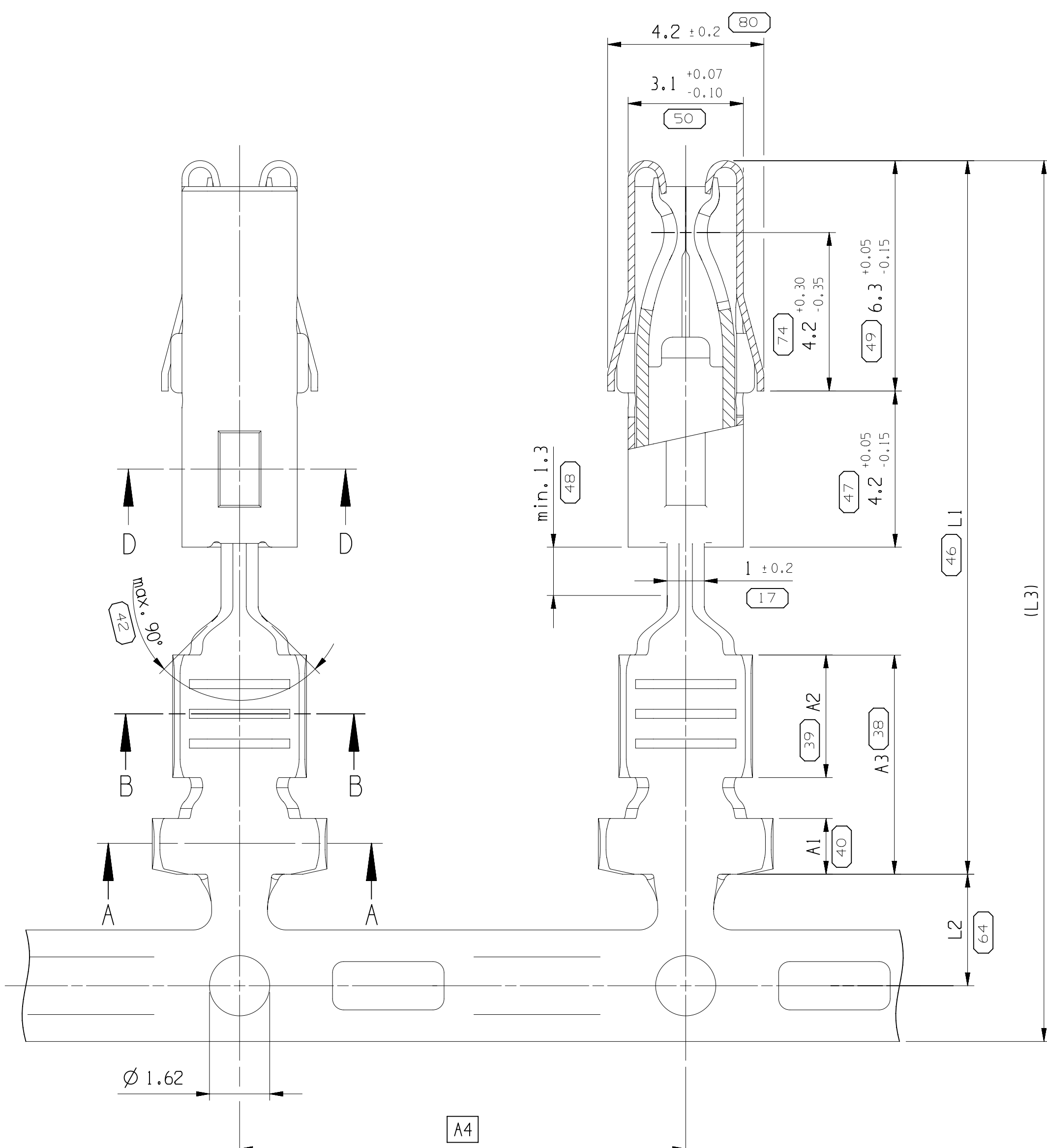
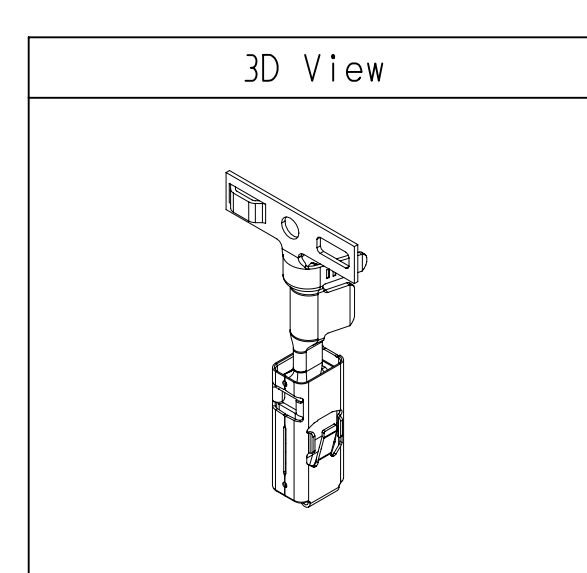
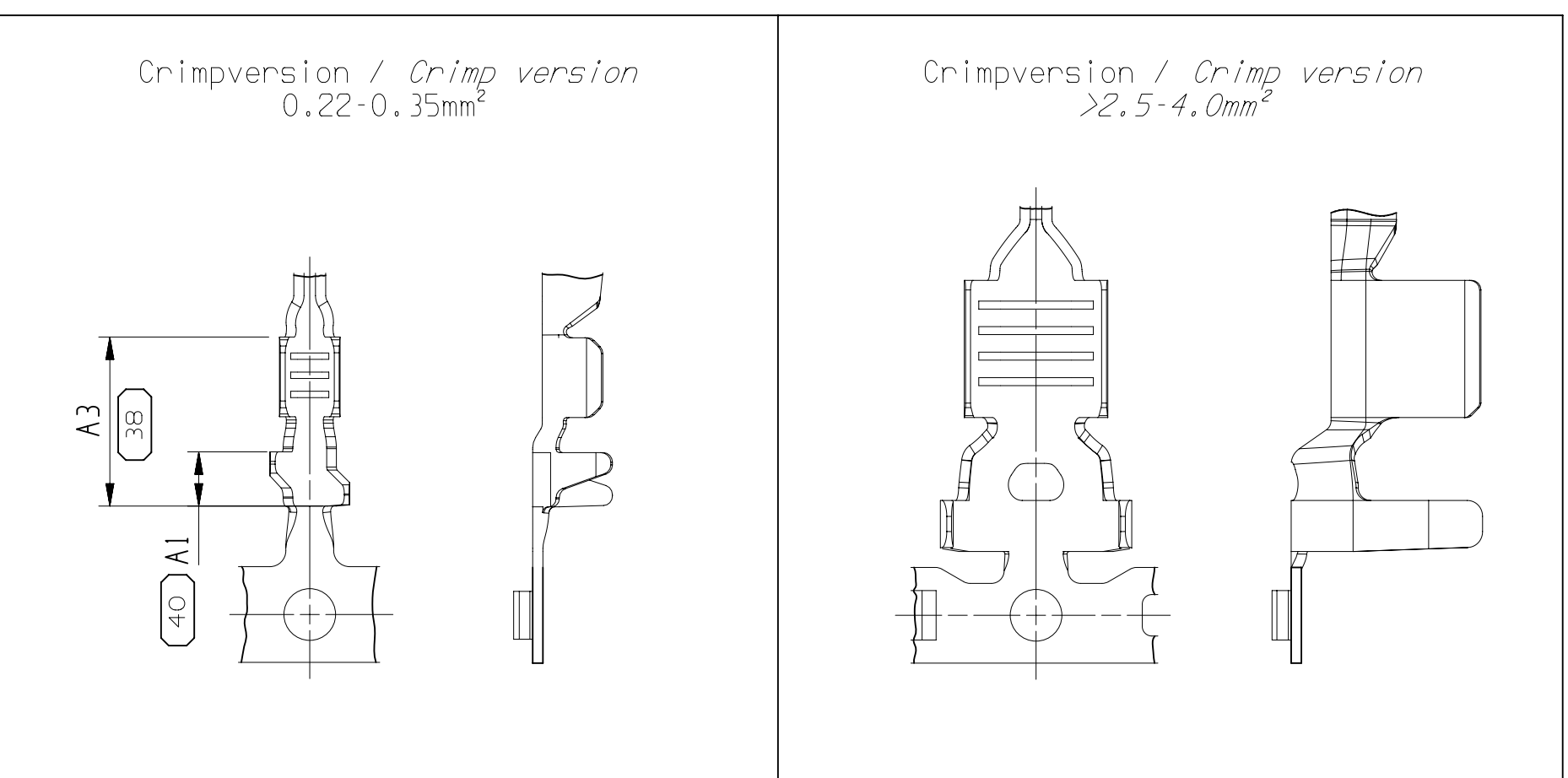
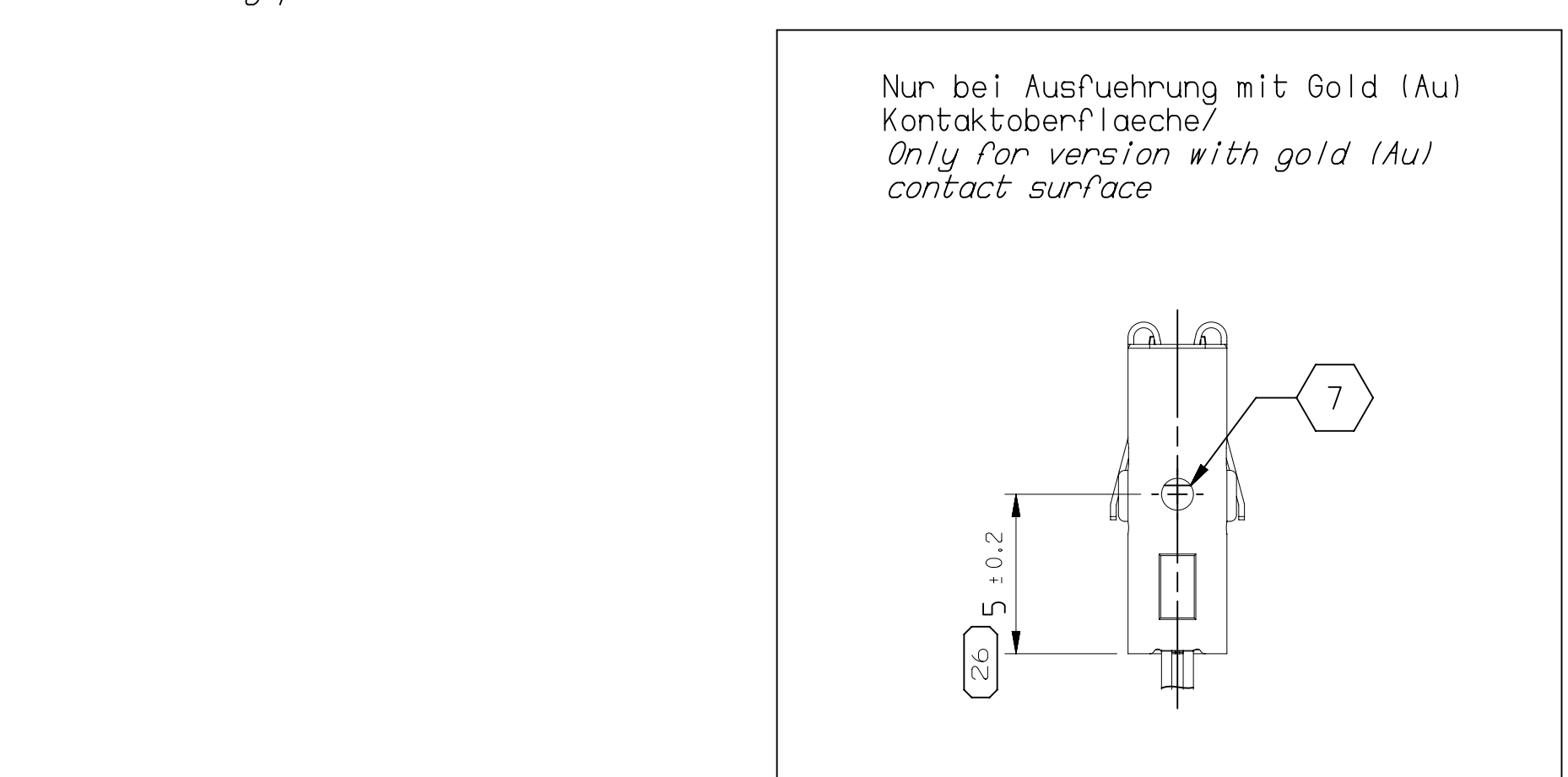

TEILE N <sup>o</sup> . / PART No.	REV.	CRIMPBEREICH / CRIMP RANGE (mm <sup>2</sup> )	PLATING	OBERFLAECHE / SURFACE FINISH	B1	D1	H1	B2	D2	H2	A1	A2	A3	A4	L1	L2	(L3)	H3	L6		
33522728	-	>2.5-4.0	III	Ag	3-5µm	Ag	4.5	2.3	4.7	6.0	4.3	6.0	1.6	4.3	8.5	14.5	22.6	2.0	26.1	1.25±0.2	13.45±0.8
13780621	-	>2.5-4.0	III	Sn	1-3µm	Sn	4.5	2.3	4.7	6.0	4.3	6.0	1.6	4.3	8.5	14.5	22.6	2.0	26.1	1.25±0.2	13.45±0.8
13609245	B	1.5-2.5	III	Au	0.8µm	Au	3.6	1.8	3.8	4.7	2.6	4.9	1.5	3.3	5.9	12.0	19.2	3.0	23.7	0.5±0.2	9.1±0.5
33514302	A	1.5-2.5	III	Ag	3-5µm	Ag	3.6	1.8	3.8	4.7	2.6	4.9	1.5	3.3	5.9	12.0	19.2	3.0	23.7	0.5±0.2	9.1±0.5
35041241	-	1.5-2.5	III	Sn	1-3µm	Sn	3.6	1.8	3.8	4.7	2.6	4.9	1.5	3.3	5.9	12.0	19.2	3.0	23.7	0.5±0.2	9.1±0.5
13609247	B	0.5-1.0	II	Au	0.8µm	Au	2.5	1.2	2.7	3.7	1.8	3.9	1.5	3.0	5.5	12.0	19.2	3.0	23.7	0.3±0.2	9.1±0.5
33514300	A	0.5-1.0	II	Ag	3-5µm	Ag	2.5	1.2	2.7	3.7	1.8	3.9	1.5	3.0	5.5	12.0	19.2	3.0	23.7	0.3±0.2	9.1±0.5
35041232	-	0.5-1.0	II	Sn	1-3µm	Sn	2.5	1.2	2.7	3.7	1.8	3.9	1.5	3.0	5.5	12.0	19.2	3.0	23.7	0.3±0.2	9.1±0.5
13609246	B	0.22-0.35	I	Au	0.8µm	Au	1.9	0.8	1.9	2.5	1.0	2.5	1.7	2.5	5.3	12.0	18.8	3.4	23.7	0.2 <sup>+0.2</sup> <sub>-0.0</sub>	8.7±0.5
33514298	A	0.22-0.35	I	Ag	3-5µm	Ag	1.9	0.8	1.9	2.5	1.0	2.5	1.7	2.5	5.3	12.0	18.8	3.4	23.7	0.2 <sup>+0.2</sup> <sub>-0.0</sub>	8.7±0.5
35041242	-	0.22-0.35	I	Sn	1-3µm	Sn	1.9	0.8	1.9	2.5	1.0	2.5	1.7	2.5	5.3	12.0	18.8	3.4	23.7	0.2 <sup>+0.2</sup> <sub>-0.0</sub>	8.7±0.5

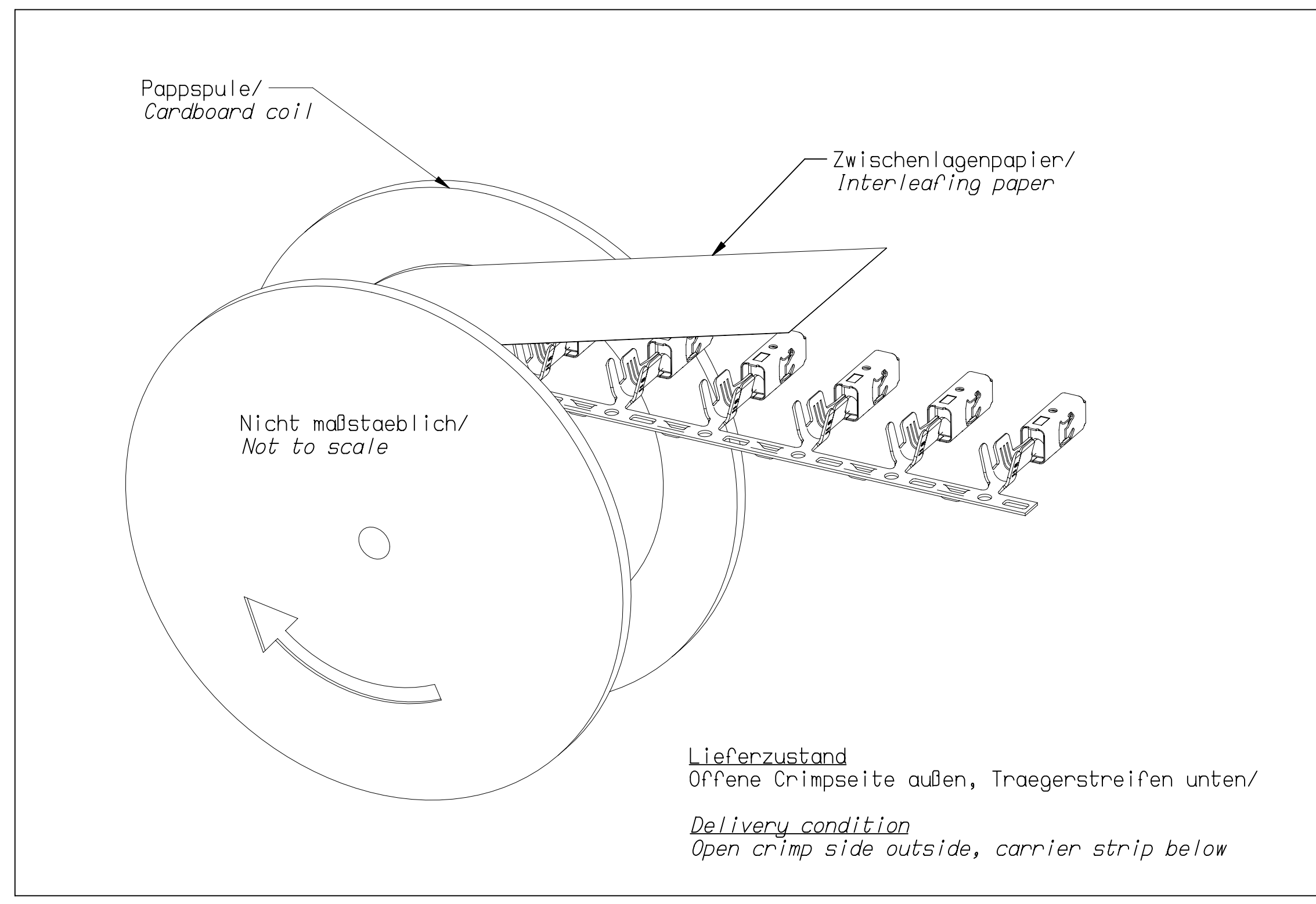
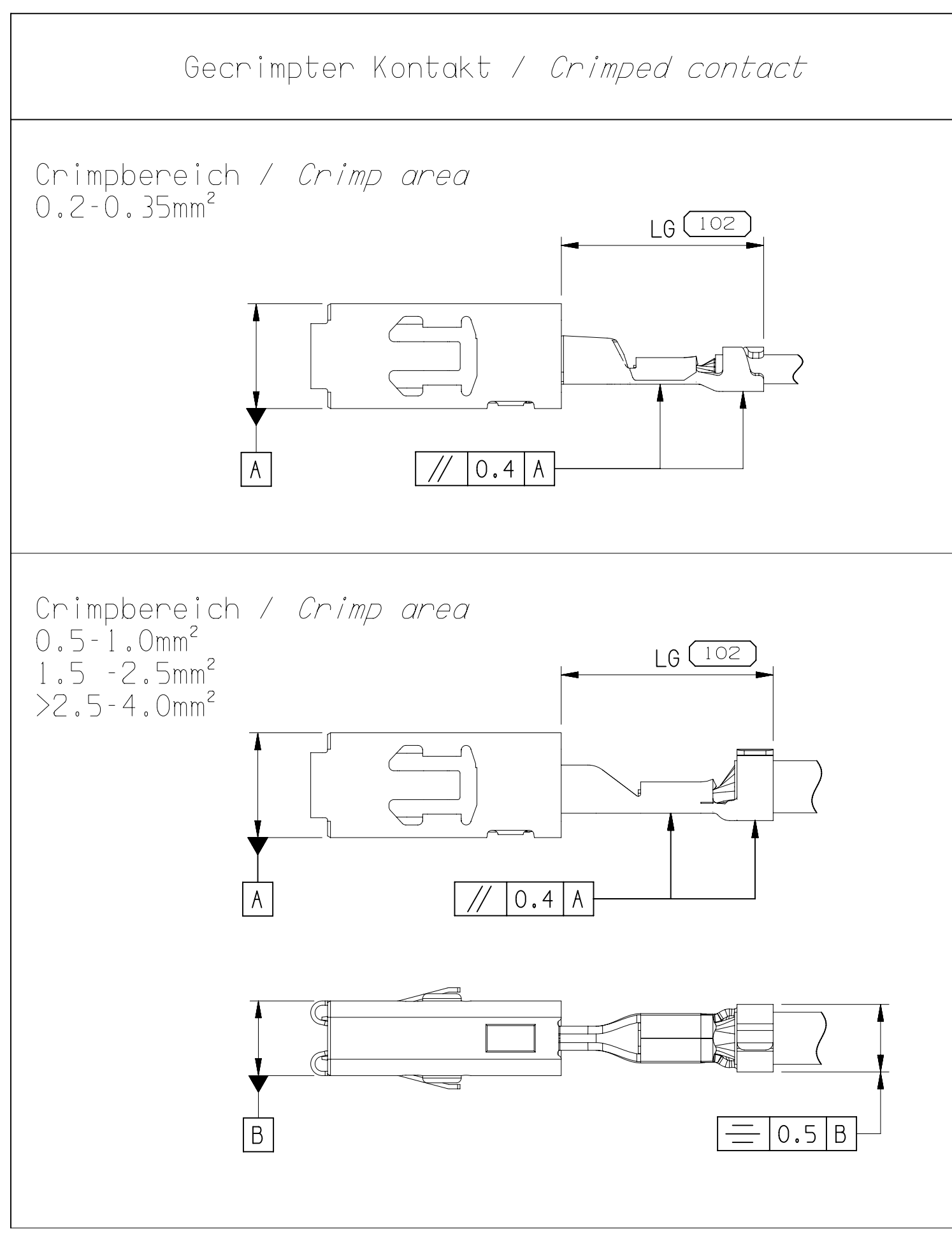

CUSTOMER PART DRAWING	
REF. (10)	SYSTEM CODE
VOLUME (10)	
PROJ.	
UNLESS OTHERWISE SPECIFIED	
GENERAL TOLERANCES ACCORDING TO: DIN ISO 2768-mH	
GD&T ACCORDING TO: DIN ISO 1101	
REFERENCE: 60070451c	
FIRST ANGLE PROJECTION	
DO NOT SCALE USE MATH DATA	

**•APTIV•**  
CONNECTION SYSTEMS  
Chennai, India  
COPYRIGHT 2002 APTIV. ALL RIGHTS RESERVED.  
THIS DRAWING IS THE PROPERTY OF APTIV AND CONTAINS APTIV CONFIDENTIAL INFORMATION. THE REPRODUCTION, DISTRIBUTION AND UTILIZATION OF THIS DOCUMENT OR ITS RELATED CAD DATA, AS WELL AS COMMUNICATION OF ANY CONTENT TO OTHERS, WITHOUT EXPRESS AUTHORIZATION, IS PROHIBITED.  
DESE ZEICHNUNG IST EIGENTUM DER FIRMA APTIV UND ENTHAELT APTIV VERTRAULICHE INFORMATIONEN. DIE REPRODUKTION, VERTEILUNG UND NUTZUNG DIESER DOKUMENTE ODER DIESER ZUGEHÖRIGEN CAD DATEN, ODER AUCH ALS KOMMUNIKATION VON BEZÜGELIEM INHALT ZU ANDEREN, IST OHNE BEZUGELIGENGERÄTUNG DURCH DIE APTIV UNZULASSIG.  
DATE: 03.JUL.02  
DR: S.Weiss  
APVD1: G.MAY  
APVD2: St.Mueller  
APVD3:  
APVD4:  
APVD5:  
SUBSTANCES OF CONCERN AND RECYCLED CONTENT PER APTIV 10400001  
POTENTIELL BEFAEHLICHE STOFFE UND REZUKLANTANTEIL  
GEMÄSS APTIV 10400001  
MATERIAL  
SEE NOTES  
DRAWING NAME: DCK-2.8 FEMALE CONTACT NON WATERPROOF APPLICATION  
CUS01  
DRAWING NUMBER: 13609586  
SIZE: A0  
SCALE: 10:1  
FRAME NO: 1  
SHEET NO: 1 OF 1  
REV: R  
DWG: 02 AC

# Mouser Electronics

Authorized Distributor

Click to View Pricing, Inventory, Delivery & Lifecycle Information:

[Aptiv:](#)

[35041242](#)